

Metal Location Poster is on a $\frac{1}{2}$ aspen tree 3 inches diameter, on the N. W. side of Tree from which this Corner bears $N48^{\circ}W$ 0.43 chains distant. Give any further facts which will aid in finding this Corner again.

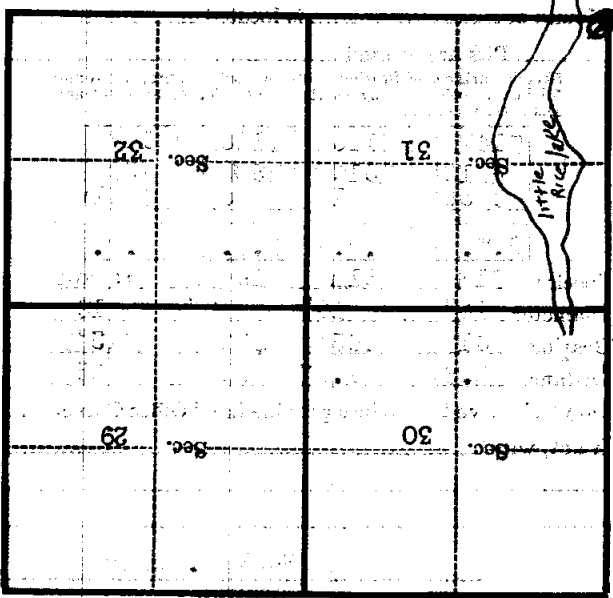

(Make sketch of topography near Corner)

T. 147 N. R. 30 W. 5th P. Mer.

U. S. Department of Agriculture
FOREST SERVICE

Handwritten mark: A large 'X' with the number '1' next to it.

Chippewa NATIONAL FOREST

CORNERS OF THE PUBLIC SURVEY

T. 147 N R. 30 W 5th P. Mer.

Section Corner common to Sections
31, and 36 T147N R31W

Corner consists of a Cement Mon. ~~(stone)~~ in place

State condition Good

Dimensions above ground 6 inches

Sketch grooves, letters, figures, or notches, on proper face or edge.

CARDINAL POSITION

DIAGONAL POSITION

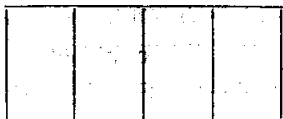

N W S E

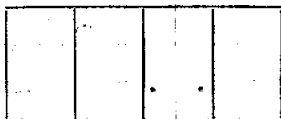

NW SW SE NE

Mound of _____ is located _____

Pits are located _____

Sketch markings of Bearing Trees (or Rocks) in proper box and fill blanks below, giving bearings from Corner to Trees and Distances in Links.

T147N R31W S 36	T146N R31W S 1	T146N R30W S 6	T147N R30W S 31
B.T.	B.T.	B.T.	B.T.

Species Elm Elm Aspen Aspen

Diameter 14" 14" 12" 10"

Bearing N61°W S65°W S74°E N46°E

Distance 2.67 4.67 61 85

Do you believe this to be a genuine Land Office Corner? Yes

If not, why? _____

Hugh M. Hoard

(Signature)

Compass Man

(Title)

2/20/40

(Date)

SECTION 30

SECTION 31

SECTION 32

COMMENTS ON THE PUBLIC SURVEY

Corner again.

Give any further facts which will aid in finding this

chains distant

from which this Corner bears

side of tree

3 inches diameter, on the

Metal Location Poster is on a

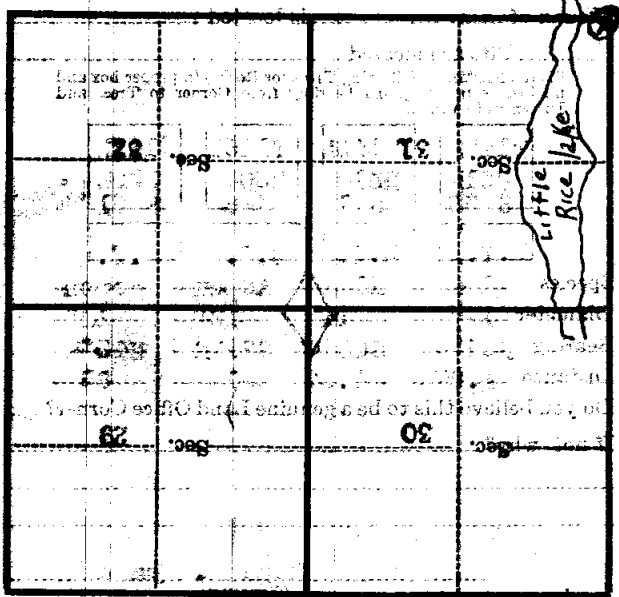

(Make sketch of topography near Corner)

U. S. Department of Agriculture

FOREST SERVICE

Chippewa NATIONAL FOREST

CORNERS OF THE PUBLIC SURVEY

T. 147 N R. 30 W 5th P. Mer.

Section A Corner common to Sections

31, and 36 T147N R31W

Corner consists of a Cement Mon. (set) in place

State condition Good

Dimensions above ground 6 inches

Sketch grooves, letters, figures, or notches, on proper face or edge.

CARDINAL POSITION

DIAGONAL POSITION

--	--	--	--

N W S E

--	--	--	--

NW SW SE NE

Mound of is located

Pits are located

Sketch markings of Bearing Trees (or Rocks) in proper box and fill blanks below, giving bearings from Corner to Trees and Distances in Links.

T147N
R31W
S 38T146N
R31W
S 1T146N
R30W
S 6T147N
R30W
S 31

B.T.

B.T.

B.T.

B.T.

Species Elm Elm Aspen Aspen

Diameter 14" 14" 12" 13"

Bearing N61°W S85°W S74°E N45°E

Distance 2.48 4.67 61 83

Do you believe this to be a genuine Land Office Corner? yes

If not, why?

Hugh M. Hoard

(Signature)

Cement Mon

(Title)

2/20/40

(Date)