

U. S. Department of Agriculture
FOREST SERVICE

Chippewa NATIONAL FOREST

CORNERS OF THE PUBLIC SURVEY

T. ¹⁴⁸147 N. R. 29 W. 5 Mer.

Section Corner common to Sections

1, 2, 35, and 36

Corner consists of a *Wooden Post* (not) in place

State condition *Good*

Dimensions above ground *2 ft.* inches

Sketch grooves, letters, figures, or notches, on proper face or edge.

CARDINAL POSITION

DIAGONAL POSITION

S	S	S	S
35	2	1	3
N	W	S	E

NW	SW	SE	NE

Mound of _____ is located _____

Pits are located _____

Sketch markings of Bearing Trees (or Rocks) in proper box and fill blanks below, giving bearings from Corner to Trees and Distances in Links.

<i>12 6M</i> <i>✓</i>			

Species *Black Spruce*

Diameter *4 inches*

Bearing *N 36° E*

Distance *16 links*

Do you believe this to be a genuine Land Office Corner? *yes*

If not, why? _____

L. B. Hutchinson
(Signature)

Feb. 25, 1935
(Date)

Estimator
(Title)

Corner again.

Give any further facts which will aid in finding this

11 links, chains distant.

from which this corner bears $580^{\circ}E$

side of *Spence*

tree 5 inches diameter, on the *East*

Metal Location Poster is on a *Black Spence*

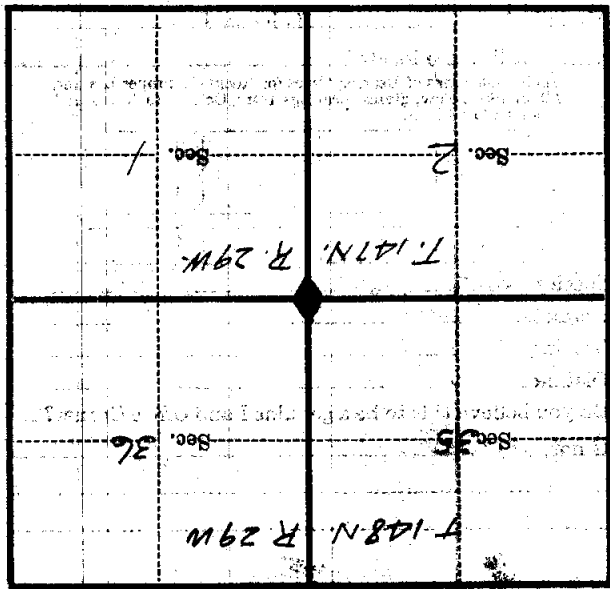

(Make sketch of topography near corner)