

R-21

U. S. Department of Agriculture
FOREST SERVICE

Chippewa NATIONAL FOREST

CORNERS OF THE PUBLIC SURVEY

T. 147th R. 29W 5th Mer.

Section Corner common to Sections

23, 24, 25, and 26

Corner consists of a Iron pipe with (not) in place

State condition brass cap

Dimensions above ground 2" - 12" inches

Sketch grooves, letters, figures, or notches, on proper face or edge.

CARDINAL POSITION

DIAGONAL POSITION

--	--	--	--

N W S E

--	--	--	--

NW SW SE NE

Mound of _____ is located _____

Pits are located _____

Sketch markings of Bearing Trees (or Rocks) in proper box and fill blanks below, giving bearings from Corner to Trees and Distances in Links.

T147N R29W S26

T147 R29W S25

T147N R29W S24

T147N R29W S23

BT

BT

BT

BT

Species aspen Aspen pruce W. pine

Diameter 10 12 10c 24

Bearing S40W S16E N65E N1W

Distance .31 .36 1.16 3.80

Do you believe this to be a genuine Land Office Corner Yes

If not, why? _____

Walter Haberle

(Signature)

8/22/40

(Date)

Proj. Asst.

(Title)

R-2189

UNITED STATES OF AMERICA

CONTINENTAL SHEET NO. 1000

SECTION 26

T. 142N. R. 29W.

Section 26

Corner again

Give any further facts which will aid in finding this

Section - chains distant

from which this Corner bears

side of corner

tree 14 inches diameter, on the west

Metal Location Poster is on a

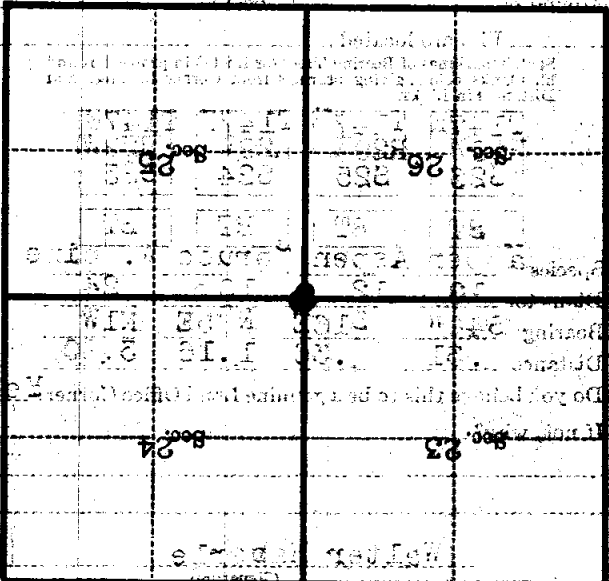

Scale of 1 inch = 1 mile