

U. S. Department of Agriculture

FOREST SERVICE

219

Chippewa NATIONAL FOREST

CORNERS OF THE PUBLIC SURVEY

T. 147 N. R. 29 W. 5th. P. Mer.

Quarter Corner common to Sections

35, and 2 T. 146 N. R. 29 W.

Corner consists of a Br. Cap Iron Pipe (see) in place

State condition Good

Dimensions above ground 6 inches

Sketch grooves, letters, figures, or notches, on proper face or edge.

CARDINAL POSITION

DIAGONAL POSITION

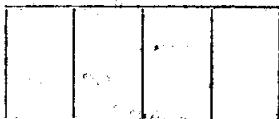

N W S E

NW SW SE NE

Mound of is located

Pits are located

Sketch markings of Bearing Trees (or Rocks) in proper box and fill blanks below, giving bearings from Corner to Trees and Distances in Links.

Glo. B. ts.			
$\frac{1}{4}$	$\frac{1}{4}$		
S 2	S 35		

B. T.	B. T.		
-------	-------	--	--

Species N. Pine N. Pine

Diameter 12" 6"

Bearing S. 55° W. N. 25° E.

Distance 39 20

Do you believe this to be a genuine Land Office Corner? Yes

If not, why?

H. Hoard (Signature)

1/15/40

Compass Man (Title)

7-19

Metal Location Poster is on a N. Pine tree 50 inches diameter, on the N.W. side of **Trees** from which this Corner bears **N. 39° W. 0.09** chains distant. Give any further facts which will aid in finding this Corner again.

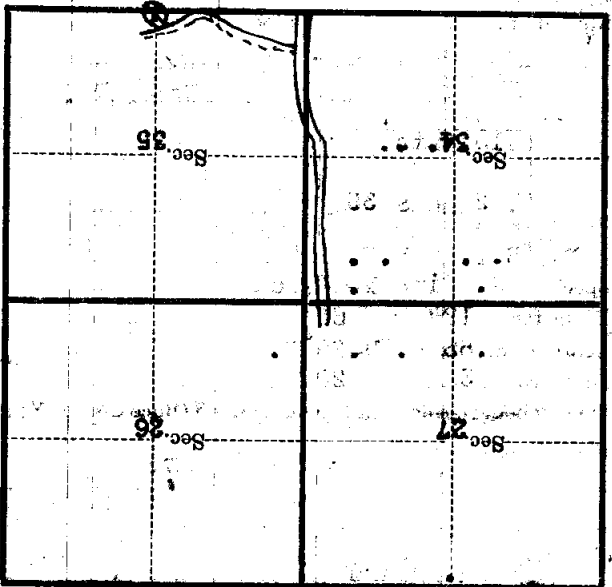

(Make sketch of topography near Corner)