

U. S. DEPARTMENT OF AGRICULTURE
FOREST SERVICE

Posted
M

Chippewa NATIONAL FOREST

CORNERS OF THE PUBLIC SURVEY

T. 147 N. R. 29+30 5TH Mer.

Section Corner common to Sections

13, 18, 19, and 24

Corner consists of an oak Stake (---) in place
State condition Good

Dimensions above ground 28 inches.

Sketch grooves, letters, figures, or notches, on proper face or edge.

CARDINAL POSITION

DIAGONAL POSITION

--	--	--	--

	T. 147 R. 30 S. 13	T. 147 R. 29 S. 19	
--	--------------------------	--------------------------	--

N W S E

NW SW SE NE

Mount of one rock is located at N. base of stake

Pits are located

Sketch markings of Bearing Trees (or Rocks) in proper box and fill blanks below, giving bearings from Corner to Trees and Distances in Links.

T. 147 R. 29 S. 18

T. 147 R. 30 S. 24

--

--

B.T.

B.T.

--

--

Species Aspen Aspen

Diameter 12" 10"

Bearing S 70° E S 72° W

Distance 15 Links 44 Links

Do you believe this to be a genuine Land Office Corner? Yes
~~Is it why?~~ Broken jug at E. base of oak stake.

James Sabau

Signature.

Nov. 17, 1932
Date.

Forest Ranger

Title. N-7 3027

T. 145 N., R. 29 + 30, 5TH Mer. N-1

9-3027 (Make sketch of topography near corner.)

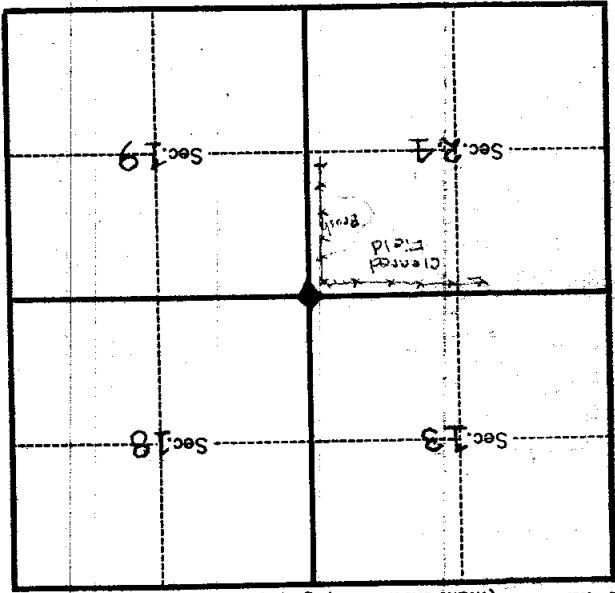

Metal Location Poster is on an Aspen

tree 12 inches diameter, on the N.W.

side of

from which this Corner bears N. 70° W.

15 chains distant.

Give any further facts which will aid in finding this

Corner again.

Approx. 1/4 Mile E. of Honey
Ester's Place.

U. S. Department of Agriculture
FOREST SERVICE

N-1

Chippewa NATIONAL FOREST

CORNERS OF THE PUBLIC SURVEY

T. 147 N R. 29 & 30 5th Mer.

Section Corner common to Sections
13, 18, 19, and 24

Corner consists of a Oak Stake (not) in place
State condition Good

Dimensions above ground 28 inches

Sketch grooves, letters, figures, or notches, on proper face or edge.

CARDINAL POSITION

DIAGONAL POSITION

N	W	S	E

	T 147 R 30 S 13	T 147 R 29 S 24	
NW	SW	SE	NE

Mound of ONE TRACK is located at N base
OF STAKE

Pits are located

Sketch markings of Bearing Trees (or Rocks) in proper box and
fill blanks below, giving bearings from Corner to Trees and
Distances in Links.

T 147 R-29 S 18

T 147 R 30 S 24 <u>BURNED</u>
--

--

--

B.T.

B.T.

--

--

Species Aspen Aspen STUB

Diameter 12" 10"

Bearing S 70° E S 73° W

Distance 15 links 44 lks

Do you believe this to be a genuine Land Office Corner? Yes

If ~~not~~ why? Broken jug at E. base
of Oak Stake

James Salomon

(Signature)

Forest Ranger

(Title)

11/17/32

(Date)

UNITED STATES GEOLOGICAL SURVEY

WATER RESOURCES DIVISION

FIELD NOTES

TOPOGRAPHIC SURVEY

1934

Corner station to position

Approx. 1/4 Mile E of Harvey
Foster's Place

Corner again

Give any further facts which will aid in finding this

chain distant.

15

from which this Corner bears

N 90° W

side of

tree 12 inches diameter, on the N.W.

Metal Location Poster is on a

ASPEN

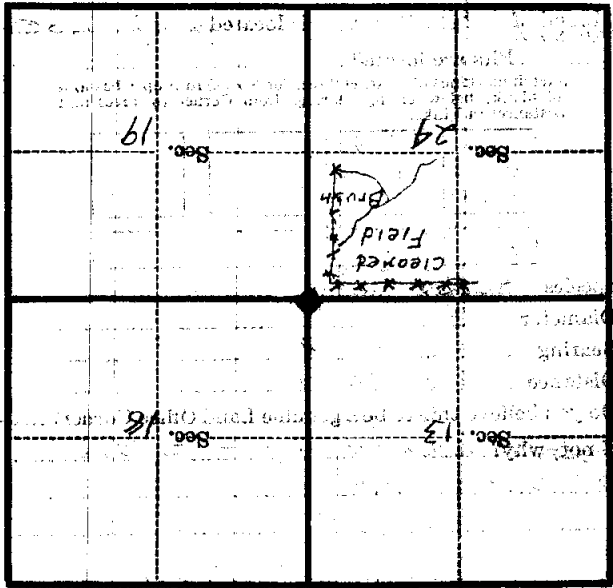

(Make sketch of topography near Corner)

T. 145 N. R. 29 E. 30

3 22

N-1 Mer.