

Form 874-9—Revised May, 1918
U. S. DEPARTMENT OF AGRICULTURE
FOREST SERVICE

Posted 271

Chip NATIONAL FOREST

CORNERS OF THE PUBLIC SURVEY

T. 147 N R. 28 W 5th Mer.

Quarter Corner common to Sections
_____, _____, 1, and 2

Corner consists of a Squared tree (not) in place
State condition Tree is alive (Tammargok)

Dimensions above ground 20 ft Tall inches.

Sketch grooves, letters, figures, or notches, on proper face or edge.

CARDINAL POSITION

DIAGONAL POSITION

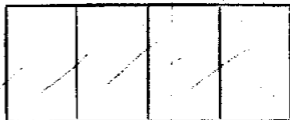
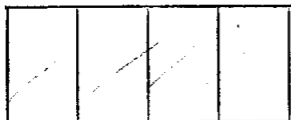

Mound of _____ is located S

← Pits are located ←

Sketch markings of Bearing Trees (or Rocks) in proper box and fill blanks below, giving bearings from Corner to Trees and Distances in Links.

Species _____
 Diameter _____
 Bearing _____
 Distance _____

Do you believe this to be a genuine Land Office Corner? No
If not, why? No witness trees could be found.

Roy A. Chapman
Signature.
Ranger
Title.
Nov. 26
Date.

T. 147 R. 28 Mer.

8-3027 (Make sketch of topography near Corner.)

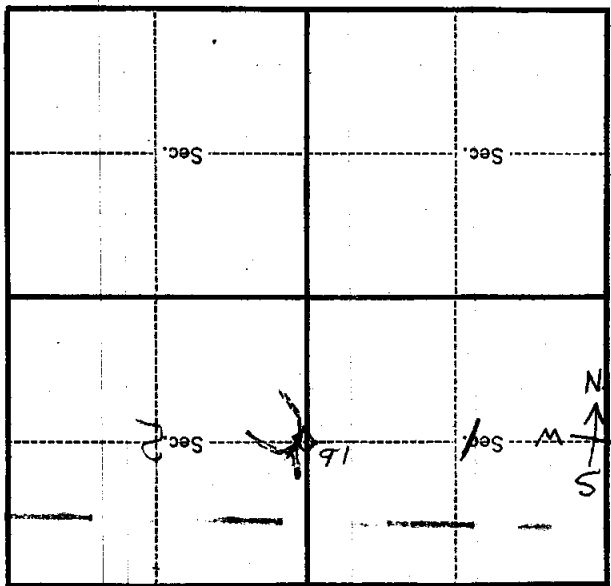

Metal Location Poster is on a _____ inches diameter, on the _____ side of _____ from which this Corner bears _____ chains distant. Give any further facts which will aid in finding this Corner again.