

U. S. DEPARTMENT OF AGRICULTURE
FOREST SERVICE

Chippewa NATIONAL FOREST

CORNERS OF THE PUBLIC SURVEY

T. 147 N R. 28 W 5+6 Mer.

Section _____ Corner common to Sections

5, 4, 8, and 9

Corner consists of a Birch tree (not) in place

State condition Fair

Dimensions above ground 6" DBH inches.

Sketch grooves, letters, figures, or notches, on proper face or edge.

CARDINAL POSITION

DIAGONAL POSITION

<u>None</u>			
N	W	S	E

<u>None</u>			
NW	SW	SE	NE

Mound of _____ is located _____

← Pits are located _____

Sketch markings of Bearing Trees (or Rocks) in proper box and fill blanks below, giving bearings from Corner to Trees and Distances in Links.

Species _____

Diameter _____

Bearing _____

Distance _____

Do you believe this to be a genuine Land Office Corner? No

If not, why? No definite evidence.

Section lines cross here

G.W. Pike

Signature.

12-31-28

Date.

Forest Ranger

Title.

T. 147 N. R. 28 W. S. Mer.

8-3027 (Make sketch of topography near corner.)

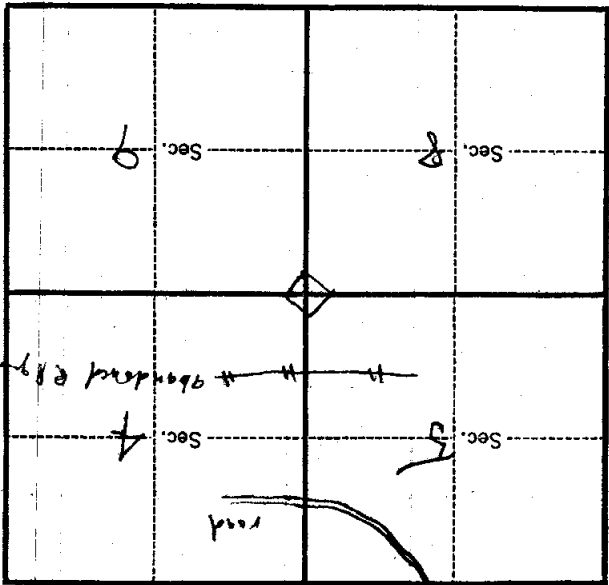

Metal Location Poster is on a

4 inches diameter, on the

side of ~~2nd tree~~ tree

from which this Corner bears

S.W. chains distant.

Give any further facts which will aid in finding this

Corner again.

metal poster on
road near N 815 line
1/4 mile W of
camp 101