

U. S. Department of Agriculture
FOREST SERVICE

G-25

Chippewa NATIONAL FOREST

CORNERS OF THE PUBLIC SURVEY

T. 147 N R. 21 W 5 1/2 Mer.

Corner common to Sections

7, and 12

Corner consists of a Iron Pipe in place

State condition Just Erected

Dimensions above ground 2' - 28 inches

Sketch grooves, letters, figures, or notches, on proper face or edge.

CARDINAL POSITION

DIAGONAL POSITION

Q27	Q26
S12	S7

--	--	--	--

N W S E

NW SW SE NE

Mound of _____ is located _____

Pits are located _____

Sketch markings of Bearing Trees (or Rocks) in proper box and fill blanks below, giving bearings from Corner to Trees and Distances in Links.

S7	S12		
B.T	B.T		

Species Spruce Spruce

Diameter 4" 5"

Bearing N57°E N10°W

Distance 39 32

Do you believe this to be a genuine Land Office Corner? yes

If not, why? _____

(Signature)

(Date)

(Title)

1936

53

(Make sketch of topography near Corner)

	Sec. 7	Sec. 7	Sec. 7
Q 28 W	Q 28 W	Q 28 W	Q 28 W

Metal Location Poster is on a

tree inches diameter, on the

side of

from which this Corner bears

chains distant.

Give any further facts which will aid in finding this

Corner again.

T. 147N R. 21W 5th Mer.

U. S. Department of Agriculture
FOREST SERVICE

R
25

Chippewa NATIONAL FOREST

CORNERS OF THE PUBLIC SURVEY

T. 147N R. 27W 5th Mer.

Corner common to Sections

_____, _____, and _____

Corner consists of a Small Pipe (hat) in place

State condition just under

Dimensions above ground _____ inches

Sketch grooves, letters, figures, or notches, on proper face or edge.

CARDINAL POSITION

DIAGONAL POSITION

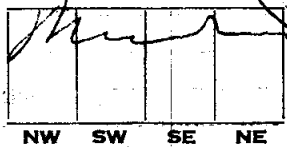
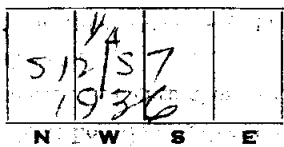

Mound of _____ is located _____

Pits are located _____

Sketch markings of Bearing Trees (or Rocks) in proper box and fill blanks below, giving bearings from Corner to Trees and Distances in Links.

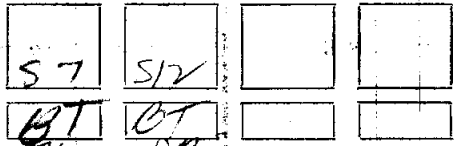

Species Knotty Pine

Diameter 8 1/2" 10"

Bearing N 70° E S 60° W

Distance 24 20

Do you believe this to be a genuine Land Office Corner? _____

If not, why? _____

Yes

(Signature)

(Date)

(Title)

CORNER OF THE PUBLIC SURVEY

Corner again:

Give any further facts which will aid in finding this

chain distant.

from which this Corner bears

side of

tree inches diameter, on the

Metal Location Poster is on a

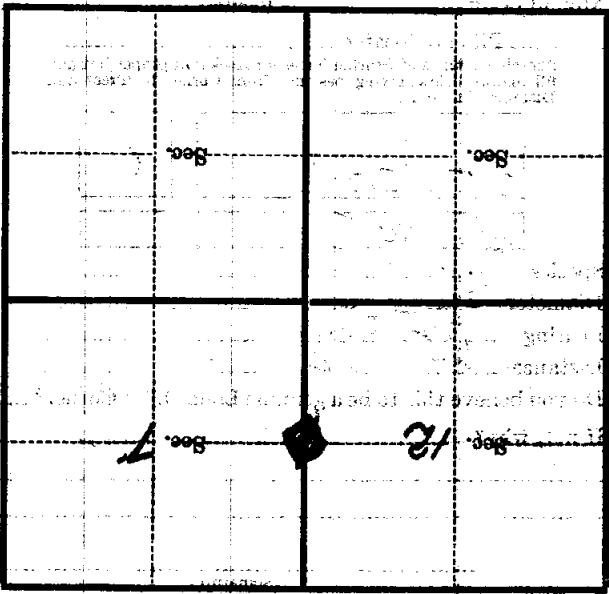

(Make sketch of topography near Corner)

Form 874-G—Revised May, 1918
 U. S. Department of Agriculture
 FOREST SERVICE

Chippewa NATIONAL FOREST 6-25

CORNERS OF THE PUBLIC SURVEY

T. T47N R. R7W - 5th Mer.

1/4 Corner Corner common to Sections
 _____, _____, 7, and 12

Corner consists of Iron Pipe (new) in place
 State condition just erected

Dimensions above ground 2" - 28 inches

Sketch any letters, figures, or notches, on proper face or edge.

T 147 N R 7 W

CARDINAL POSITION

	<u>7/12</u>		
	<u>1936</u>		
N	W	S	E

DIAGONAL POSITION

<u>Marked</u>			
NW	SW	SE	NE

Mound of _____ is located _____

Pits are located _____

Sketch markings of Bearing Trees (or Rocks) in proper box and fill blanks below, giving bearings from Corner to Trees and Distances in Links.

<u>57</u>	<u>512</u>		
<u>BT</u>	<u>BT</u>		

Species Spencer Spruce

Diameter 5 1/2"

Bearing N57°E N10°W

Distance 39 32

Do you believe this to be a genuine Land Office Corner? Yes

If not, why? _____

(Signature)

(Date)

(Title)

Metal Location Poster is on a tree inches diameter, on the side of from which this Corner bears chains distant. Give any further facts which will aid in finding this Corner again.

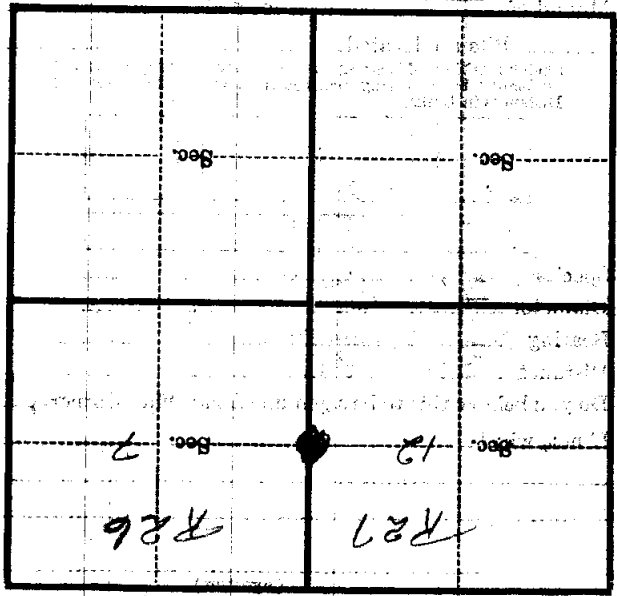

T. T. 147N R. 38W Mer. *SM*