

U. S. Department of Agriculture  
FOREST SERVICE

R23  
P

Chippewa NATIONAL FOREST

CORNERS OF THE PUBLIC SURVEY

T. 147N R. 27W 5th Mer.

SECTION Corner common to Sections

24, 17, 25, and 30

Corner consists of a Covered box (not) in place

State condition new

Dimensions above ground \_\_\_\_\_ inches

Sketch grooves, letters, figures, or notches, on proper face or edge.

CARDINAL POSITION

DIAGONAL POSITION

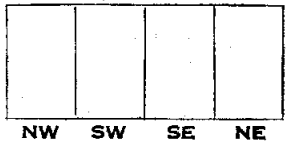
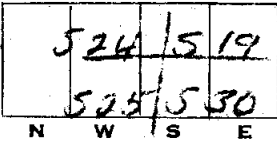

Mound of \_\_\_\_\_ is located \_\_\_\_\_

Pits are located \_\_\_\_\_

Sketch markings of Bearing Trees (or Rocks) in proper box and fill blanks below, giving bearings from Corner to Trees and Distances in Links.

	T147	T147	T147
519	P26	P27	P27
	530	525	524
BT	BT	BT	BT

Species Tree Under Tap Cedar  
 Diameter 4 5 4  
 Bearing N 75 E S 21 W N 75 W  
 Distance 7 3 21 1 1/2

Do you believe this to be a genuine Land Office Corner? Yes  
If not, why? \_\_\_\_\_

(Signature)

(Date)

(Title)

75

Metal Location Poster is on a tree \_\_\_\_\_ inches diameter, on the side of \_\_\_\_\_ from which this Corner bears \_\_\_\_\_ chains distant.

Give any further facts which will aid in finding this Corner again.

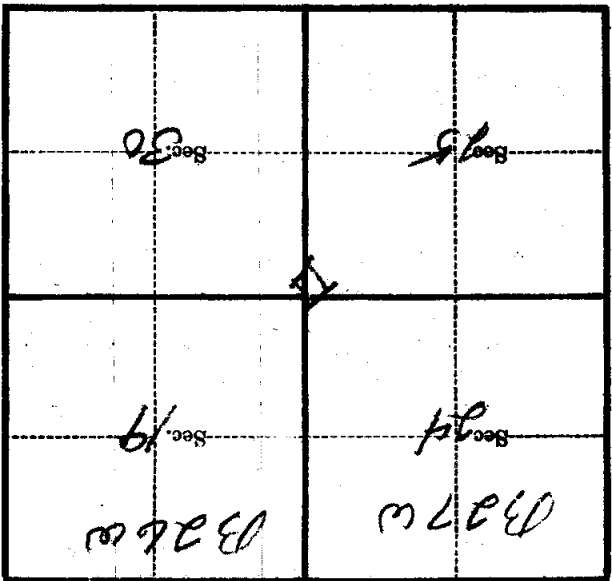

(Make sketch of topography near Corner)

T147N R27W 5th Mer.

U. S. Department of Agriculture  
FOREST SERVICE

R-25

Chippewa NATIONAL FOREST

CORNERS OF THE PUBLIC SURVEY

T. 147N R. 27W 5th Mer.

Section Corner common to Sections  
24, 19, 25, and 30

Corner consists of a Concrete Mon (not) in place

State condition New

Dimensions above ground \_\_\_\_\_ inches

Sketch grooves, letters, figures, or notches, on proper face or edge.

CARDINAL POSITION

DIAGONAL POSITION

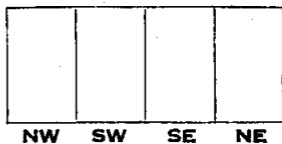
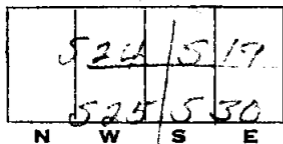

Mound of \_\_\_\_\_ is located \_\_\_\_\_

Pits are located \_\_\_\_\_

Sketch markings of Bearing Trees (or Rocks) in proper box and fill blanks below, giving bearings from Corner to Trees and Distances in Links.

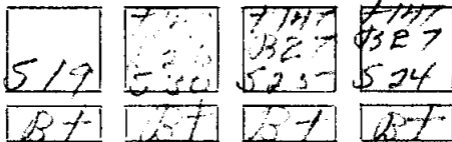

Species Man Cedar Tam Cedar  
 Diameter 4 5 5 4  
 Bearing N63E S52E S11W N75W  
 Distance 12 33 21 1 1/2

Do you believe this to be a genuine Land Office Corner? yes  
If not, why? \_\_\_\_\_

(Signature)

(Date)

(Title)

75

Corner again.

Give any further facts which will aid in finding this

chains distant.

from which this Corner bears

side of

tree inches diameter, on the

Metal Location Poster is on a

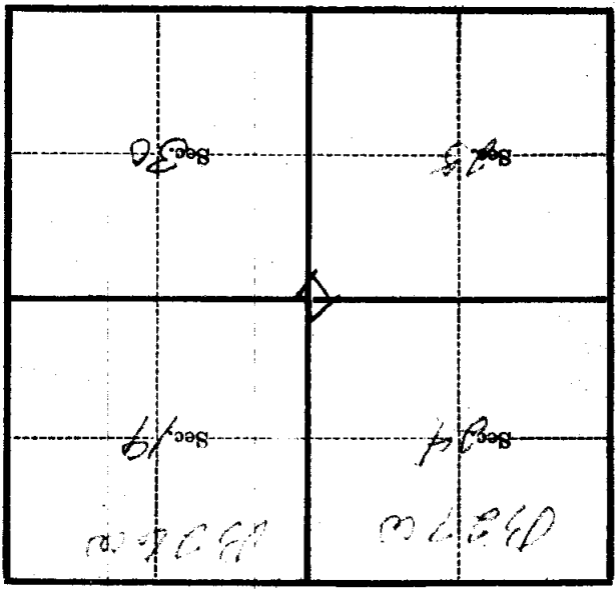

(Make sketch of topography near Corner)

T. 147 N. R. 27 W. 5th Mer.

U. S. Department of Agriculture

FOREST SERVICE

R-25

Chippewa NATIONAL FOREST

CORNERS OF THE PUBLIC SURVEY

T. 142N R. 22W 5th Mer.

50710N Corner common to Sections 24, 19, 25, and 30

Corner consists of a COMMON (not) in place State condition just created

Dimensions above ground 6"-24'-20" inches

Sketch grooves, letters, figures, or notches, on proper face or edge.

CARDINAL POSITION

DIAGONAL POSITION

B270	526		
524	517		
525	530		
N	W	S	E

NW	SW	SE	NE

Mound of is located

Pits are located

Sketch markings of Bearing Trees (or Rocks) in proper box and fill blanks below, giving bearings from Corner to Trees and Distances in Links.

7147
536
517

7147
526
530

7147
527
525

7147
527
524

67
----

67
----

67
----

67
----

Species Tamarack Cedar Tamarack Cedar

Diameter 4 5 5 4

Bearing N63W S67E S11W N75W

Distance 12 33 21 1 1/2

Do you believe this to be a genuine Land Office Corner? Yes

If not, why?

(Signature)

(Date)

(Title)

72

Metal Location Poster is on a tree \_\_\_\_\_ inches diameter, on the \_\_\_\_\_ side of \_\_\_\_\_ from which this Corner bears \_\_\_\_\_ chains distant.

Give any further facts which will aid in finding this Corner again.

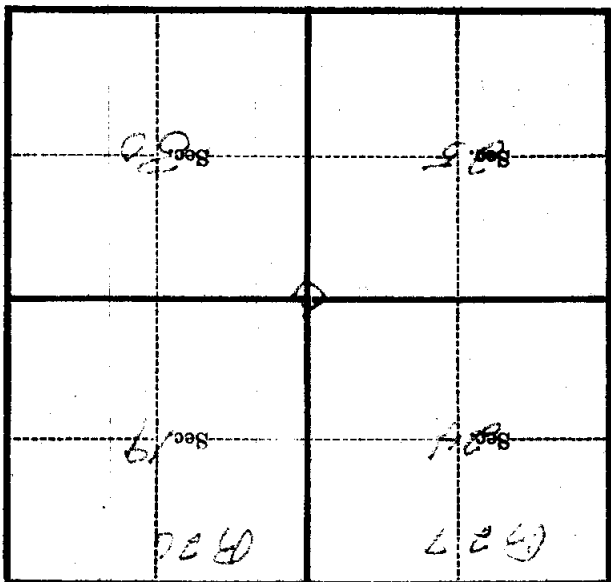

(Make sketch of topography near Corner)

T. L. R. R. 2000 576 Mer.

U. S. Department of Agriculture

FOREST SERVICE

R. 25

Chippewa

NATIONAL FOREST

CORNERS OF THE PUBLIC SURVEY

T. 147N R. 27W 7th Mer.

Section

Corner common to Sections

24, 19, 25, and 30

Corner consists of a Con. Mon. (1/2") in place

State condition Just erected

Dimensions above ground 6" x 36" inches

Sketch grooves, letters, figures, or notches, on proper face or edge.

CARDINAL POSITION

DIAGONAL POSITION

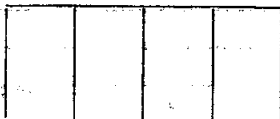

N W S E

NW SW SE NE

Mound of is located

Pits are located

Sketch markings of Bearing Trees (or Rocks) in proper box and fill blanks below, giving bearings from Corner to Trees and Distances in Links.

T. 147N  
R. 26  
S. 19

T. 147N  
R. 26  
S. 30

T. 147N  
R. 26  
S. 25

T. 147N  
R. 26  
S. 24

B.T.

B.T.

B.T.

B.T.

Species ~~Jun.~~ Cedar

Diameter 4" 5"

Bearing N65E S64E S11W N75W

Distance 112ln. 131ln. 212ln. 112ln.

Do you believe this to be a genuine Land Office Corner? Yes.

If not, why?

(Signature)

(Date)

(Title)

92

Blank grid area for drawing or notes.

Corner again.

Give any further facts which will aid in finding this

chains distant.

from which this Corner bears

side of

tree inches diameter, on the

Metal Location Poster is on a

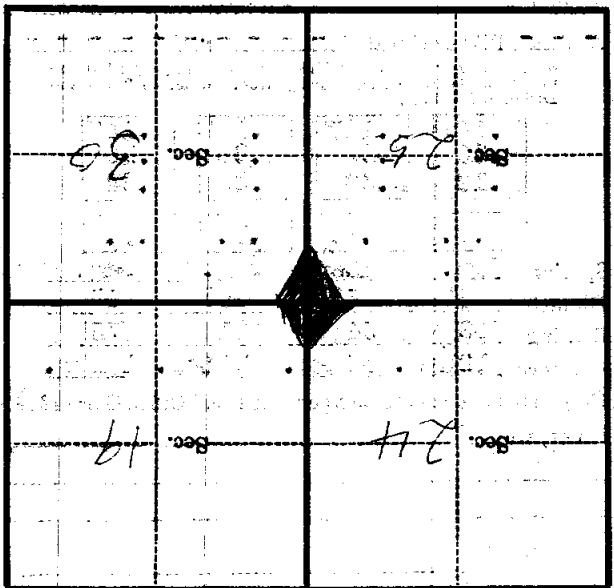

(Make sketch of topography near Corner)



U. S. Department of Agriculture

FOREST SERVICE

R-25

Chippewa NATIONAL FOREST

CORNERS OF THE PUBLIC SURVEY

T. 147N R. 27W 5th Mer.

Section Corner common to Sections

24, 19, 25, and 30

Corner consists of a Con. Mon. (464) in place

State condition Just erected

Dimensions above ground 6" x 24" inches

Sketch grooves, letters, figures, or notches, on proper face or edge.

CARDINAL POSITION

DIAGONAL POSITION

T. 147N	R. 27W	R. 26W
S. 24	S. 19	S. 30
1956		

N W S E

NW SW SE NE

Mound of - - - - is located - - - -

Pits are located - - - -

Sketch markings of Bearing Trees (or Rocks) in proper box and fill blanks below, giving bearings from Corner to Trees and Distances in Links.

T. 147N
R. 26
S. 19

T. 147N
R. 26
S. 30

T. 147N
R. 26
S. 25

T. 147N
R. 26
S. 24

B.T.

B.T.

B.T.

B.T.

Species ~~Tax.~~ ~~Ceder~~ Tax. ~~Ceder~~

Diameter 4" 5" 5" 4"

Bearing N63E S54E S11W N75W

Distance 12Lks. 33Lks. 21Lks. 1Lks.

Do you believe this to be a genuine Land Office Corner? Yes.

If not, why?

*[Signature]*

(Signature)

(Date)

(Title)

Section

TAKE

24 25 26 27

Corner again.

Give any further facts which will aid in finding this

chains distant.

from which this Corner bears

side of

tree inches diameter, on the

Metal Location Poster is on a

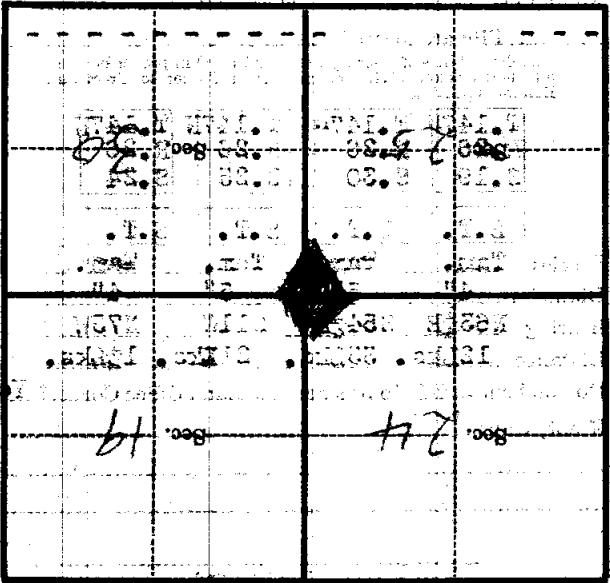

(Make sketch of topography near Corner)

U. S. Department of Agriculture  
FOREST SERVICE

*Shawnee*

R-25

NATIONAL FOREST  
CORNERS OF THE PUBLIC SURVEY

T 147 R. 29 S Mer.

Section 29, 19, 25, and 30  
Corner common to Sections

Corner consists of a Con. Mon. in place  
State condition Just erected.

Dimensions above ground \_\_\_\_\_ inches

Sketch grooves, letters, figures, or notches, on proper face or edge.

CARDINAL POSITION

DIAGONAL POSITION

T 147 N	
R 29 W	S 19 W
24	S 19
S 29	S 30

Marked			

N    E    W    S    E

NW   SW   SE   NE

Mound of \_\_\_\_\_ is located \_\_\_\_\_

Pits are located \_\_\_\_\_

Sketch markings of Bearing Trees (or Rocks) in proper box and fill blanks below, giving bearings from Corner to Trees and Distances in Links.

<u>S 19</u>	<u>T 147</u> <u>R 26</u> <u>S 30</u>	<u>T 147</u> <u>R 27</u> <u>S 25</u>	<u>T 147</u> <u>R 27</u> <u>S 24</u>
<u>BT</u>	<u>BT</u>	<u>BT</u>	<u>BT</u>

Species	<u>Tam Cedar</u>	<u>Tam Cedar</u>	<u>Cedar</u>
Diameter	<u>4 1/2</u>	<u>5 1/2</u>	<u>4 1/2</u>
Bearing	<u>N 63 1/2 E</u>	<u>S 54 1/2 E</u>	<u>S 11 W</u>
Distance	<u>12</u>	<u>33</u>	<u>21</u>

Do you believe this to be a genuine Land Office Corner Yes

If not, why? \_\_\_\_\_

(Signature)

(Date)

(Title)

75

Metal Location Poster is on a tree inches diameter, on the side of from which this Corner bears chains distant.

Give any further facts which will aid in finding this Corner again.

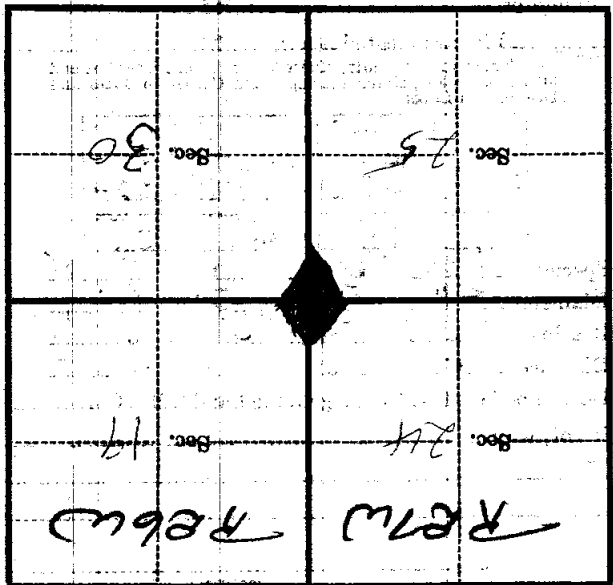

(Make sketch of topography near Corner)

T. 147 R. 27 Mer.