

U. S. Department of Agriculture

FOREST SERVICE

0-24

Chippewa NATIONAL FOREST

CORNERS OF THE PUBLIC SURVEY

T. 147 R. 27 5th Mer.

1/16#6

Corner common to Sections

....., and 24

Corner consists of a wood post (not) in place

State condition good

Dimensions above ground 4" 4" 30" inches

Sketch grooves, letters, figures, or notches, on proper face or edge.

CARDINAL POSITION

DIAGONAL POSITION

--	--	--	--

N W S E

--	--	--	--

NW SW SE NE

Mound of ..... is located .....

Pits are located .....

Sketch markings of Bearing Trees (or Rocks) in proper box and fill blanks below, giving bearings from Corner to Trees and Distances in Links.

1/16 S			
Bt			

Species J. Pine

Diameter 3"

Bearing n49°

Distance .09

Do you believe this to be a genuine Land Office Corner? No

If not, why? County corner

Walter Haberle

(Signature)

Leader

11/29/39

(Date)

(Title)

Corner again.

Give any further facts which will aid in finding this

chains distant.

from which this Corner bears

side of

tree inches diameter, on the

Metal Location Poster is on a The bearing tree

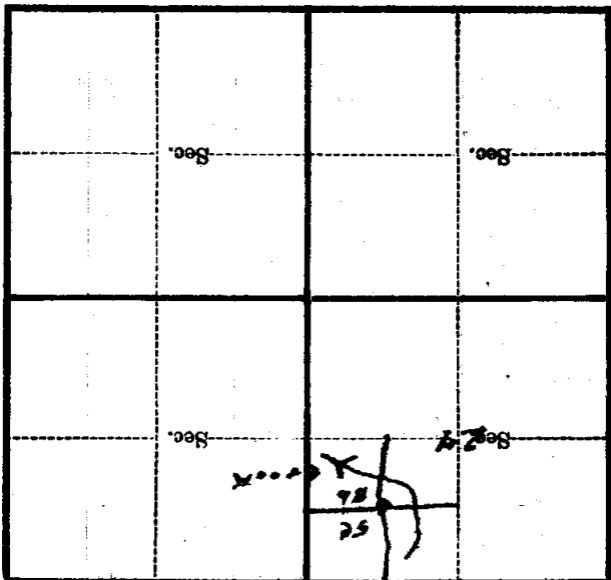

(Make sketch of topography near Corner)

Mer.

5th

R. 27

T. 147

U. S. Department of Agriculture

FOREST SERVICE

Chippewa

NATIONAL FOREST

0-24

CORNERS OF THE PUBLIC SURVEY

T. 147 R. 27 5th Mer.

1/16#6

Corner common to Sections

24

Corner consists of a Wood post (not) in place

State condition Good

Dimensions above ground 4" 4" 30" inches

Sketch grooves, letters, figures, or notches, on proper face or edge.

CARDINAL POSITION

DIAGONAL POSITION

--	--	--	--

N W S E

--	--	--	--

NW SW SE NE

Mound of is located

Pits are located

Sketch markings of Bearing Trees (or Rocks) in proper box and fill blanks below, giving bearings from Corner to Trees and Distances in Links.

1/16
S

--

--

--

BT
----

--

--

--

Species J. Pine

Diameter 8"

Bearing N49E

Distance .09

Do you believe this to be a genuine Land Office Corner? No

If not, why? County corner

Walter Haberle

(Signature)

Leader

11/29/39

(Date)

(Title)

Corner again.

Give any further facts which will aid in finding this  
 chains distant.  
 from which this Corner bears  
 side of  
 tree inches diameter, on the  
 Metal Location Poster is on a  
 The berrring tree

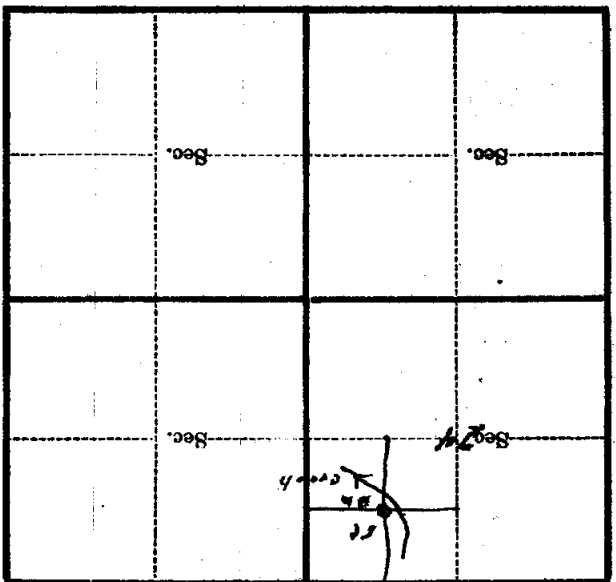

(Make sketch of topography near Corner)