

U. S. Department of Agriculture

FOREST SERVICE

J-13

Chippewa NATIONAL FOREST

CORNERS OF THE PUBLIC SURVEY

T. 147N R. 27W 5th Mer.

Section 11 Corner common to Sections 9, 10, 14, and 15

Corner consists of a ~~concret man~~ in place

State condition ~~just~~ Erected

Dimensions above ground 6"-24"-20" inches

Sketch grooves, letters, figures, or notches, on proper face or edge.

CARDINAL POSITION

DIAGONAL POSITION

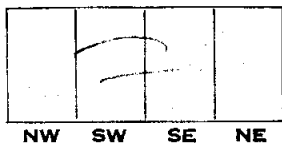
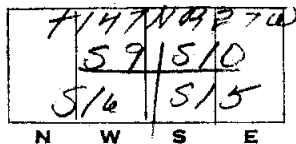

Mound of _____ is located _____

Pits are located _____

Sketch markings of Bearing Trees (or Rocks) in proper box and fill blanks below, giving bearings from Corner to Trees and Distances in Links.

510	515	510	59
B.T.	B.T.	B.T.	B.T.

Species	NP	NP	NP	SP
Diameter	2"	1 1/2"	2"	2"
Bearing	N31 1/2 E	S73 1/4 E	S73 W	N50 1/2 W
Distance	16	18	24	25

Do you believe this to be a genuine Land Office Corner? *yes*

If not, why? _____

(Signature)

1936
(Date)

(Title)

Metal Location Poster is on a tree _____ inches diameter, on the _____ side of _____ from which this Corner bears _____ chains distant.

Give any further facts which will aid in finding this Corner again.

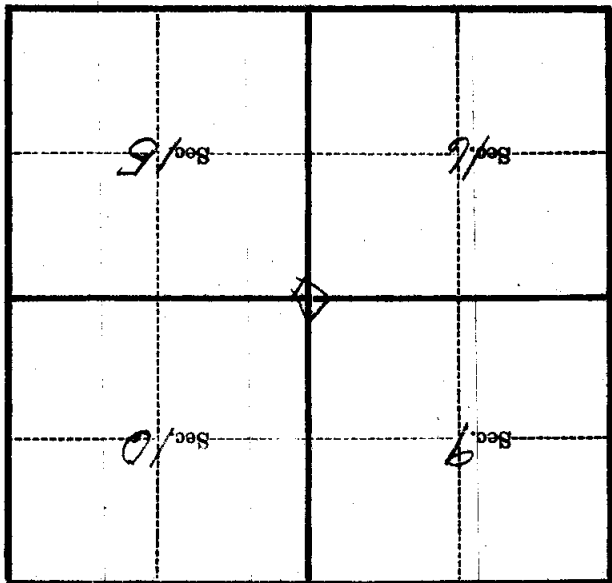

(Make sketch of topography near Corner)

T. 142N R. 27W 5th Mer.

U. S. Department of Agriculture

FOREST SERVICE

P
J13

Chippewa NATIONAL FOREST

CORNERS OF THE PUBLIC SURVEY

T. 147N R. 27W 5th Mer.

Section 11 Corner common to Sections 9, 10, 14, and 15

Corner consists of a ~~concreted mound~~ in place
State condition just Erected

Dimensions above ground 6"-24"-20" inches

Sketch grooves, letters, figures, or notches, on proper face or edge.

CARDINAL POSITION

DIAGONAL POSITION

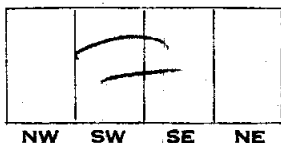
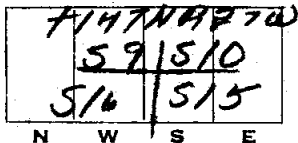

Mound of _____ is located _____

Pits are located _____

Sketch markings of Bearing Trees (or Rocks) in proper box and fill blanks below, giving bearings from Corner to Trees and Distances in Links.

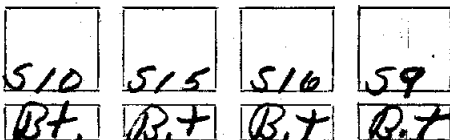

Species NP NP NP 59
 Diameter 2" 1 1/2" 1 1/2" 7"
 Bearing N31 1/2 E S23 1/2 E S75 W N50 1/2 W
 Distance 16 18 24 25

Do you believe this to be a genuine Land Office Corner? yes
If not, why? _____

(Signature)

1936
(Date)

(Title)

13

Metal Location Poster is on a tree inches diameter, on the side of from which this Corner bears chains distant.

Give any further facts which will aid in finding this Corner again.

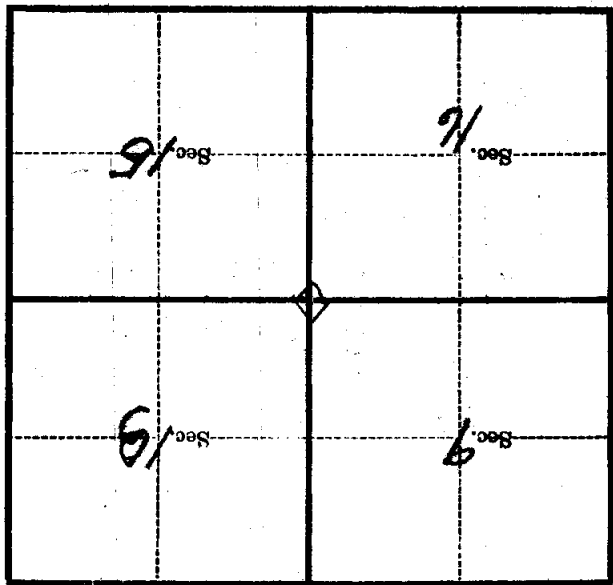

(Make sketch of topography near Corner)

T. 142N R. 27W 5th Mer.

U. S. Department of Agriculture
FOREST SERVICE

Chippewa NATIONAL FOREST
CORNERS OF THE PUBLIC SURVEY

J-13

T. 17N R. 27W 5th Mer.

Section Corner common to Sections
9, 10, 16, and 15

Corner consists of a Common in place
State condition SE

Dimensions above ground 6x74x20 inches
Sketch grooves, letters, figures, or notches, on proper face or edge.
CARDINAL POSITION DIAGONAL POSITION

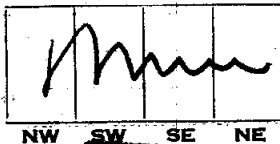
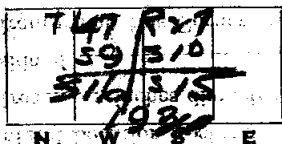

Mound ~~is~~ is located

Pits are located

Sketch markings of Bearing Trees (or Rocks) in proper box and fill blanks below, giving bearings from Corner to Trees and Distances in Links.

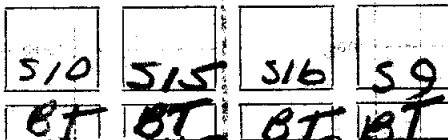

Species	NP	NP	NP	NP
Diameter	12"	14"	8"	9"
Bearing	N31°E	S73°E	S73°W	N50°W
Distance	16	18	24	25

Do you believe this to be a genuine Land Office Corner?

If not, why?

Yes

(Signature)

(Date)

(Title)

CORNER OF THE PUBLIC SURVEY

Give any further facts which will aid in finding this corner again.

chains distant

from which this Corner bears

side of

tree inches diameter, on the

Metal Location Poster is on a

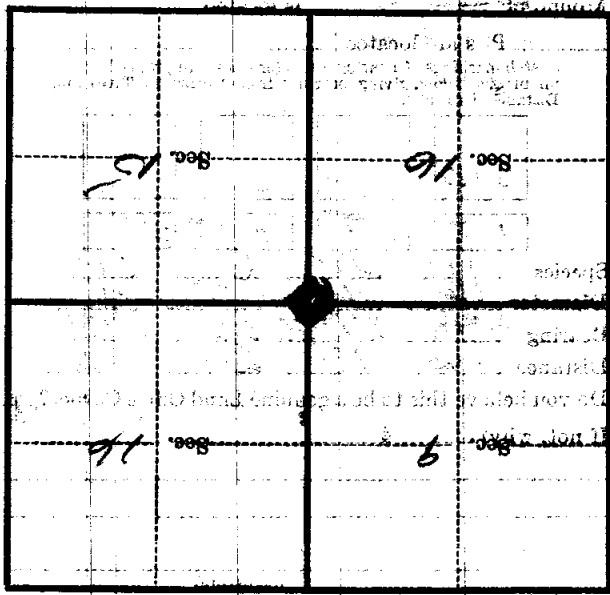

(Make sketch of topography near Corner)