

U. S. DEPARTMENT OF AGRICULTURE  
FOREST SERVICE

*Posted*

Minn. NATIONAL FOREST N-9

CORNERS OF THE PUBLIC SURVEY

T. 147W R. 27W 3<sup>rd</sup> Mer.

Section Corner common to Sections  
16, 17, 20, and 21

DESCRIPTION OF CORNER

Corner consists of a US stake.

Dimension above ground 4" x 4" x 4" inches.

Sketch grooves, letters, figures, or notches, on proper face or edge.

CARDINAL POSITION

DIAGONAL POSITION

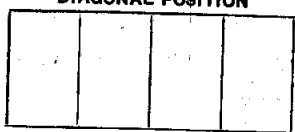
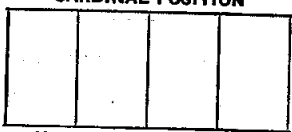

Mound of \_\_\_\_\_ is located \_\_\_\_\_

Pits are located \_\_\_\_\_

Sketch markings of Bearing Trees (or Rocks) in proper box and fill blanks below, giving bearings from Corner to Trees and Distances in Links.

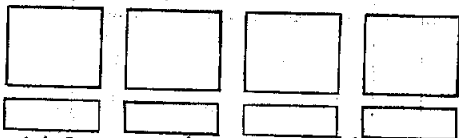

Species	<u>NR</u>	<u>NP down</u>	<u>NP 5' 1/2</u>	<u>Burnt</u>
Diameter	<u>16"</u>	<u>4 9"</u>	<u>2 1"</u>	
Bearing	<u>N 20 E</u>	<u>S 45 E</u>	<u>S 70 N</u>	
Distance	<u>20'</u>	<u>25'</u>	<u>45'</u>	

Do you believe this to be a genuine Land Office Corner? Yes

If not, why? all bearing trees from

They are down and are  
burnt up. Bearing all  
legible on 6 top but very faint  
H. H. H. H.

Signature

8/7/26

Date

Forest Exp.

Title

30 ft N of old ft  
 need to mark the  
 corner to the  
 corner again.

Give any further facts which will aid in finding this  
 chains distant  
 from which this Corner bears  
 side of  
 tree inches diameter, on the  
 Metal Location Poster is on a

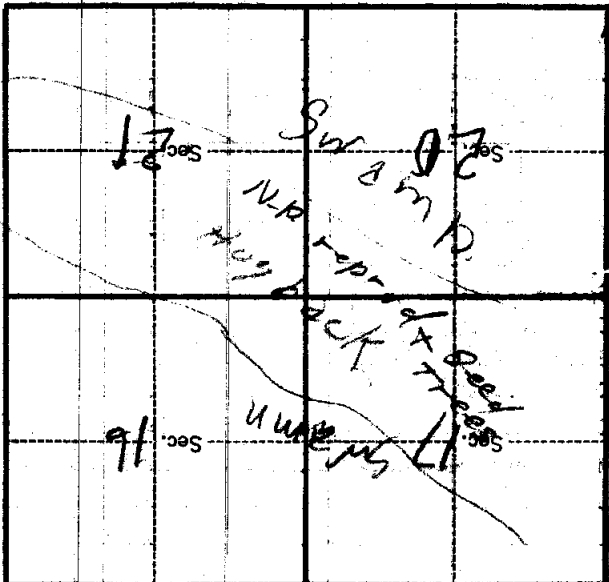

(Make sketch of topography near Corner.)

U. S. Department of Agriculture  
FOREST SERVICE

N-9

Chippewa NATIONAL FOREST

CORNERS OF THE PUBLIC SURVEY

T. 147N R. 27W 5th Mer.

Section Corner common to Sections  
12, 16, 21, and 20

Corner consists of a crossed (not) in place

State condition SET IN CEMENT

Dimensions above ground 6" inches

Sketch grooves, letters, figures, or notches, on proper face or edge.

CARDINAL POSITION

DIAGONAL POSITION

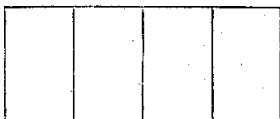

N W S E

NW SW SE NE

Mound of \_\_\_\_\_ is located \_\_\_\_\_

Pits are located \_\_\_\_\_

Sketch markings of Bearing Trees (or Rocks) in proper box and fill blanks below, giving bearings from Corner to Trees and Distances in Links.

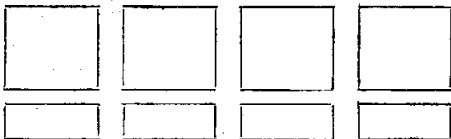

Species SP. 29 W.D.

Diameter 18 18

Bearing N44E N21E

Distance 39 36

Do you believe this to be a genuine Land Office Corner? Yes

If not, why? \_\_\_\_\_

(Signature)

(Date)

(Title)

66

Metal Location Poster is on a tree inches diameter, on the side of from which this Corner bears chains distant. Give any further facts which will aid in finding this Corner again.

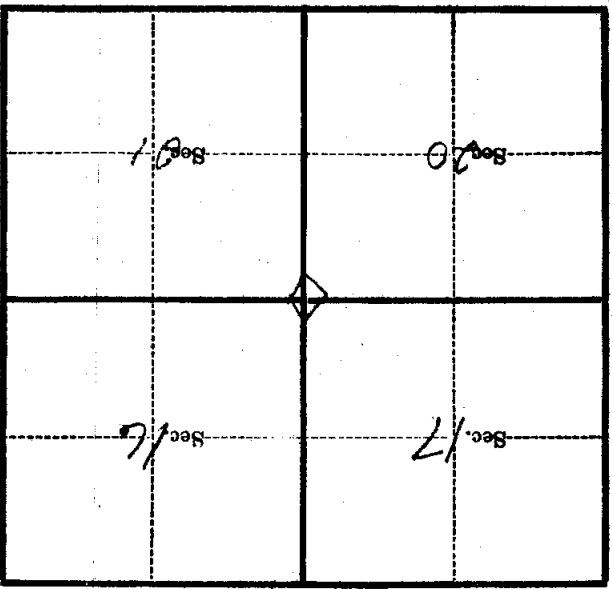

(Make sketch of topography near Corner)

T. 141N. R. 27W. 5th Mer.

U. S. Department of Agriculture

FOREST SERVICE

Chippewa NATIONAL FOREST

N-9

CORNERS OF THE PUBLIC SURVEY

T. 142N R. 27W 5th Mer.

Section — Corner common to Sections

17, 16, 20, and 21

Corner consists of a Brass cap (not) in place

State condition Set in cement

Dimensions above ground 6 inches

Sketch grooves, letters, figures, or notches, on proper face or edge.

CARDINAL POSITION

DIAGONAL POSITION



Mound of is located

Pits are located

Sketch markings of Bearing Trees (or Rocks) in proper box and fill blanks below, giving bearings from Corner to Trees and Distances in Links.

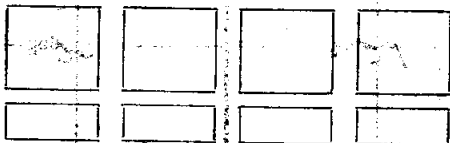

Species N.P. Spruce W.P.

Diameter 15 10

Bearing N44°E N21°E

Distance 39 links

Do you believe this to be a genuine Land Office Corner? Yes

If not, why?

Signature: Jerome P. Nomala

(Signature)

T. Sherman

(Date) (Title) 6650

15 links north of  
Road # 474  
Corner is located about

Corner again.

Give any further facts which will aid in finding this  
chain distant.  
from which this Corner bears  
side of  
tree inches diameter, on the  
~~North~~ *North*

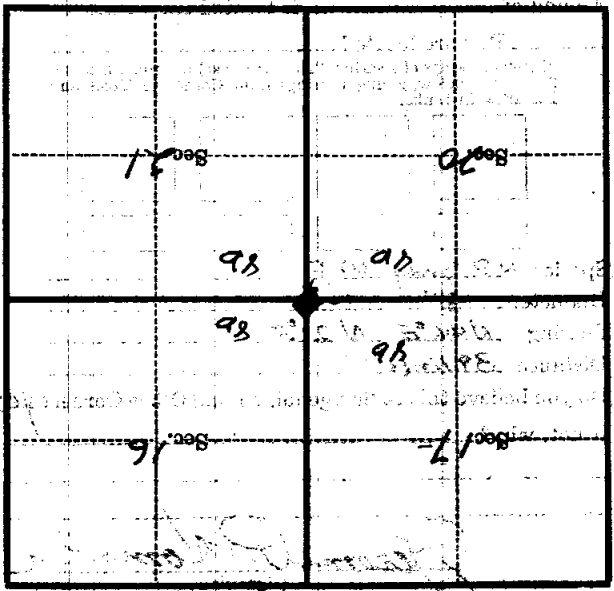

(Make sketch of topography near Corner)

Form 874-9—Revised May, 1918  
 U. S. Department of Agriculture  
 FOREST SERVICE

N 9  
 Posted

Chippewa NATIONAL FOREST  
 CORNERS OF THE PUBLIC SURVEY

T. 147 N R. 27 W Mer.

Section Corner common to Sections  
16, 17, 20, and 21

Corner consists of a Brass cap in concrete (not) in place  
 State condition Good

Dimensions above ground 8" inches

Sketch grooves, letters, figures, or notches, on proper face or edge.

CARDINAL POSITION

DIAGONAL POSITION

--	--	--	--

N W S E

--	--	--	--

NW SW SE NE

Mound of \_\_\_\_\_ is located \_\_\_\_\_

Pits are located \_\_\_\_\_

Sketch markings of Bearing Trees (or Rocks) in proper box and fill blanks below, giving bearings from Corner to Trees and Distances in Links.

Species N.P. W.P. N.P. W.P.

Diameter 20" 8" 18" 10"

Bearing Felled by mistake during cultural operations N. E. N. 44 E. N. 21 E.

Distance 50 ft. 37 lks.

Do you believe this to be a genuine Land Office Corner? Yes

If not, why? \_\_\_\_\_

J. P. Namala  
 Tech. Foreman

5/20/35

W. Banks

(Signature)

9/17/34

(Date)

T. F.

(Title)

-----  
-----  
-----  
-----  
-----  
-----  
-----

Corner is located about 15 lks  
North of Road # 474.

Corner again.

Give any further facts which will aid in finding this

chains distant.

from which this Corner bears

side of

tree inches diameter, on the

~~Metal location Post is on a~~ Not Posted.

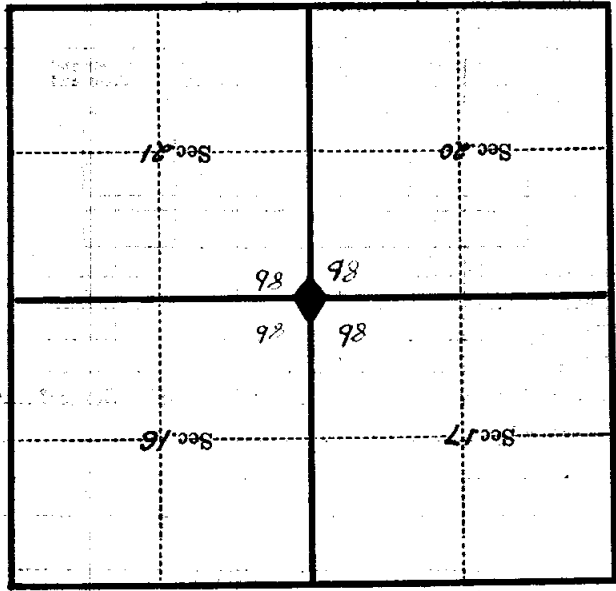

(Make sketch of topography near Corner)



U. S. Department of Agriculture

FOREST SERVICE

N-9

Chippewa NATIONAL FOREST

CORNERS OF THE PUBLIC SURVEY

T. 147 N, R. 27 W 5th Mer.

SECTION Corner common to Sections 12, 16, 21, and 20

Corner consists of a 52.55 deg (300) in place

State condition set increment

Dimensions above ground 6 inches

Sketch grooves, letters, figures, or notches, on proper face or edge.

CARDINAL POSITION

DIAGONAL POSITION

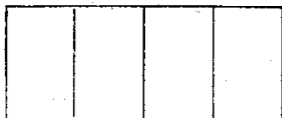

N W S E

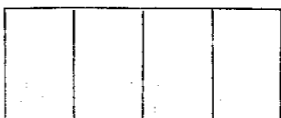

NW SW SE NE

Mound of \_\_\_\_\_ is located \_\_\_\_\_

Pits are located \_\_\_\_\_

Sketch markings of Bearing Trees (or Rocks) in proper box and fill blanks below, giving bearings from Corner to Trees and Distances in Links.

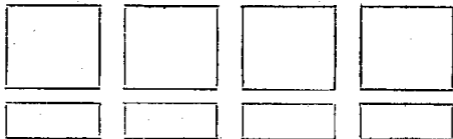

Species MD 51429 4.0

Diameter 12 18

Bearing N44E N21E

Distance 39 36

Do you believe this to be a genuine Land Office Corner? 30

If not, why? \_\_\_\_\_

(Signature)

(Date)

(Title)

65

Metal Location Poster is on a \_\_\_\_\_  
 tree \_\_\_\_\_ inches diameter, on the \_\_\_\_\_  
 side of \_\_\_\_\_  
 from which this Corner bears \_\_\_\_\_  
 chains distant. \_\_\_\_\_  
 Give any further facts which will aid in finding this  
 Corner again.

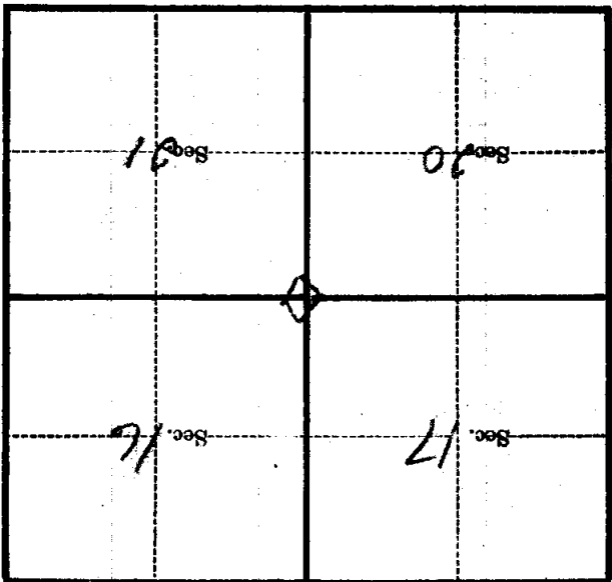

(Make sketch of topography near Corner)

T. 147N R. 27W 5th Mer.