

U. S. Department of Agriculture

FOREST SERVICE

*posted*  
*N17*

*Chippewa* NATIONAL FOREST

CORNERS OF THE PUBLIC SURVEY

T. *17 N* R. *25 W* Mer.

Corner common to Sections

*14, 15, 20, and 21*

Corner consists of a *iron pipe* (not) in place

State condition *good*

Dimensions above ground *1"* inches.

Sketch grooves, letters, figures, or notches, on proper face or edge.

CARDINAL POSITION

DIAGONAL POSITION

|   |   |   |   |
|---|---|---|---|
|   |   |   |   |
| N | W | S | E |

|    |    |    |    |
|----|----|----|----|
|    |    |    |    |
| NW | SW | SE | NE |

Mound of \_\_\_\_\_ is located \_\_\_\_\_

Pits are located \_\_\_\_\_

Sketch markings of Bearing Trees (or Rocks) in proper box and fill blanks below, giving bearings from Corner to Trees and Distances in Links.

|                  |  |  |  |
|------------------|--|--|--|
| <i>1 legible</i> |  |  |  |
|                  |  |  |  |

Species *White Pine* \_\_\_\_\_

Diameter *10"* \_\_\_\_\_

Bearing *N 77 W* \_\_\_\_\_

Distance *0.54 ch* \_\_\_\_\_

Do you believe this to be a genuine Land Office Corner? *Yes*

If not, why? \_\_\_\_\_

(Signature)

(Date)

(Title)

Corner again.  
on additional sheets  
Right hand corner  
Place 5 in  
marked

Give any further facts which will aid in finding this  
chains distant.  
0.225 m  
from which this Corner bears  
side of  
tree 5 inches diameter, on the  
Metal Location Poster is on a

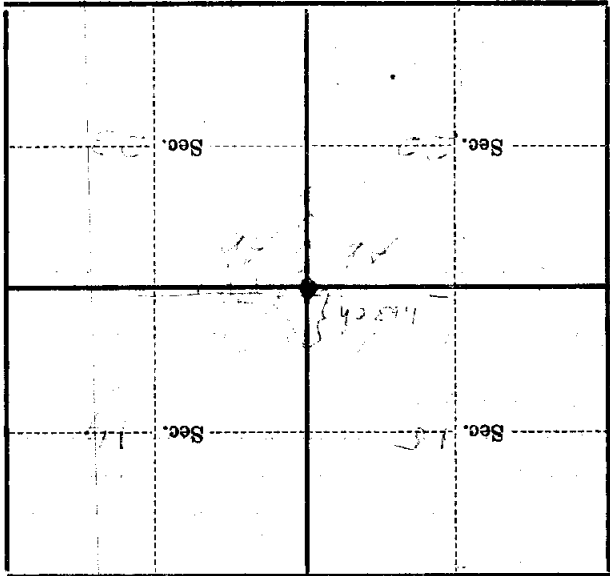

(Make sketch of topography near Corner)

T. 14th N. R. 25 W. Mer.