

U. S. Department of Agriculture

FOREST SERVICE

E-13

Chippewa NATIONAL FOREST

CORNERS OF THE PUBLIC SURVEY

T. 197N R. 25W 5th Mer.

Section Corner common to Sections 3, 4, 9, and 10

Corner consists of a None (not) a place

State condition

Dimensions above ground inches

Sketch grooves, letters, figures, or notches, on proper face or edge.

CARDINAL POSITION

DIAGONAL POSITION

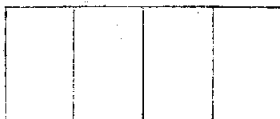

N W S E



NW SW SE NE

Mound of is located

Pits are located

Sketch markings of Bearing Trees (or Rocks) in proper box and fill blanks below, giving bearings from Corner to Trees and Distances in Links.

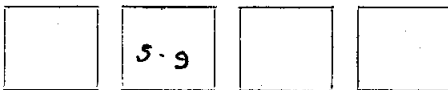

B.T. B.T. B.T.

Species Aspen Aspen Aspen

Diameter 9" 8" 10"

Bearing S56°W N55°W S89°E

Distance 871ks 801ks 1891ks

Do you believe this to be a genuine Land Office Corner? No

If not, why? Records show it was set by

County Surveyor

Arthur J. Johnson (Signature)

Special Foreman (Title)

2/27/40 (Date)

(Make sketch of topography near Corner)

T. 192N R. 25W 5th Mer.

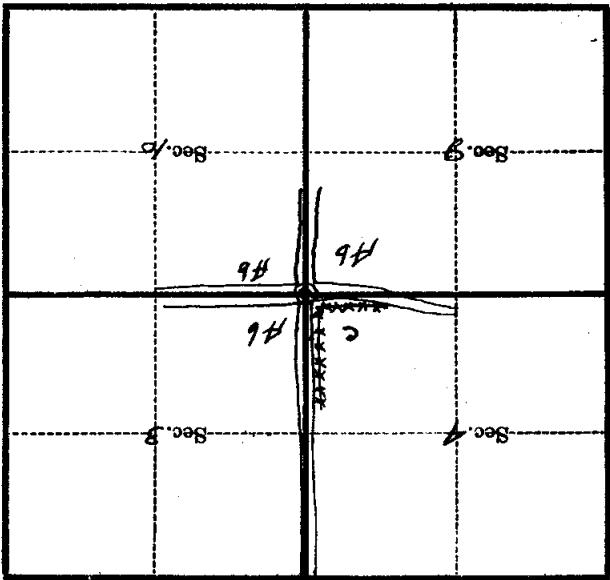

Metal Location Poster is on a

tree inches diameter, on the

side of

from which this Corner bears

chains distant.

Give any further facts which will aid in finding this

Corner again.

U. S. Department of Agriculture

FOREST SERVICE

E-13

Chippewa NATIONAL FOREST

CORNERS OF THE PUBLIC SURVEY

T. 149N R. 25W 5th Mer.

Section Corner common to Sections 3, 4, 9, and 10

Corner consists of a Nail (not) in place

State condition

Dimensions above ground inches

Sketch grooves, letters, figures, or notches, on proper face or edge.

CARDINAL POSITION

DIAGONAL POSITION

Cardinal position diagram with four vertical columns.

Diagonal position diagram with four vertical columns.

N W S E

NW SW SE NE

Mound of is located

Pits are located

Sketch markings of Bearing Trees (or Rocks) in proper box and fill blanks below, giving bearings from Corner to Trees and Distances in Links.

Four boxes for sketching bearing trees, with '39' written in the second box.

Four boxes for 'B.T.' (Bearing Tree) labels, with 'B.T.' written in the first three.

Species Aspen Aspen Aspen

Diameter 9" 8" 10"

Bearing S56°W N55°W S89°E

Distance 871ks 801ks 1891ks

Do you believe this to be a genuine Land Office Corner? No

If not, why? Records show it was set by County Surveyor.

Arthur J. Johnson (Signature)

2/27/40 (Date)

Special Foreman (Title)

(Make sketch of topography near Corner)

T. 147N R. 25W 9th Mer.

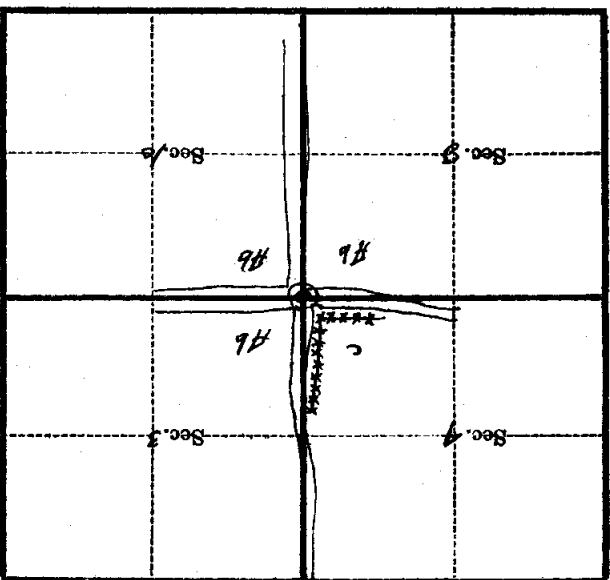

Metal Location Poster is on a tree inches diameter, on the side of from which this Corner bears chains distant. Give any further facts which will aid in finding this Corner again.

U. S. Department of Agriculture
FOREST SERVICE

E13

Chippewa NATIONAL FOREST

CORNERS OF THE PUBLIC SURVEY

T. 197N R. 25W 5th Mer.

Section Corner common to Sections
3, 9, 9, and 10

Corner consists of a None (not) a place

State condition

Dimensions above ground inches

Sketch grooves, letters, figures, or notches, on proper face or edge.

CARDINAL POSITION

DIAGONAL POSITION

--	--	--	--

N W S E

--	--	--	--

NW SW SE NE

Mound of is located

Pits are located

Sketch markings of Bearing Trees (or Rocks) in proper box and fill blanks below, giving bearings from Corner to Trees and Distances in Links.

	59		
BT	BT	BT	

Species Aspen Aspen Aspen

Diameter 2" 8" 10"

Bearing S56°W N55°W S89°E

Distance 871ks 801ks 1891ks

Do you believe this to be a genuine Land Office Corner? NO

If not, why? Records show it was set by

County Surveyor

Arthur J. Johnson

(Signature)

Special Foreman

(Title)

2/27/90

(Date)

(Make sketch of topography near Corner)

T. 197N R. 25W Mer. 57 1/2

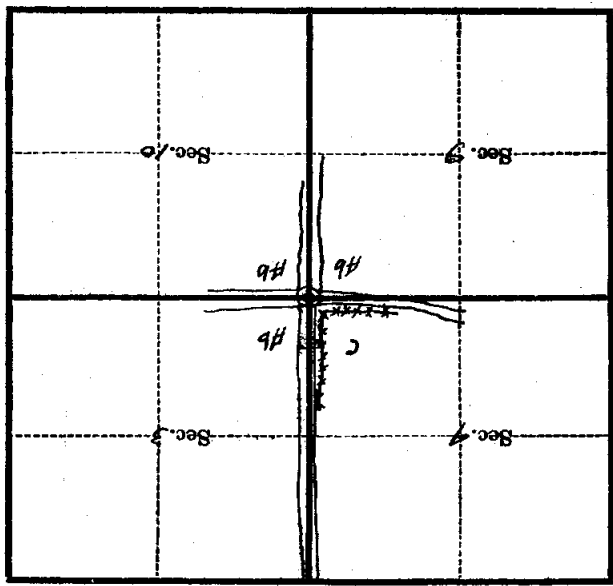

Metal Location Poster is on a

tree inches diameter, on the

side of

from which this Corner bears

chains distant.

Give any further facts which will aid in finding this

Corner again.