

U. S. Department of Agriculture

FOREST SERVICE

E-11

Chippewa NATIONAL FOREST

CORNERS OF THE PUBLIC SURVEY

T. 197 N R. 25 W 5th Mer.

1/4 Corner common to Sections 4 and 9

Corner consists of a 3" scribed Post (set) in place

State condition New

Dimensions above ground 40 inches

Sketch grooves, letters, figures, or notches, on proper face or edge.

CARDINAL POSITION

DIAGONAL POSITION

1/4 S. 9		1/4 S 9	
N	W	S	E

NW	SW	SE	NE

Mound of _____ is located _____

Pits are located _____

Sketch markings of Bearing Trees (or Rocks) in proper box and fill blanks below, giving bearings from Corner to Trees and Distances in Links.

1/4 S. 9	1/4 S 9		
BT	BT		

Species J. Pine J. Pine

Diameter 4" 4"

Bearing S20° E N99° N

Distance 2.1 kcs 8.1 kcs

Do you believe this to be a genuine Land Office Corner? No

If not, why? Set by J. A. Bjelhaug

Arthur J. Johnson

(Signature)

Special Forester

(Title)

2/27/40

(Date)

(Make sketch of topography near Corner)

T. 192N R. 26W S7h Mer.

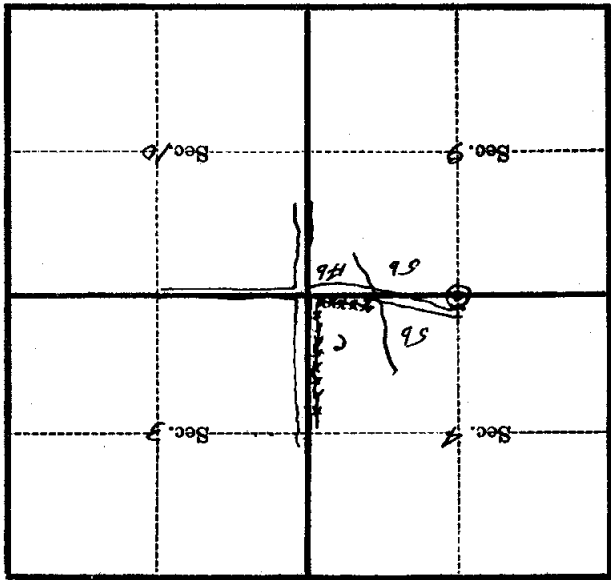

Metal Location Poster is on a

tree inches diameter, on the

side of

from which this Corner bears

chains distant.

Give any further facts which will aid in finding this

Corner again.

U. S. Department of Agriculture
FOREST SERVICE

E11

Chippewa NATIONAL FOREST

CORNERS OF THE PUBLIC SURVEY

T. 147N R. 25W 5th Mer.

1/4 Corner common to Sections
9, and 9

Corner consists of a 3" scribed Aspen Post (not) in place

State condition New

Dimensions above ground 90 inches

Sketch grooves, letters, figures, or notches, on proper face or edge.

CARDINAL POSITION

DIAGONAL POSITION

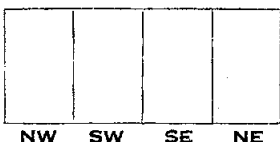
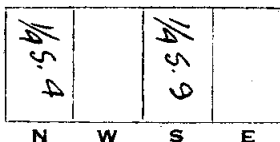

Mound of _____ is located _____

Pits are located _____

Sketch markings of Bearing Trees (or Rocks) in proper box and fill blanks below, giving bearings from Corner to Trees and Distances in Links.

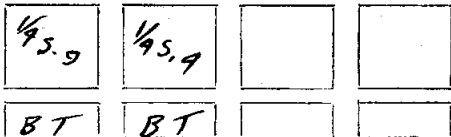

Species J. Pine J. Pine

Diameter 4" 4"

Bearing S20°E N44°W

Distance 21 lks 21 lks

Do you believe this to be a genuine Land Office Corner? No

If not, why? Set by J. H. Bjelke

Arthur J. Johnson

(Signature)

2/27/90
(Date)

Equal Foreman
(Title)

(Make sketch of topography near Corner)

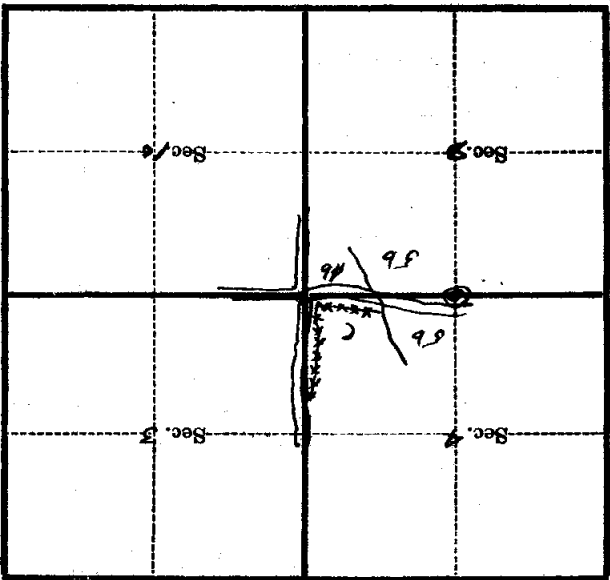

T. 142N R. 25W 5th Mer.

Metal Location Poster is on a

tree _____ inches diameter, on the

side of _____

from which this Corner bears _____

chains distant.

Give any further facts which will aid in finding this

Corner again.

U. S. Department of Agriculture
FOREST SERVICE

E-11

Chippewa NATIONAL FOREST
CORNERS OF THE PUBLIC SURVEY

T. 147N R. 25W 5th Mer.

1/4 Corner common to Sections
9, and 9

Corner consists of a 3" scribed Aspen Post (not) in place
State condition New

Dimensions above ground 70 inches

Sketch grooves, letters, figures, or notches, on proper face or edge.

CARDINAL POSITION

DIAGONAL POSITION

<u>1/4 S 9</u>		<u>1/4 S 9</u>	
N	W	S	E

NW	SW	SE	NE

Mound of _____ is located _____

Pits are located _____

Sketch markings of Bearing Trees (or Rocks) in proper box and fill blanks below, giving bearings from Corner to Trees and Distances in Links.

<u>1/4 S 9</u>	<u>1/4 S 9</u>		
<u>BT</u>	<u>B.T.</u>		

Species J. Pine J. Pine

Diameter 4" 4"

Bearing S 20° E N 99° W

Distance 211k 211k

Do you believe this to be a genuine Land Office Corner? No

If not, why? Set by J. H. Ejelhave

Richard J. Johnson
(Signature)

Special Foreman
(Title)

2/27/40
(Date)

Metal Location Poster is on a tree inches diameter, on the side of from which this Corner bears chains distant. Give any further facts which will aid in finding this Corner again.

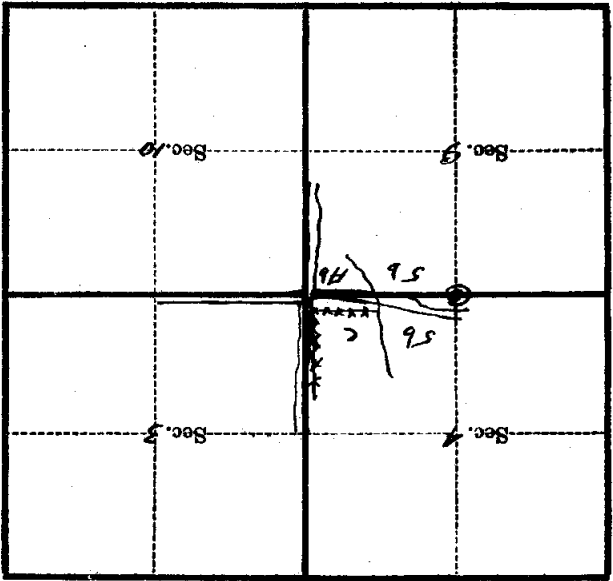

(Make sketch of topography near Corner)

T. 147N R. 25W 5th Mer.