

U. S. Department of Agriculture
FOREST SERVICE

1431
A-17

A-17

NATIONAL FOREST

CORNERS OF THE PUBLIC SURVEY

T. 147N R. 31W 5th Mer.
7 146N 11 31W 5th

Corner common to Sections

(34 - 35), (2), and (3)
7 147 7 146

Corner consists of a stone (not) in place

State condition

Dimensions above ground _____ inches

Sketch grooves, letters, figures, or notches, on proper face or edge.

CARDINAL POSITION

DIAGONAL POSITION

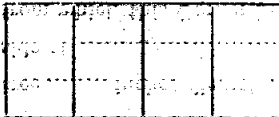

N W S E

NW SW SE NE

Mound of _____ is located _____

Pits are located _____

Sketch markings of Bearing Trees (or Rocks) in proper box and fill blanks below, giving bearings from Corner to Trees and Distances in Links.

Sec 601
Sec 34
T147N
R31W

Sec 601
Sec 34
T146N
R31W



BT

BT



Species Norway pine white Oak

Diameter 13" 8"

Bearing NW S 60° E

Distance .5 ch 1 ch

Do you believe this to be a genuine Land Office Corner? _____

If not, why? _____

John D. Hagen
(Signature)

2/20/34
(Date)

Traverse
(Title)

A-17

1944

U. S. Department of Agriculture
FOREST SERVICE

A-17

NATIONAL FOREST

CORNERS OF THE PUBLIC SURVEY

Corner again.
Chain of markers of rocks
north end with oak from top

Give any further facts which will aid in finding this
chain distant.
from which this Corner bears
side of
tree inches diameter, on the
Metal Location Poster is on a

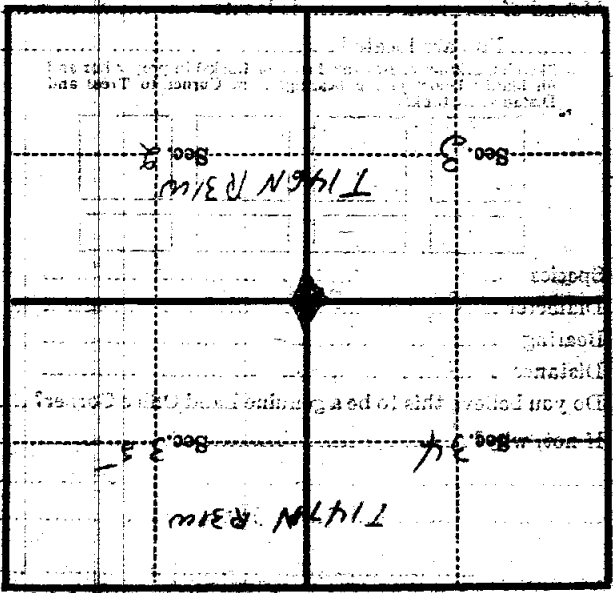

(Make sketch of topography near Corner)

T 147N R 31W
A-17
MGT