

P 7/36

U. S. Department of Agriculture

FOREST SERVICE

E-1 E1

Chippewa

NATIONAL FOREST

CORNERS OF THE PUBLIC SURVEY

T. 146 R. 31-32 5th Mer.

Section Corner common to Sections 6-7, 146-31, 4 1-12, 2nd - 146 - 32

Corner consists of a Y Lll (not) in place

State condition

Dimensions above ground Under ground inches

Sketch grooves, letters, figures, or notches, on proper face or edge.

CARDINAL POSITION

DIAGONAL POSITION

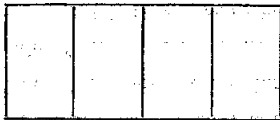

N W S E

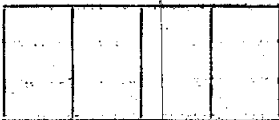

NW SW SE NE

Mound of is located

Pits are located

Sketch markings of Bearing Trees (or Rocks) in proper box and fill blanks below, giving bearings from Corner to Trees and Distances in Links.

T 146  
R-31  
S-7

T 146  
R-32  
S-12

T 146  
R-32  
S-1

T 146  
R-31  
S-6

BT

BT

BT

BT

Species W. Pine B. Ash B. Ash Birch

Diameter 12" 11" 7" 7"

Bearing S 69 E S 7 W N 39 W N 20 E

Distance 1.50 d .50 d

Do you believe this to be a genuine Land Office Corner? Yes

If not, why?

(Signature)

4/10/35 (Date)

(Title)

E-1

COMMISSION OF THE GEOLOGIC SURVEY

Give any further facts which will aid in finding the corner again.

chains distant.

from which this corner bears

side of

tree 7 inches diameter, on the *CA R 13* side of *CA R 13*

Metal Location Poster is on a *Post*

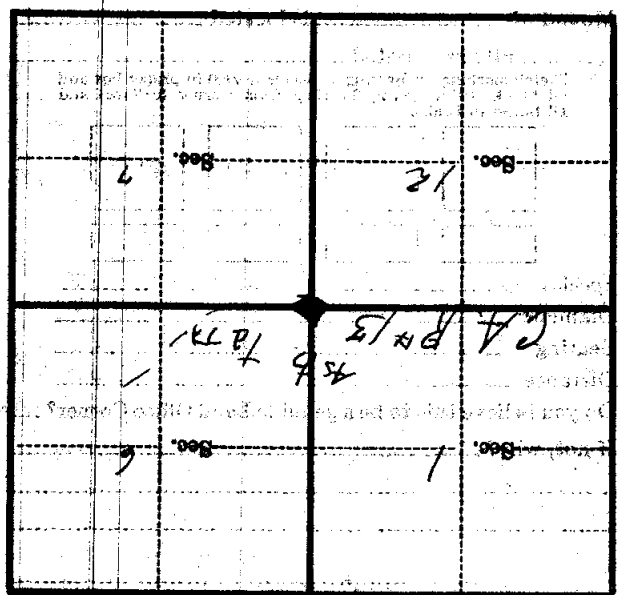

(Make sketch of topography near corner)

U. S. Department of Agriculture  
FOREST SERVICE

E-1 E-1

NATIONAL FOREST

CORNERS OF THE PUBLIC SURVEY

T. 146 R. 31 Mer.

Section Corner common to Sections

7, 6, 146-31 and 12-146-32

Corner consists of a Sto (not) in place

State condition Good

Dimensions above ground Underground inches

Sketch grooves, letters, figures, or notches, on proper face or edge.

CARDINAL POSITION

DIAGONAL POSITION

N	W	S	E

Sec	Sec	Sec	Sec
1	12	7	6
NW	SW	SE	NE

Mound of \_\_\_\_\_ is located \_\_\_\_\_

Pits are located \_\_\_\_\_

Sketch markings of Bearing Trees (or Rocks) in proper box and fill blanks below, giving bearings from Corner to Trees and Distances in Links.

T146  
R-31  
Sec 7

T146  
R32  
Sec 12

T146  
R32  
Sec 1

T146  
R31  
Sec 6

BT

BT

BT

BT

Species W. Pine B. Ash B. Ash Birch

Diameter 12 11 9 7

Bearing S 87° E S 7° W N 99° W N 20° E

Distance 150 ch     50 ch

Do you believe this to be a genuine Land Office Corner? Yes

If not, why? \_\_\_\_\_

Jm. F. Murphy  
(Signature)

4/10/35  
(Date)

E-1 E-1  
(Title)

