

U. S. Department of Agriculture
FOREST SERVICE

Pasted **R-S-9**

Chippewa NATIONAL FOREST

CORNERS OF THE PUBLIC SURVEY

T. 146N. R. 30W 5th Mer.

Meander Corner common to Sections
28, and 29

Corner consists of a Brass Capd Pipe (not) in place
State condition Good

Dimensions above ground 8" inches

Sketch grooves, letters, figures, or notches, on proper face or edge.

CARDINAL POSITION

DIAGONAL POSITION

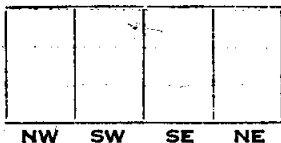
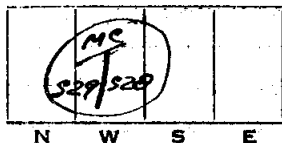

Mound of _____ is located _____

Pits are located _____

Sketch markings of Bearing Trees (or Rocks) in proper box and fill blanks below, giving bearings from Corner to Trees and Distances in Links.

MC S28	MC S.28		
B.T.	B.T.		

Species N. Pine W. Oak

Diameter 2.8" 1.2"

Bearing N. 76° 30' E S. 98° 45' E

100 Distance 258 159

Do you believe this to be a genuine Land Office Corner? Yes

If not, why? _____

J. A. Gjelhaug

(Signature)

Tech. Eng.

(Title)

10/10/39

(Date)

R-S-9

.....
.....
.....
.....
.....
.....
.....
.....
.....
.....

Corner again.

Give any further facts which will aid in finding this
..... chains distant.
..... from which this Corner bears
..... side of
..... tree inches diameter, on the
..... Metal Location Poster is on a

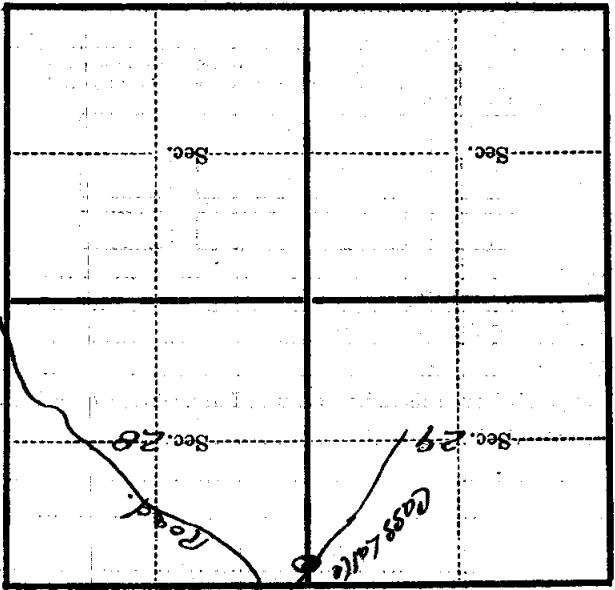

(Make sketch of topography near Corner)