

U. S. Department of Agriculture
FOREST SERVICE

PQ-211
P-Q-21

Chippewa NATIONAL FOREST

CORNERS OF THE PUBLIC SURVEY

T. 146 N R. 30 W 5 th Mer.

Meander Corner common to Sections
23, and 24

Corner consists of a metal cap (cap) in place
State condition good

Dimensions above ground 14 inches
Sketch grooves, letters, figures, or notches, on proper face or edge.

CARDINAL POSITION

DIAGONAL POSITION

	23		24
N	W	S	E

NW	SW	SE	NE

Mound of is located

Pits are located

Sketch markings of Bearing Trees (or Rocks) in proper box and fill blanks below, giving bearings from Corner to Trees and Distances in Links.

T. 146 N
R. 30 W
S. 23

[Empty box for sketch]

MC
S. 24

[Empty box for sketch]

MC

[Empty box for sketch]

BT

[Empty box for sketch]

Species N. Pine N. Pine

Diameter 8" 3 ft.

Bearing S75W S55E

Distance 36 lks 41 lks

Do you believe this to be a genuine Land Office Corner? Yes

If not, why?

Harold Hennes
(Signature)

Jan. 25, 1937
(Date)

(Title)

P-Q-21

1946 N. 20 W. 30 E.

36 37

Corner again.

Give any further facts which will aid in finding this

from which this Corner bears

side of

tree 2 1/2 inches diameter, on the

Metal Location Poster is on a

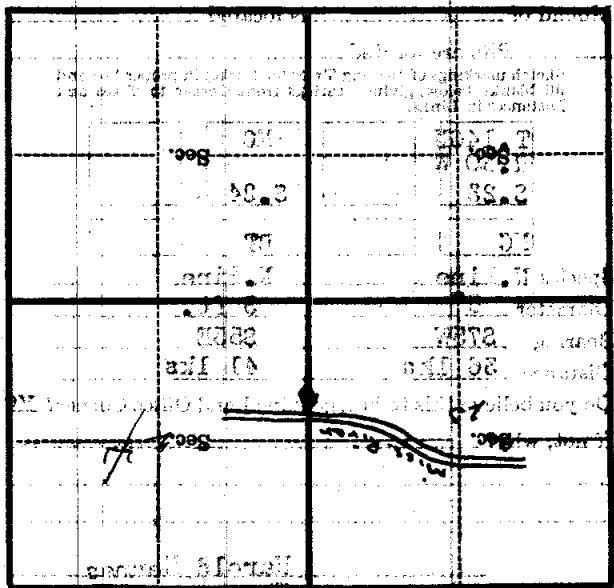

State section of topography near Corner

P.G. 21

U. S. Department of Agriculture

FOREST SERVICE

P-Q-21

Chippewa NATIONAL FOREST

CORNERS OF THE PUBLIC SURVEY

T. 146 N R. 30 W S. 5 th Mer.

Meander Corner common to Sections
 _____, 23, and 24

Corner consists of a metal cap ~~cap~~ in place
 State condition good

Dimensions above ground 14 inches
 Sketch grooves, letters, figures, or notches, on proper face or edge.
 CARDINAL POSITION DIAGONAL POSITION

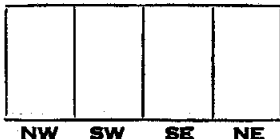
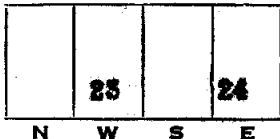

Mound of _____ is located _____

Pits are located _____

Sketch markings of Bearing Trees (or Rocks) in proper box and fill blanks below, giving bearings from Corner to Trees and Distances in Links.

T. 146 N
 R. 30 W
 S. 23



MC
 S. 24



MC



BT



Species N. Pine N. Pine
 Diameter 8" 5 ft.
 Bearing S75W S55E
 Distance 56 lks 41 lks

Do you believe this to be a genuine Land Office Corner? yes

If not, why? _____

Harold Hennes
 (Signature)

Jan. 25, 1937
 (Date)

(Title) P-Q-21

Corner again.

Give any further facts which will aid in finding this

from which this Corner bears

side of

tree inches diameter, on the

Metal Location Poster is on a

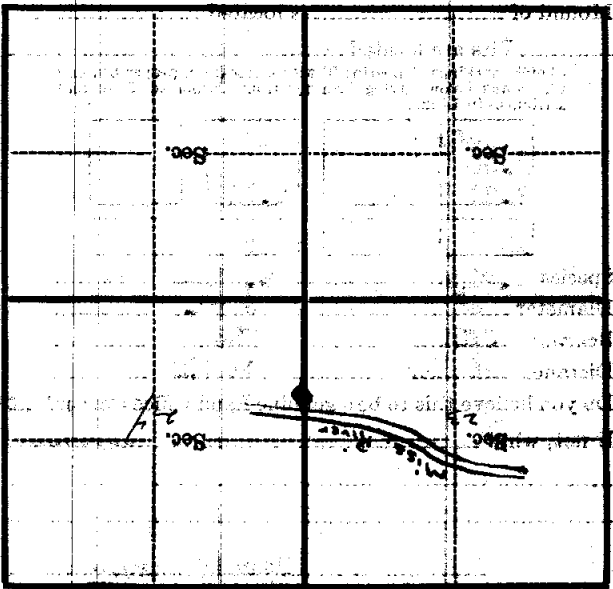

(Make sketch of topography near Corner)