

U. S. Department of Agriculture
FOREST SERVICE

J-23

31

Chippewa NATIONAL FOREST

CORNERS OF THE PUBLIC SURVEY

T. 146 R. 30 Mer.

1/4 Corner common to Sections

12 and 13
Corner consists of a 2 20 (not) in place

State condition

Dimensions above ground 6 inches

Sketch grooves, letters, figures, or notches, on proper face or edge.

CARDINAL POSITION

DIAGONAL POSITION



N W S E



NW SW SE NE

Mound of is located

Pits are located

Sketch markings of Bearing Trees (or Rocks) in proper box and fill blanks below, giving bearings from Corner to Trees and Distances in Links.

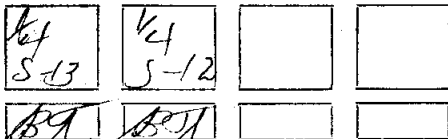

Species E 1/2 E 1/2

Diameter 10" 8"

Bearing S 5 W N 5 W

Distance 15' 18'

Do you believe this to be a genuine Land Office Corner? Yes

If not, why?

Murphy
(Signature)

12/6/34
(Date)

(Title)

J-23

*Corner of
north and south lines
measured 6' west of
corner*

Corner again.

Give any further facts which will aid in finding this

chains distant.

from which this Corner bears

side of

tree inches diameter, on the

Metal Location Poster is on a

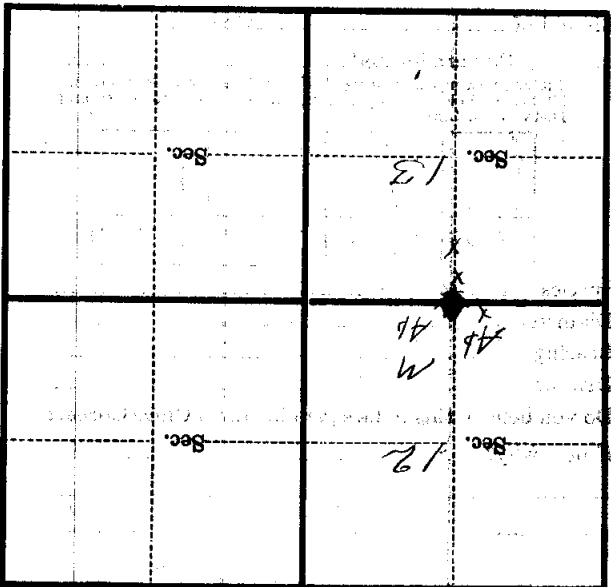

(Make sketch of topography near Corner)

J-23

Mer.

T. 12 N. R. 50 E.

U. S. Department of Agriculture

FOREST SERVICE

J-23

C 61 P 20 W 2 NATIONAL FOREST

CORNERS OF THE PUBLIC SURVEY

T. 146 R. 20 Mer.

quarter (NW) Corner common to Sections
12, and 13Corner consists of a St. 20 (not) in place
State conditionDimensions above ground 6" inches
Sketch grooves, letters, figures, or notches, on proper face or edge.

CARDINAL POSITION

DIAGONAL POSITION

--	--	--	--

N W S E

--	--	--	--

NW SW SE NE

Mound of _____ is located _____

Pits are located _____

Sketch markings of Bearing Trees (or Rocks) in proper box and
fill blanks below, giving bearings from Corner to Trees and
Distances in Links.

<u>1/4</u>
<u>S-13</u>

<u>1/4</u>
<u>S-12</u>

--

--

<u>BT</u>

<u>BT</u>

--

--

Species Elm ElmDiameter 10" 8"Bearing S. 5° W N. 5° WDistance 15' 18'Do you believe this to be a genuine Land Office Corner? Yes

If not, why? _____

M. J. Murphy

(Signature)

12/6/34

(Date)

(Title)

J-23

Metal Location Poster is on a tree inches diameter, on the side of from which this Corner bears chains distant. Give any further facts which will aid in finding this Corner again.

Section 13
Section 12

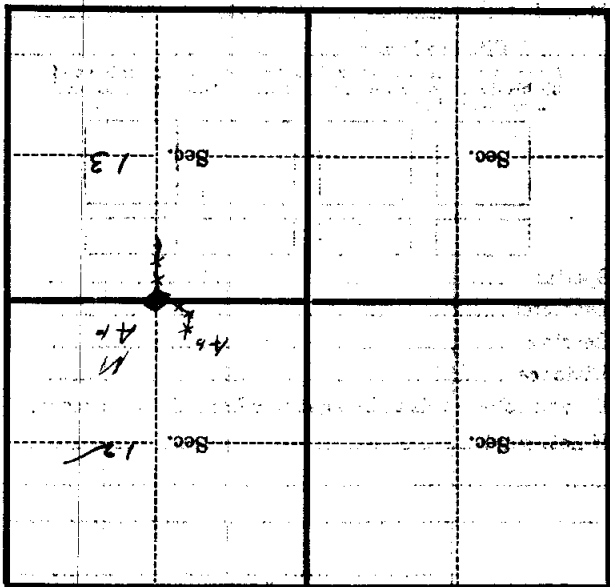

(Make sketch of topography near Corner)