

Form 874-9—Revised May, 1918
U. S. Department of Agriculture
FOREST SERVICE

5-21

~~Chippewa~~ NATIONAL FOREST

CORNERS OF THE PUBLIC SURVEY

T. 146N R. 30 W 5th Mer.
N 1/16

Corner common to Sections
26, and 25

Corner consists of a metal cap (not) in place
State condition good

Dimensions above ground 3 inches

Sketch grooves, letters, figures, or notches, on proper face or edge.

CARDINAL POSITION

DIAGONAL POSITION

	<u>26</u>		<u>25</u>
N	W	S	E

NW	SW	SE	NE

Mound of _____ is located _____

_____ Pits are located _____

Sketch markings of Bearing Trees (or Rocks) in proper box and fill blanks below, giving bearings from Corner to Trees and Distances in Links.

<u>N 1/16</u> <u>S. 26</u>		<u>N 1/16</u> <u>S. 25</u>	
<u>BT</u>		<u>BT</u>	

Species N.P. N.P.

Diameter 12" 14"

Bearing S65W S81E

Distance 31 lks 50 lks

Do you believe this to be a genuine Land Office Corner? _____

If not, why? _____

Harold Homes
(Signature)

Jan. 25, 1937

(Date)

(Title)

5-21

Section 24

CORNER OF THE PLAIN SURVEY

Corner again.

Give any further facts which will aid in finding this

at least 1000 feet distant

from which this Corner bears S 87.5 E

side of Tree

tree 1.8 inches diameter, on the West

Metal Location Poster is on a North Pine

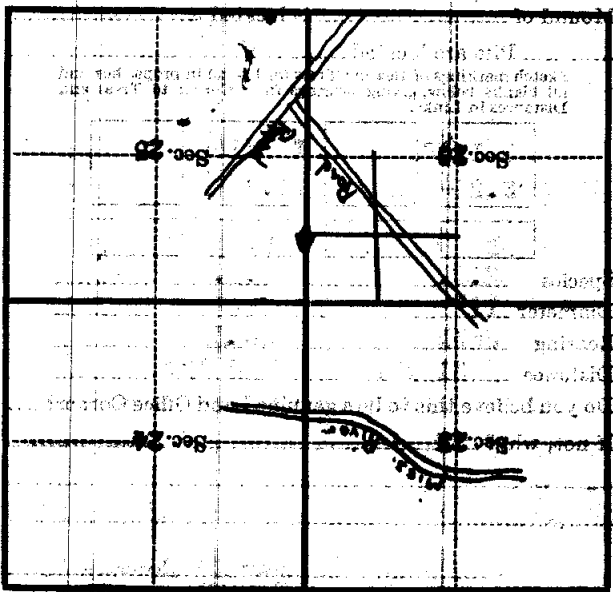

(Scale based on topography near Corner)