

U. S. Department of Agriculture
 FOREST SERVICE

G-17

Chippewa NATIONAL FOREST

CORNERS OF THE PUBLIC SURVEY

T. 146 R. 30 5th Mer.

Corner common to Sections

10, and 11

Corner consists of a 4" Ld Cap (not) in place

State condition Good

Dimensions above ground 6 inches

Sketch grooves, letters, figures, or notches, on proper face or edge.

CARDINAL POSITION

DIAGONAL POSITION

--	--	--	--

N W S E

--	--	--	--

NW SW SE NE

Mound of _____ is located _____

Pits are located _____

Sketch markings of Bearing Trees (or Rocks) in proper box and fill blanks below, giving bearings from Corner to Trees and Distances in Links.

1/4 C S-10	1/4 C S-11		
BT	BT		

Species W. Oak W. Oak

Diameter 8" 7"

Bearing S. W. N. E.

Distance .74 C 4.25 C

Do you believe this to be a genuine Land Office Corner? Yes

If not, why? _____

 (Signature)
 Wang

 (Date)
 4/23/35

(Title)

Corner again.
Give any further facts which will aid in finding this
chains distant.

From which this Corner bears
side of
tree inches diameter, on the
Metal Location Poster is on a

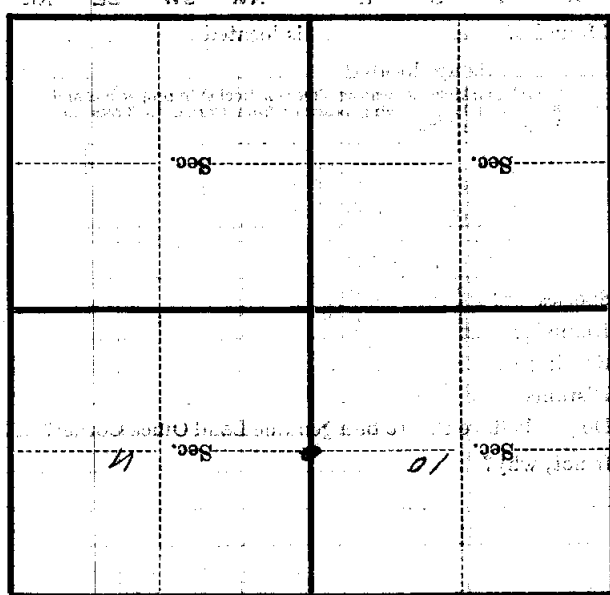

(Make sketch of topography near Corner)

T. 146 R. 30
Mer. 6-17

U. S. Department of Agriculture
FOREST SERVICE

G-17

Chippewa NATIONAL FOREST

CORNERS OF THE PUBLIC SURVEY

T. *146* R. *30* Mer.

$\frac{1}{4}$ Corner common to Sections
10, and *11*

Corner consists of a *Pipe & cap* (~~post~~) in place
State condition *Good*

Dimensions above ground *6* inches
Sketch grooves, letters, figures, or notches, on proper face or edge.

CARDINAL POSITION

DIAGONAL POSITION

--	--	--	--

--	--	--	--

N W S E

NW SW SE NE

Mound of _____ is located _____

Pits are located _____

Sketch markings of Bearing Trees (or Rocks) in proper box and fill blanks below, giving bearings from Corner to Trees and Distances in Links.

<i>1/4 c.</i>	<i>1/4 c.</i>		
<i>S 10</i>	<i>S 11</i>		
<i>BT</i>	<i>BT</i>		

Species *W. oak* *W. oak*

Diameter *8 in.* *7*

Bearing *SW* *N.E.*

Distance *.74 ch* *4.25 ch*

Do you believe this to be a genuine Land Office Corner? *yes*

If not, why? _____

Kenneth W. ...
(Signature)

4'23'95
(Date)

(Title)

G-17

.....

.....

.....

.....

.....

.....

.....

.....

.....

.....

Corner again.

Give any further facts which will aid in finding this
 chains distant.
 from which this Corner bears
 side of
 tree inches diameter, on the
 Metal Location Poster is on a

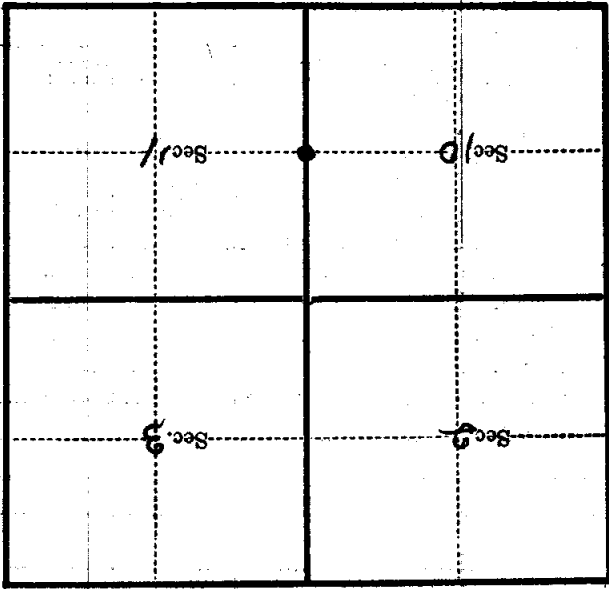

(Make sketch of topography near Corner)