

Form 874-9—Revised May, 1918  
 U. S. Department of Agriculture  
 FOREST SERVICE

U-17  
 U-17

Chippewa NATIONAL FOREST

CORNERS OF THE PUBLIC SURVEY

T. 146 N R. 30W 5th Mer.  
 S 1/16 Corner common to Sections

26, and 27

Corner consists of a metal cap (not) in place

State condition good

Dimensions above ground 3 inches

Sketch grooves, letters, figures, or notches, on proper face or edge.

CARDINAL POSITION

DIAGONAL POSITION

	27		26

N W S E

NW SW SE NE

Mound of \_\_\_\_\_ is located \_\_\_\_\_

\_\_\_\_\_ Pits are located \_\_\_\_\_

Sketch markings of Bearing Trees (or Rocks) in proper box and fill blanks below, giving bearings from Corner to Trees and Distances in Links.

S. 1/16		S. 1/16	
S. 26		S. 27	

B.T.		B.T.	
------	--	------	--

Species J. Pine J. Pine

Diameter 9" 9"

Bearing N26E S41W

Distance 53 lks 2 chs.

Do you believe this to be a genuine Land Office Corner yes

If not, why? \_\_\_\_\_

Harold Hennes

(Signature)

Jan. 22, 1937

(Date)

(Title)

U-17

UNITED STATES DEPARTMENT OF AGRICULTURE

COMMISSION OF THE INTERIOR

Corner again.

Give any further facts which will aid in finding this

chain distant.

from which this corner bears

side of

tree 87 inches diameter, on the

Metal location Peter is on a

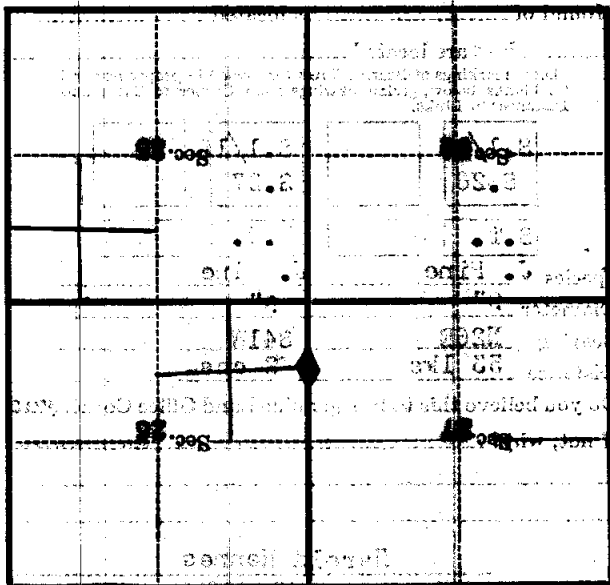

Topography near Corner

U-17

U-11

R. 20 N

T. 12 N

U. S. Department of Agriculture  
FOREST SERVICE

U-17

Chippewa NATIONAL FOREST

CORNERS OF THE PUBLIC SURVEY

T. 146 N R. 30W 5th Mer.  
S 1/16

Corner common to Sections

26, and 27

Corner consists of a metal cap (not) in place

State condition good

Dimensions above ground 8 inches

Sketch grooves, letters, figures, or notches, on proper face or edge.

CARDINAL POSITION

DIAGONAL POSITION

	<u>27</u>	<u>26</u>	
N	W	S	E

NW	SW	SE	NE

Mound of \_\_\_\_\_ is located \_\_\_\_\_

Pits are located \_\_\_\_\_

Sketch markings of Bearing Trees (or Rocks) in proper box and fill blanks below, giving bearings from Corner to Trees and Distances in Links.

S. 1/16  
S. 26

--

S. 1/16  
S. 27

--

B.T.

--

B.T.

--

Species J. Pine

J. Pine

Diameter 9"

9"

Bearing N26E

S41W

Distance 55 lks

2 chs.

Do you believe this to be a genuine Land Office Corner? Yes

If not, why? \_\_\_\_\_

Harold Hennes

Jan. 22, 1937

(Signature)

(Date)

(Title)

U-17

SECTION OF THE PUBLIC SURVEY

CORNER OF THE PUBLIC SURVEY

Corner corner of a

Corner again.

Give any further facts which will aid in finding this

2 CORNER POSITION  
from which this Corner bears

side of Tree  
tree 9 inches diameter, on the

Metal Location Poster is on a

Back Pine

Sec. 25

Sec. 26

Sec. 27

Sec. 28

(Sketch of topography near Corner)

Mer.