

Form 874-9—Revised May, 1918  
U. S. Department of Agriculture  
FOREST SERVICE

J-15

Chippewa NATIONAL FOREST

CORNERS OF THE PUBLIC SURVEY

T. 1216 R. 30 5<sup>th</sup> Mer.

1/4 Corner common to Sections

10, and 15  
Corner consists of a 1/4 (not) in place

State condition Good

Dimensions above ground 6 inches

Sketch grooves, letters, figures, or notches, on proper face or edge.

CARDINAL POSITION

DIAGONAL POSITION

--	--	--	--

N W S E

--	--	--	--

NW SW SE NE

Mound of \_\_\_\_\_ is located \_\_\_\_\_

Pits are located \_\_\_\_\_

Sketch markings of Bearing Trees (or Rocks) in proper box and fill blanks below, giving bearings from Corner to Trees and Distances in Links.

<u>1/4</u> <u>S-15</u>	<u>1/4</u> <u>S-10</u>		
<u>BT</u>	<u>BT</u>		

Species N. Pine Birch

Diameter 6" 6"

Bearing S 18° E N 40° E

Distance 33ch 22ch

Do you believe this to be a genuine Land Office Corner? Yes

If not, why? \_\_\_\_\_

Murphy  
(Signature)

4/24/38  
(Date)

(Title)

J-15

Corner again.

Give any further facts which will aid in finding this chains distant.

from which this Corner bears side of

tree inches diameter, on the

Metal Location Poster is on a

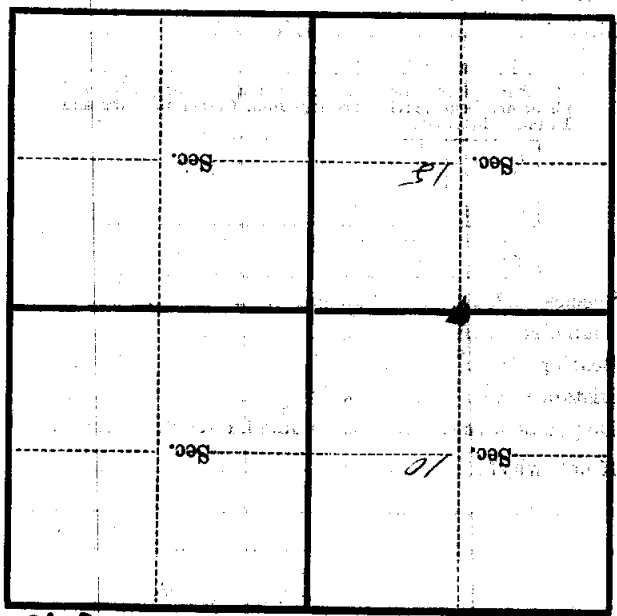

(Make sketch of topography near Corner)

T. 146 R. 50 Mer. J-15

U. S. Department of Agriculture  
FOREST SERVICE

J-15

NATIONAL FOREST

CORNERS OF THE PUBLIC SURVEY

T. 46 R. 30 Mer.

Q 4 Corner common to Sections  
10, and 15

Corner consists of a N 30 (not) in place  
State condition Good

Dimensions above ground 6" inches  
Sketch grooves, letters, figures, or notches, on proper face or edge.

CARDINAL POSITION

DIAGONAL POSITION

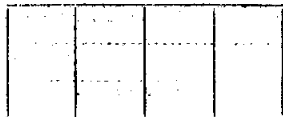

N W S E



NW SW SE NE

Mound of \_\_\_\_\_ is located \_\_\_\_\_

Pits are located \_\_\_\_\_

Sketch markings of Bearing Trees (or Rocks) in proper box and fill blanks below, giving bearings from Corner to Trees and Distances in Links.

C 1/4  
S-15

C 1/4  
S-10

BT

BT

Species N.P. B.L.C.

Diameter 6" 6"

Bearing S-18.E 242.E

Distance 33.0 22.2

Do you believe this to be a genuine Land Office Corner? Yes

If not, why? \_\_\_\_\_

(Signature)

4/24/35  
(Date)

(Title)

J-15

Dotted lines for writing.

*H. S. ...*

Corner again.

Give any further facts which will aid in finding this  
chains distant.  
from which this Corner bears  
side of  
tree inches diameter, on the  
Metal Location Poster is on a

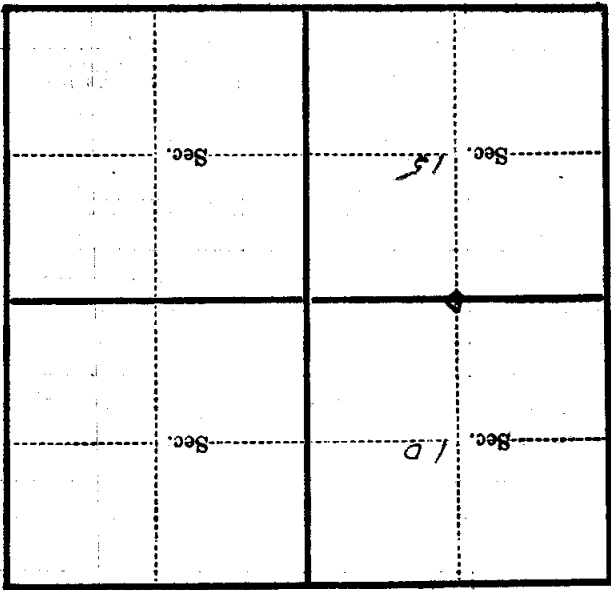

(Make sketch of topography near Corner)