

Form 874-B—Revised May, 1918  
 U. S. Department of Agriculture  
 FOREST SERVICE

H-1

----- NATIONAL FOREST  
**CORNERS OF THE PUBLIC SURVEY**

T. 116 R. 31 Mer.

5 1/2 Corner common to Sections  
 -----, -----, 7, and 11

Corner consists of a ----- (not) in place

State condition -----

Dimensions above ground 12 inches

Sketch grooves, letters, figures, or notches, on proper face or edge.

CARDINAL POSITION

DIAGONAL POSITION

--	--	--	--

N W S E

--	--	--	--

NW SW SE NE

Mound of ----- is located -----

Pits are located -----

Sketch markings of Bearing Trees (or Rocks) in proper box and fill blanks below, giving bearings from Corner to Trees and Distances in Links.

3 1/2	9		
4	1		

Species -----

Diameter 12

Bearing 220

Distance 12

Do you believe this to be a genuine Land Office Corner? 7

If not, why? -----

-----

-----

(Signature)

(Date)

(Title)

H-1

Blank lined area for notes at the top of the page.

Corner again.

Give any further facts which will aid in finding this  
chains distmt.  
from which this Corner bears  
side of  
tree inches diameter, on the  
Metal Location Poster is on a

<p>Sec. 9</p>	<p>Sec. 12</p>
<p>146-31</p>	<p>146-31</p>

(Make sketch of topography near Corner)

U. S. Department of Agriculture  
FOREST SERVICE

36  
H-1

*Chippewa* NATIONAL FOREST

CORNERS OF THE PUBLIC SURVEY

T. 126 R. 30-31 5th Mer.

8 1/4 Corner common to Sections

7, and 12

Corner consists of a 4 1/2 (not) in place

State condition Good

Dimensions above ground 10 inches

Sketch grooves, letters, figures, or notches, on proper face or edge.

CARDINAL POSITION

DIAGONAL POSITION

--	--	--	--

N W S E

--	--	--	--

NW SW SE NE

Mound of \_\_\_\_\_ is located \_\_\_\_\_

Pits are located \_\_\_\_\_

Sketch markings of Bearing Trees (or Rocks) in proper box and fill blanks below, giving bearings from Corner to Trees and Distances in Links.

<u>5 1/4</u>
<u>S-7</u>

<u>5 1/4</u>
<u>S-12</u>

--

--

<u>BT</u>
-----------

<u>BT</u>
-----------

--

--

Species Oak Oak

Diameter 16" 12"

Bearing E N80W

Distance 0.1 ch 0.12 ch

Do you believe this to be a genuine Land Office Corner? Yes

If not, why? \_\_\_\_\_

*J. Murphy*  
(Signature)

7/26/35  
(Date)

(Title) H-1

*[Faint, mostly illegible text on a ruled background]*

Corner again.

Give any further facts which will aid in finding this

chain distant.

From which this Corner bears

side of

tree 6 inches diameter, on the *mark*

Metal Location Poster is on a *Board*

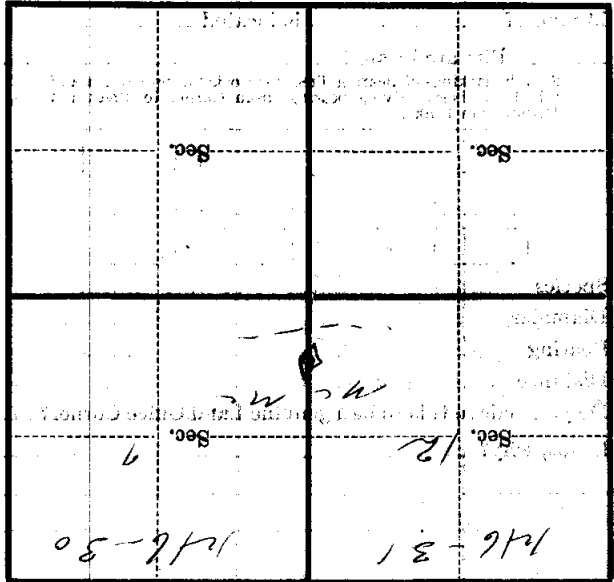

(Make sketch of topography near Corner)

T. H. R. 30-31 Mer. H-1