

U. S. Department of Agriculture
FOREST SERVICE

Chippewa NATIONAL FOREST

CORNERS OF THE PUBLIC SURVEY

T. 146 R. 29 5th Mer.
Meander

Corner common to Sections
19 and 30

Corner consists of a Brass Cap (not) in place
State condition good

Dimensions above ground 2 inches

Sketch grooves, letters, figures, or notches, on proper face or edge.

CARDINAL POSITION

DIAGONAL POSITION

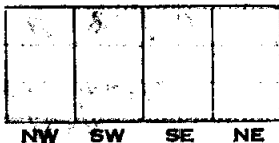
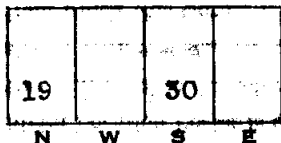

Found of is located

Pits are located

Sketch markings of Bearing Trees (or Rocks) in proper box and fill blanks below, giving bearings from Corner to Trees and Distances in Links.

T. 146N	
R. 29W	
S. 19	

T. 146N	
R. 29W	
S. 30	

M.C.

M.D.

Species Ash J. Pine

Diameter 9" 15"

Bearing N85W S37E

Distance 66 lks 1.84 ch.

Do you believe this to be a genuine Land Office Corner? Yes

If not, why?

Harold Hennes
(Signature)

April 1937
(Date)

(Title)

CORNER
 3.29 ch. East
 Yellow Post on road
 Corner again.

Give any further facts which will aid in finding this
 chains distant.
 From which this Corner bears *N 8.5° W*
 side of *Line*
 tree 2 inches diameter, on the *South*
 Metal Location Poster is on a *Ask*



(Make sketch of topography near Corner)

U. S. Department of Agriculture
FOREST SERVICE

Chippewa NATIONAL FOREST

CORNERS OF THE PUBLIC SURVEY

T. 44 R. 22 Mer.

Monier Corner common to Sections

19, 20, 21 and 30

Corner of 19 and 30

State condition 1954

Dimensions above ground 1 inches

Sketch grooves, letters, figures, or notches on proper face or edge.

CARDINAL POSITION

DIAGONAL POSITION

		<u>1.00</u>	
<u>19</u>	<u>A</u>	<u>30</u>	
N	W	S	E

	<u>R 8 2 A</u>		
	<u>30 30</u>		
NW	SW	SE	NE

Mound of is located

Pits are located

Sketch markings of Bearing Trees (or Rocks) in proper box and fill blanks below, giving bearings from Corner to Trees and Distances in Links.

<u>T. 200</u>	
<u>R. 200</u>	
<u>S. 19</u>	

<u>T. 140</u>	<u>30</u>
<u>R. 200</u>	
<u>S. 30</u>	

M.C.

M.C.

Species Ash 1 Pin

Diameter 9" 12"

Bearing N80W S37E

Distance 66 lbs 1.84 ch.

Do you believe this to be a genuine Land Office Corner? Yes

If not, why? It is

Harold Hennas

(Signature)

April 1957

Yes

Yes

Yes

(Algebra sketch of topography near corner)

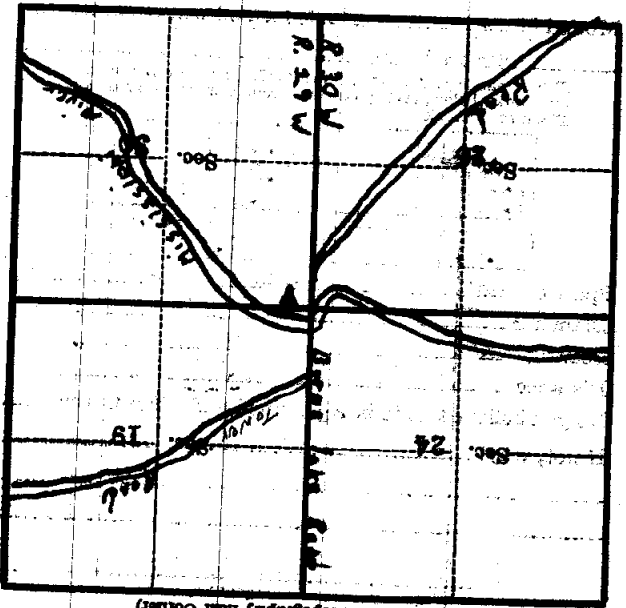

Ant

Metal Location Poster is on a

tree 7 inches diameter, on the

side of Tree

from which this Corner bears

chains distant

Give any further facts which will aid in finding this

Corner again.

Yellow Location post on road 3.24 ch East.