

U. S. Department of Agriculture
FOREST SERVICE

Chippewa NATIONAL FOREST

CORNERS OF THE PUBLIC SURVEY

T. 146 N R. 29W 5th Mer.
Quarter Corner common to Sections

_____, 23, and 26

Corner consists of a Metal Cap (not) in place

State condition good

Dimensions above ground 6 inches

Sketch grooves, letters, figures, or notches, on proper face or edge.

CARDINAL POSITION

DIAGONAL POSITION

23		26	
N	W	S	E

NW	SW	SE	NE

Mound of _____ is located _____

Pits are located _____

Sketch markings of Bearing Trees (or Rocks) in proper box and fill blanks below, giving bearings from Corner to Trees and Distances in Links.

--	--	--	--

No Bearing Trees

Species _____

Diameter _____

Bearing _____

Distance _____

Do you believe this to be a genuine Land Office Corner? Yes

If not, why? _____

Harold Hennes

(Signature)

March 29, 1937

(Date)

(Title)

U.S. GEOLOGICAL SURVEY

Geological Report

Section 26, Township 10 North, Range 10 East

COMMENTS ON THE PUBLIC SURVEY

Section 26, Township 10 North, Range 10 East

Section 26, Township 10 North, Range 10 East

Corner again: 1000

Give any further facts which will aid in finding this

chains distant

111W

from which this Corner bears

side of

tree

7 inch diameter, on the

North

Metal Location Poster is on a

111W

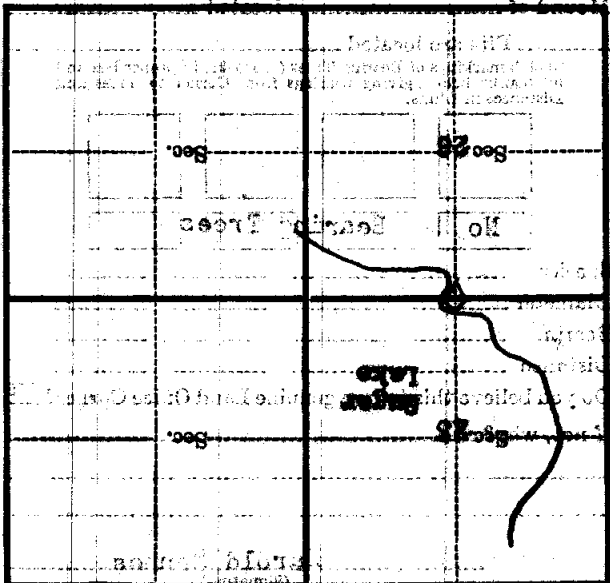

(Approximate location of topography near Corner)