

U. S. DEPARTMENT OF AGRICULTURE

FOREST SERVICE

pro test

Chippewa NATIONAL FOREST

CORNERS OF THE PUBLIC SURVEY

T. *146 N* R. *29 W* *5* Mer.

1/4 Corner common to Sections

33, 34, and

Corner consists of a *not found* (not) in place

State condition

Dimensions above ground _____ inches.

Sketch grooves, letters, figures, or notches, on proper face or edge.

CARDINAL POSITION

DIAGONAL POSITION

--	--	--	--

--	--	--	--

N W S E

NW SW SE NE

Mound of _____ is located _____

Pits are located _____

Sketch markings of Bearing Trees (or Rocks) in proper box and fill blanks below, giving bearings from Corner to Trees and Distances in Links.

<i>1/4 S</i>			
--------------	--	--	--

--

--

--

<i>137</i>			
------------	--	--	--

--

--

--

Species *SPINE*

Diameter *16*

Bearing _____

Distance _____

Do you believe this to be a genuine Land Office Corner? *Yes*

If not, why? _____

Q. R. Brewer

Signature.

Estimator

Title.

1/19/21

Date.

(Make sketch of topography near Corner.)

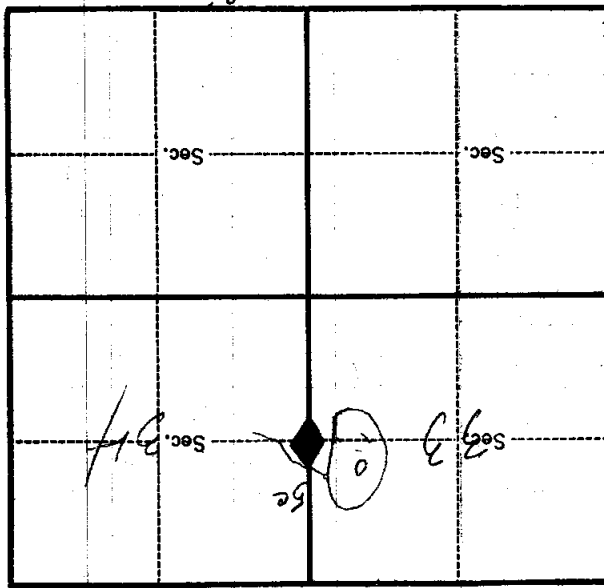

Metal Location Poster is on a

1/8 mi

8 inches diameter, on the

NW

side of

BT

from which this Corner bears

N55W

chains distant.

Give any further facts which will aid in finding this

Corner again

*On edge of grassy lot
and back of lot type.*

T. Mon R. (qu) 5 Mer.