

Form 874-9—Revised May, 1918  
U. S. Department of Agriculture  
FOREST SERVICE

Chippewa NATIONAL FOREST

CORNERS OF THE PUBLIC SURVEY

T. 146N R. 29W 5th Mer.  
Quarter

Corner common to Sections  
17, and 20

Corner consists of a metal cap in place  
State condition good

Dimensions above ground 4 inches  
Sketch grooves, letters, figures, or notches, on proper face or edge.  
CARDINAL POSITION DIAGONAL POSITION

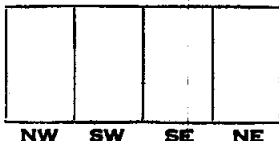
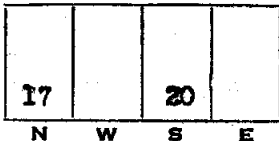

Mound of is located

Pits are located

Sketch markings of Bearing Trees (or Rocks) in proper box and fill blanks below, giving bearings from Corner to Trees and Distances in Links.

1/4	
S. 17	

1/4	
S. 20	

B.T.	
------	--

--	--

B.T.	
------	--

--	--

Species Ash W. Birch

Diameter 12" 12"

Bearing N39E S62E

Distance 9 1/2 lks 21 lks

Do you believe this to be a genuine Land Office Corner? yes

If not, why?

Harold Hennes

(Signature)

March 23, 1937

(Date)

(Title)

SECTION 17  
 T. 148 N. R. 28 E.  
 S. 20  
 S. 17  
 S. 14  
 S. 11  
 S. 8  
 S. 5  
 S. 2  
 S. 1

Metal Location Poster is on a  
 tree inches diameter, on the  
 side of  
 from which this Corner bears  
 chains distant  
 Corner again.

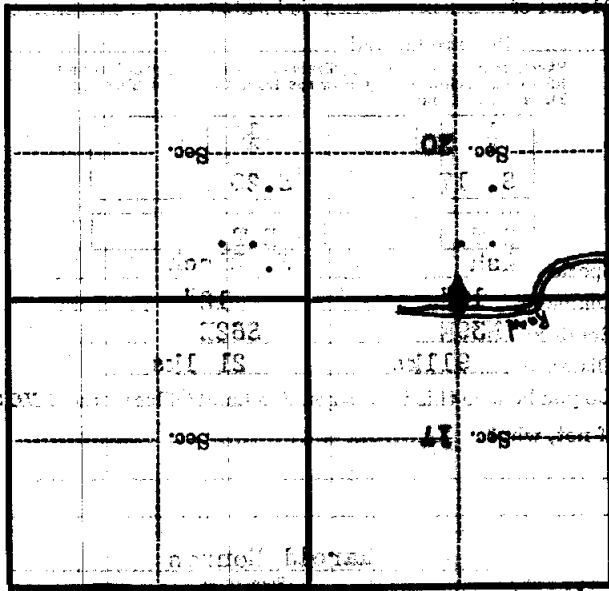

(Make sketch of topography near Corner)

Form 874-B—Revised May, 1918  
U. S. Department of Agriculture  
FOREST SERVICE

N-7

Chippewa NATIONAL FOREST

CORNERS OF THE PUBLIC SURVEY

T. 146N R. 29W 5th P. Mer.

114 Corner common to Sections

17, and 20

Corner consists of a Brass cap on pipe (not) in place

State condition Good

Dimensions above ground 7' inches

Sketch grooves, letters, figures, or notches, on proper face or edge.

CARDINAL POSITION

DIAGONAL POSITION

S17 1/4 S20			
-------------------	--	--	--

N W S E

--	--	--	--

NW SW SE NE

Mound of \_\_\_\_\_ is located \_\_\_\_\_

\_\_\_\_\_ Pits are located \_\_\_\_\_

Sketch markings of Bearing Trees (or Rocks) in proper box and fill blanks below, giving bearings from Corner to Trees and Distances in Links.

1/4 cor. S17/S20			1/4 cor. S17/S20
BT			BT

Species Oak Birch

Diameter 7" 9"

Bearing S60E N71°W

Distance .22 chs. .40 chs.

Do you believe this to be a genuine Land Office Corner? Yes

If not, why? \_\_\_\_\_

Paul Moeller

(Signature)  
Forest Ranger P-1

4/29/38  
(Date)

(Title)

Faded text on lined paper, possibly a title or header.

Corner again. Give any further facts which will aid in finding this

chain distant. 27 from which this Corner bears

513° E

side of tree 9 inches diameter, on the

Aspen

Metal Location Poster is on a

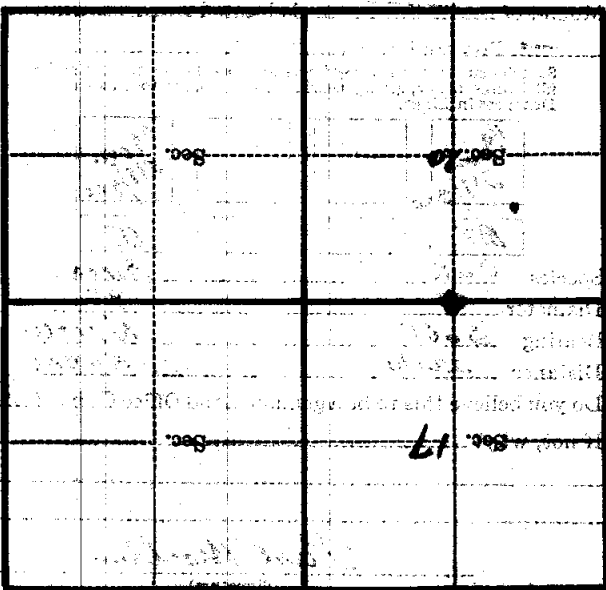

(Make sketch of topography near Corner)

U. S. Department of Agriculture  
FOREST SERVICE

Chippawa NATIONAL FOREST

CORNERS OF THE PUBLIC SURVEY

T. 146N R. 29W 5th Mer.

Quarter Corner common to Sections

17, and 20

Corner consists of a metal cap ~~(cap)~~ in place

State condition good

Dimensions above ground 4 inches

Sketch grooves, letters, figures, or notches, on proper face or edge.

CARDINAL POSITION

DIAGONAL POSITION

17		20	
N	W	S	E

NW	SW	SE	NE

Mound of \_\_\_\_\_ is located \_\_\_\_\_

Pits are located \_\_\_\_\_

Sketch markings of Bearing Trees (or Rocks) in proper box and fill blanks below, giving bearings from Corner to Trees and Distances in Links.

$\frac{1}{4}$		$\frac{1}{2}$	
S. 17		S. 20	

B.T.		B.T.	
------	--	------	--

Species Ash W. Birch

Diameter 12" 12"

Bearing N39E S62E

Distance 21lks 21 lks

Do you believe this to be a genuine Land Office Corner? yes

If not, why? \_\_\_\_\_

\_\_\_\_\_  
\_\_\_\_\_

Harold Hennes

(Signature)

March 23, 1937

(Date)

(Title)

Corner again.

Metal Location Poster is on a tree inches diameter, on the side of from which this Corner bears chains distant. Give any further facts which will aid in finding this

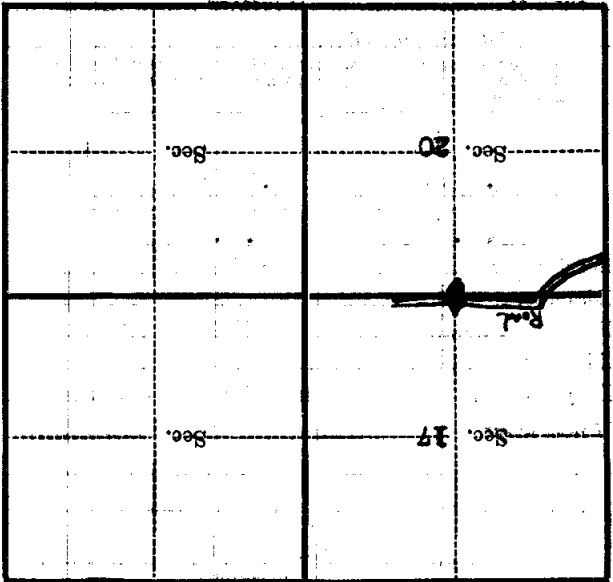

(Make sketch of topography near Corner)