

U. S. Department of Agriculture  
FOREST SERVICE

Chippewa NATIONAL FOREST

CORNERS OF THE PUBLIC SURVEY

T. 146N R. 29W 5th Mer.

CN 1/16 Corner common to Sections  
32, \_\_\_\_\_, and \_\_\_\_\_

Corner consists of a Brass Cap (see) in place

State condition good

Dimensions above ground 6 inches

Sketch grooves, letters, figures, or notches, on proper face or edge.

CARDINAL POSITION

DIAGONAL POSITION

<u>32</u>	<u>32</u>	<u>32</u>	<u>32</u>
-----------	-----------	-----------	-----------

--	--	--	--

N W S E

NW SW SE NE

Mound of \_\_\_\_\_ is located \_\_\_\_\_

Pits are located \_\_\_\_\_

Sketch markings of Bearing Trees (or Rocks) in proper box and fill blanks below, giving bearings from Corner to Trees and Distances in Links.

<u>CN 1/16</u>	
<u>S. 32</u>	

<u>CN 1/16</u>	
<u>S. 32</u>	

<u>B.T.</u>	
-------------	--

<u>B.T.</u>	
-------------	--

Species J. Pine J. Pine

Diameter 4.5" 4.5"

Bearing N39W N47E

Distance 52 lks 35 lks

Do you believe this to be a genuine Land Office Corner? yes

If not, why? \_\_\_\_\_

Harold Hendon

(Signature)

Apr. 8, 1937

(Date)

(Title)

CORNER OF THE SECTION

Ferron's staff 24. E.

Corner again.

Give any further facts which will aid in finding this

0.25 chains distant

from which this Corner bears N 47° E

side of Tree

tree 4.5 inches diameter, on the SW

Metal Location Poster is on a

J.P.

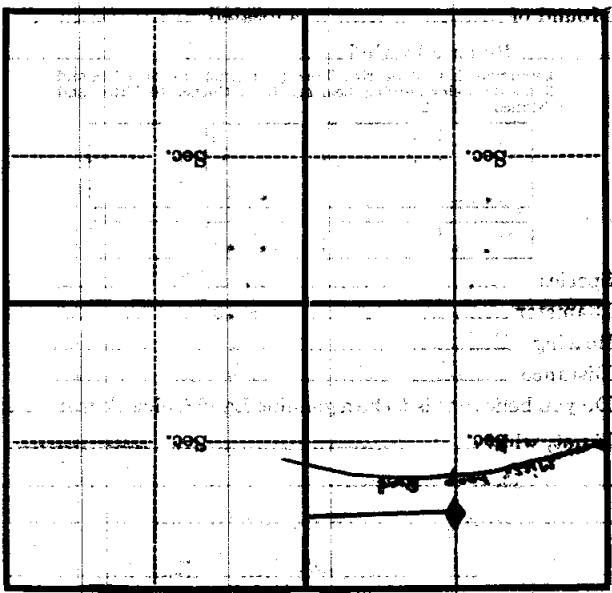

(Make sketch of topography near Corner)

W-7 Mer.

R.

T.

W-7

Form 874-9—Revised May, 1918

U. S. Department of Agriculture  
FOREST SERVICE

Chippewa NATIONAL FOREST

CORNERS OF THE PUBLIC SURVEY

T. 146N R. 29W 5th Mer.

5 1/16 Corner common to Sections

32, , , and

Corner consists of a Brass Cap (rock) in place

State condition good

Dimensions above ground 6 inches

Sketch grooves, letters, figures, or notches, on proper face or edge.

CARDINAL POSITION

DIAGONAL POSITION

32	32	32	32
N	W	S	E

NW	SW	SE	NE

Mound of is located

Pits are located

Sketch markings of Bearing Trees (or Rocks) in proper box and fill blanks below, giving bearings from Corner to Trees and Distances in Links.

CN 1/16	
S. 32	

CN 1/16	
S. 32	

B.T.	
------	--

B.T.	
------	--

Species J. Pine J. Pine

Diameter 4.5" 4.5"

Bearing N89W N47E

Distance 52 lks 35 lks

Do you believe this to be a genuine Land Office Corner? yes

If not, why?

Harold Hennes  
(Signature)

Apr. 5, 1937  
(Date)

(Title)

W-7

... ..  
... ..  
... ..  
... ..  
... ..  
... ..

Corner again. Look

Give any further facts which will aid in finding this  
chains distant.

from which this Corner bears  $N 47^{\circ} E$

tree  $1\frac{1}{2}$  inches diameter, on the  $SW$  side of

Metal Location Poster is on a  $1\frac{1}{2}$

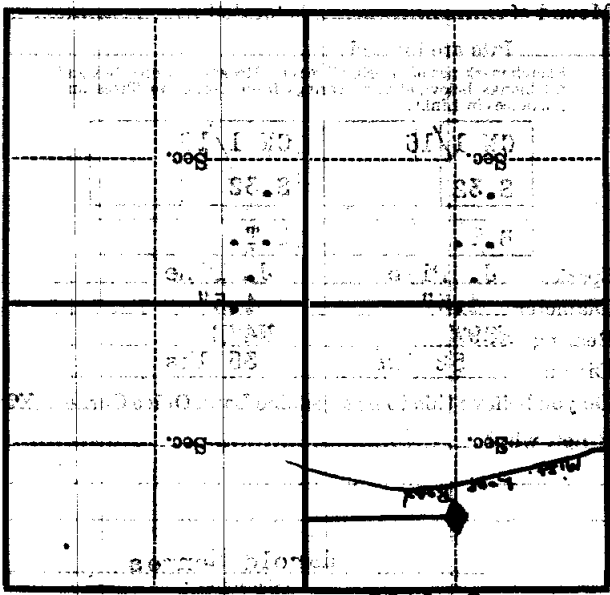

Fig. 1. (Showing location of topography near Corner)