

U. S. Department of Agriculture
FOREST SERVICE

E-5 Copied Postal 5/36

..... NATIONAL FOREST

CORNERS OF THE PUBLIC SURVEY

T. 146 R. 29 S. 5 Mer.

..... Corner common to Sections

5, 6,, and

Corner consists of a tan. stake in marsh in place

State condition

Dimensions above ground, inches

Sketch grooves, letters, figures, or notches, on proper face or edge.

CARDINAL POSITION

DIAGONAL POSITION

--	--	--	--

--	--	--	--

N W S E

NW SW SE NE

Mound of is located

Pits are located

Sketch markings of Bearing Trees (or Rocks) in proper box and fill blanks below, giving bearings from Corner to Trees and Distances in Links.

Species

Diameter

Bearing

Distance

Do you believe this to be a genuine Land Office Corner?

If not, why?

.....

.....

(Signature)

(Date)

(Title)

E-5

Corner again.
 5" dead & gn. bears N E 50 ft
 4" gn m. stub bears N scribbled 29 W S 6

Give any further facts which will aid in finding this
 exact distance
 from which this Corner bears
 side of
 tree inches diameter, on the
 Metal Location Poster is on a

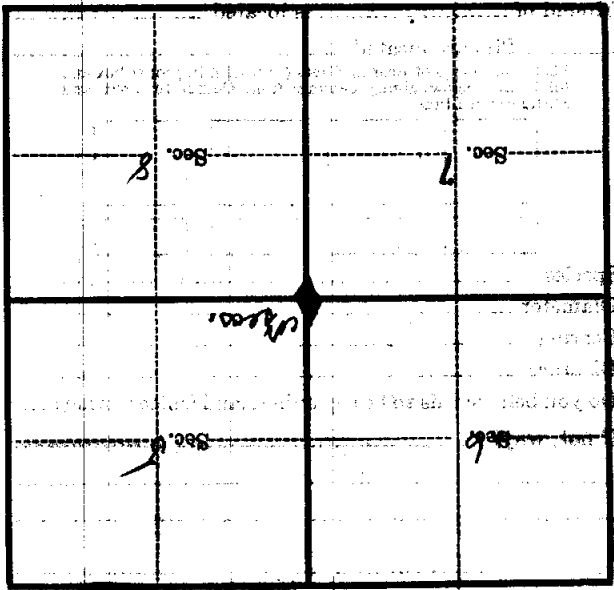

(Make sketch of topography near Corner)

U. S. Department of Agriculture
FOREST SERVICE

62
map

Chippewa NATIONAL FOREST

CORNERS OF THE PUBLIC SURVEY

T. 146 N. R. 29 W. 5th P. Mer.

Section Corner common to Sections
5, 6, 7, and 8

Corner consists of a stone post (not) in place
State condition good

Dimensions above ground 30 inches.

Sketch grooves, letters, figures, or notches, on proper face or edge.

CARDINAL POSITION

DIAGONAL POSITION

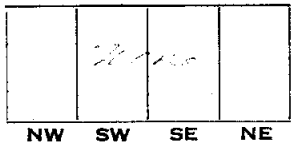
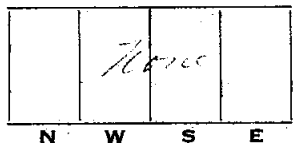

Mound of ✓ is located ✓

Pits are located ✓

Sketch markings of Bearing Trees (or Rocks) in proper box and fill blanks below, giving bearings from Corner to Trees and Distances in Links.

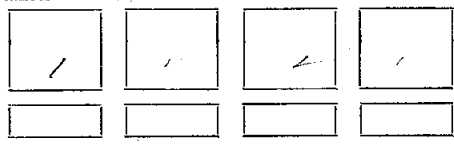

Species -----

Diameter -----

Bearing -----

Distance -----

Do you believe this to be a genuine Land Office Corner? ✓

If not, why? No. B.T. in evidence

Wm. J. Kelly
(Signature)

Jan. 13, 1922
(Date)

Assistant
(Title)

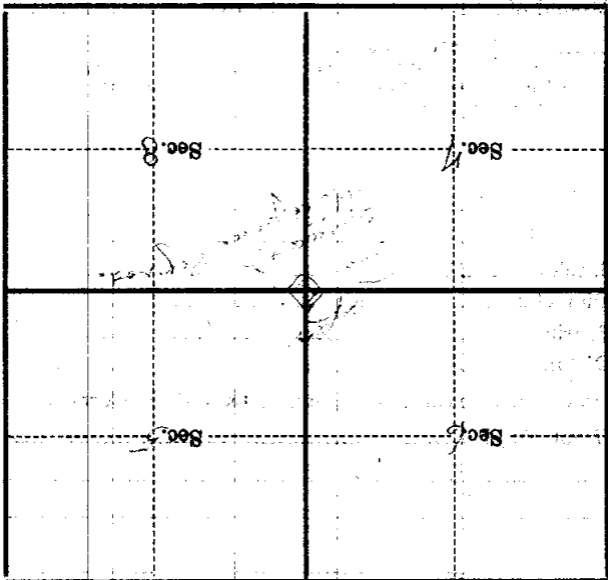

(Make sketch of topography near Corner)

T. 146 N. R. 29 W. 5TH Mer.

E.S. Mer.

Metal Location Poster is on a tree inches diameter, on the side of from which this Corner bears chains distant.

Give any further facts which will aid in finding this Corner again.

2 1/2 x 2 1/2 " by word 'Corner' 'Post' on
 Metal Location Poster is on a tree
 inches diameter, on the side of
 from which this Corner bears
 chains distant.

Give any further facts which will aid in finding this
 Corner again.

Section 4
 Section 8
 Section 6
 Section 2