

U. S. Department of Agriculture  
FOREST SERVICE

R-5 Copies  
Posted  
5/36

----- NATIONAL FOREST

CORNERS OF THE PUBLIC SURVEY

T. 146 ----- R. 29 ----- 5 ----- Mer.

----- Corner common to Sections

-----, 19, -----, 20, ----- and -----

Corner consists of ~~old corner~~ ----- (not) in place

State condition -----

Dimensions above ground ----- inches

Sketch grooves, letters, figures, or notches, on proper face or edge.

CARDINAL POSITION

DIAGONAL POSITION

--	--	--	--

--	--	--	--

N W S E

NW SW SE NE

Mound of ----- is located -----

----- Pits are located -----

Sketch markings of Bearing Trees (or Rocks) in proper box and fill blanks below, giving bearings from Corner to Trees and Distances in Links.

Species -----

Diameter -----

Bearing -----

Distance -----

Do you believe this to be a genuine Land Office Corner? -----

If not, why? -----

-----

-----

(Signature)

(Date)

(Title)

R-5

two Tan. Laying down 15.0 ft from corner.  
Corner again.

Give any further facts which will aid in finding this  
chain distant.  
from which this Corner bears  
side of  
tree inches diameter, on the  
Metal Location Poster is on a

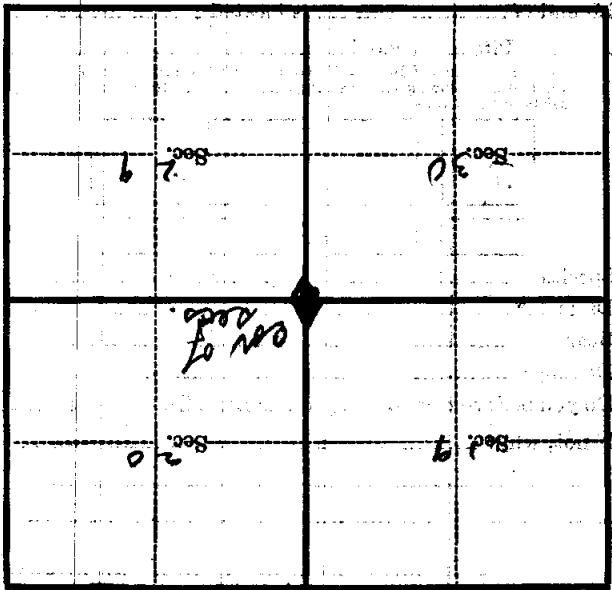

(Make sketch of topography near Corner)

8-5  
M.G.P.

T  
R

U. S. Department of Agriculture  
FOREST SERVICE

R-5 Copied +  
Posted  
5/36

NATIONAL FOREST

CORNERS OF THE PUBLIC SURVEY

T. 146 R. 29 5 Mer.

19 20 29 30 Corner common to Sections  
and

Corner consists of a **new corner** (not) in place

State condition

Dimensions above ground inches

Sketch grooves, letters, figures, or notches, on proper face or edge.

CARDINAL POSITION

DIAGONAL POSITION

--	--	--	--

--	--	--	--

N W S E

NW SW SE NE

Mound of is located

Pits are located

Sketch markings of Bearing Trees (or Rocks) in proper box and fill blanks below, giving bearings from Corner to Trees and Distances in Links.

Species

Diameter

Bearing

Distance

Do you believe this to be a genuine Land Office Corner? ....

If not, why? .....

.....

.....

(Signature)

(Date)

(Title)

R-5

One small cedar for sec 29

Corner again.

Give any further facts which will aid in finding this

chains distant.

from which this Corner bears

side of

tree inches diameter, on the

Metal Location Poster is on a

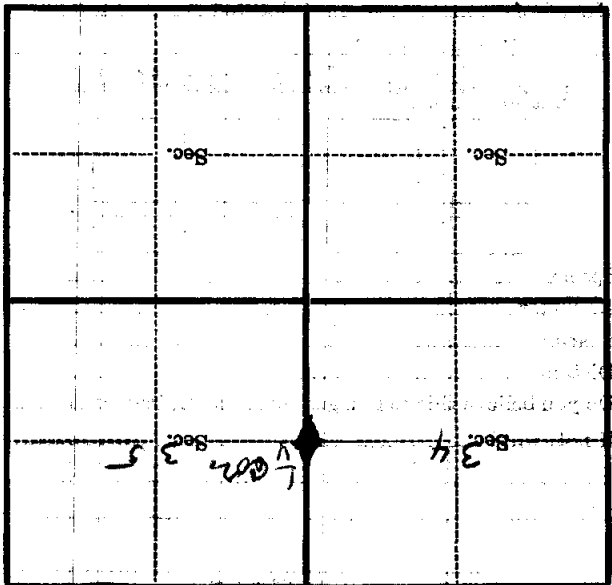

(Make sketch of topography near Corner)