

U. S. DEPARTMENT OF AGRICULTURE

FOREST SERVICE

N-5

Chippewa NATIONAL FOREST

CORNERS OF THE PUBLIC SURVEY

T. 145 N. R. P. 6 W. 5th Mer.

Section 17 Corner common to Sections

17, 18, 19, and 20

Corner consists of a squared stake in place

State condition Good

Dimensions above ground 2x2x30 inches.

Sketch grooves, letters, figures, or notches, on proper face or edge.

CARDINAL POSITION

DIAGONAL POSITION

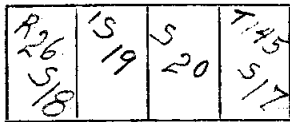
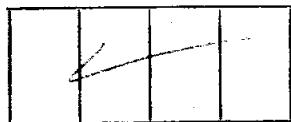
Mound of K is located ✓Pits are located ✓

Sketch markings of Bearing Trees (or Rocks) in proper box and fill blanks below, giving bearings from Corner to Trees and Distances in Links.

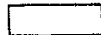
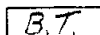
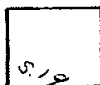
Species N. Pine N. PineDiameter 32" 28"Bearing S 45 W S 78 EDistance 35 lks 45 lksDo you believe this to be a genuine Land Office Corner? yes

If not, why? _____

Edward Jensen
Signature.

Date. 9-11-29 EstimatorTitle. N-5 8-3027

(Make sketch of topography near Corner.) N-5

T 145 N R 26 W S 4 Mer.

	18	19	
	17	20	

Metal Location Poster is on a Norway Pine tree 32 inches diameter, on the side of ~~corner~~ from which this Corner bears N 45° E chains distant. Give any further facts which will aid in finding this Corner again.

U. S. Department of Agriculture
FOREST SERVICE

N-5

Chippewa NATIONAL FOREST

CORNERS OF THE PUBLIC SURVEY

T. 146N R. 26W 5th Mer.

Corner common to Sections 17, 18, 19, and 20

Corner consists of a Tan. - stake in place

State condition Good - sound

Dimensions above ground In reed bed - 3' below soil

Sketch grooves, letters, figures, or notches, on proper face or edge.

CARDINAL POSITION

DIAGONAL POSITION

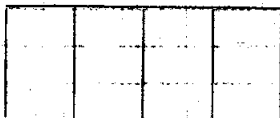
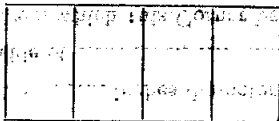

N W S E

NW SW SE NE

Mound of is located

Pits are located

Sketch markings of Bearing Trees (or Rocks) in proper box and fill blanks below, giving bearings from Corner to Trees and Distances in Links.

T. 146
R. 26
Sec. 18

T. 146
R. 26
Sec. 19

T. 146
R. 26
Sec. 17

T. 146
R. 26
Sec. 20

Post
Witness

Post
Witness

B.T.

B.T.

Species	Tan.	Tan.	Tan.	Tan.
Diameter	5" Post	4" Post	5" stub	4" stub
Bearing	N34°W	S31°W	N45°E	S46°30'E
Distance	62Lks	64Lks	100Lks	81Lks

Do you believe this to be a genuine Land Office Corner?

If not, why? No - Reestablished corner perhaps by County Surveyor.

Cause - building of road bed.

Merrill Balke

June 23, 1950

(Date)

(Title)

69

Metal Location Poster is on a
 tree inches diameter, on the
 side of
 from which this Corner bears
 chains distant
 Give any further facts which will aid in finding the
 Corner again.
 Set stakes, marking corner 320 lks.
 NO. (1/2 m-squared) from true corner
 set in Road bed - 8 inches below road
 bed.

<p>Sec. 20</p>	<p>Sec. 19</p>	<p>Sec. 18</p>
<p>Sec. 17</p>	<p>Sec. 16</p>	<p>Sec. 15</p>

Plate sketch of topography near Corner

U. S. Department of Agriculture
FOREST SERVICE

W-5

Chippewa NATIONAL FOREST

CORNERS OF THE PUBLIC SURVEY

T. 146 N. R. 26 W. 5th Mer.

Corner common to Sections

17, 18, 19, and 20

Corner consists of a Tan - 2 1/2" dia in place

State condition Good - Sound

Dimensions above ground 12" dia - 3" dia inches

Sketch grooves, letters, figures, or notches, on proper face or edge.

CARDINAL POSITION

DIAGONAL POSITION

N W S E

NW SW SE NE

Mound of is located

Pits are located

Sketch markings of Bearing Trees (or Rocks) in proper box and fill blanks below, giving bearings from Corner to Trees and Distances in Links.

T146
T26
3-18

T146
T26
3-19

T146
T26
3-17

T146
T26
3-20

Test
Witness

Test
Witness

BT

BT

Species Tan Tan Tan Tan

Diameter 5" dia 4" dia 4" dia 4" dia

Bearing N-77°W S-21°W N-46°E S-46°E

Distance 62 LLs 64 LLs 106 LLs 21 LLs

Do you believe this to be a genuine Land Office Corner?

If not, why? No - Re-established corner

perhaps - by Candy Saracoy

cause - Building of Trial Bed

Morris Balke

June 29 1936

(This)

W-5-69

UNITED STATES FOREST SERVICE

FOREST SERVICE

SECTIONAL FOREST

CORNER OF THE PUBLIC CORNER

Good

N-10 - Stan - squared 1/2 in. - 1/2 in. - 1/2 in.
No. 1 - Good Bill for 3/4 in. - 1/2 in. - 1/2 in.

Corner again.

Give any further facts which will aid in finding this

chains distant.

from which this Corner bears

side of

tree inches diameter, on the

Metal Location Poster is on a

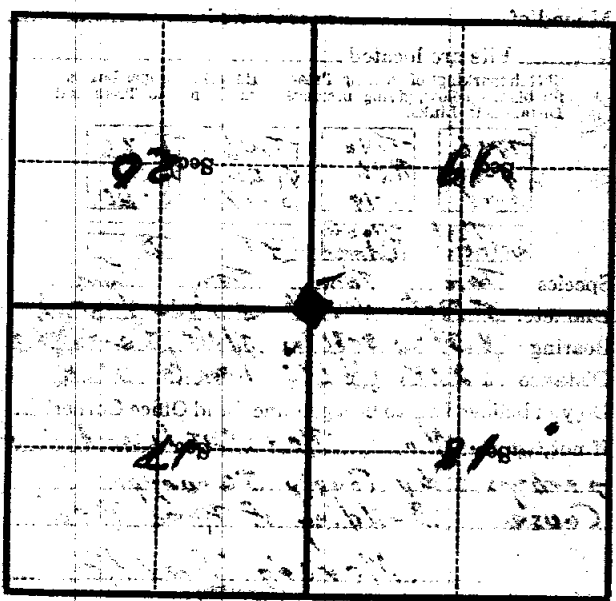

(Map sketch of topography near Corner)

Mer.

T. M. N. R. 86