

U. S. Department of Agriculture
FOREST SERVICE

E-1

Chippewa NATIONAL FOREST

CORNERS OF THE PUBLIC SURVEY

T. 146 R. 26 5th Mer.

Section Corner common to Sections

1, 12, 6, and 7

Corner consists of a wood post (not) in place

State condition good

Dimensions above ground 4" x 4" x 20" inches

Sketch grooves, letters, figures, or notches, on proper face or edge.

CARDINAL POSITION

DIAGONAL POSITION

N	W	S	E

Sec 146 R. 26	Sec 12	Sec 6	Sec 7
NW	SW	SE	NE

Mound of _____ is located _____

Pits are located _____

Sketch markings of Bearing Trees (or Rocks) in proper box and fill blanks below, giving bearings from Corner to Trees and Distances in Links.

<u>S 146 R. 26</u>			
<u>BT</u>			

Species Aspen

Diameter 12"

Bearing N 26° W

Distance 43

Do you believe this to be a genuine Land Office Corner? yes

If not, why? _____

Walter Habala
(Signature)

10/10/35
(Date)

Forester
(Title)

COMPILED BY THE PUBLIC SURVEY

Old Logging Road in N.S.E. of Pt.

Corner again
(1) Give any further facts which will aid in finding this
chain's distant
from which this Corner bears
side of
tree inches diameter, on the
Metal Location Poster is on *the B.A.*

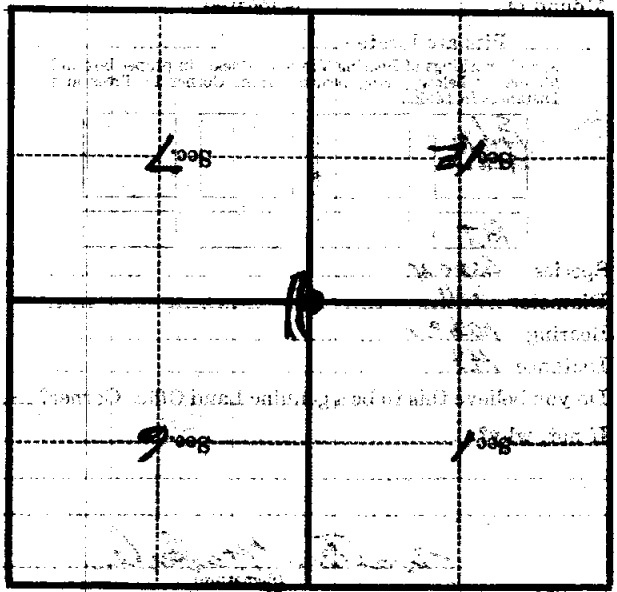

(Make sketch of topography near Corner)