

U. S. Department of Agriculture

FOREST SERVICE

N13

Posted

Chippewa NATIONAL FOREST

CORNERS OF THE PUBLIC SURVEY

T. 145N R. 31W 5th Mer.

Section 2 Corner common to Sections 15, 16, 21, and 22

Corner consists of a (not) in place

State condition

Dimensions above ground 11.96 inches

Sketch grooves, letters, figures, or notches, on proper face or edge.

CARDINAL POSITION

DIAGONAL POSITION

--	--	--	--

N W S E

--	--	--	--

NW SW SE NE

Mound of is located

Pits are located

Sketch markings of Bearing Trees (or Rocks) in proper box and fill blanks below, giving bearings from Corner to Trees and Distances in Links.

Species N. Pine N. Pine N. Pine N. Pine

Diameter 16 20 22 20

Bearing N 55 1/2 W N 33 E S 59 E S 63 W

Distance 120 98 212 85

Do you believe this to be a genuine Land Office Corner? Yes

If not, why?

J.A. Gjelhaug

(Signature)

Tech. Eng.

by D.J. Sutton

2-7-35
(Date)

Corner again.

Metal Location Poster is on a *No poster* tree inches diameter, on the side of from which this Corner bears chains distant. Give any further facts which will aid in finding this

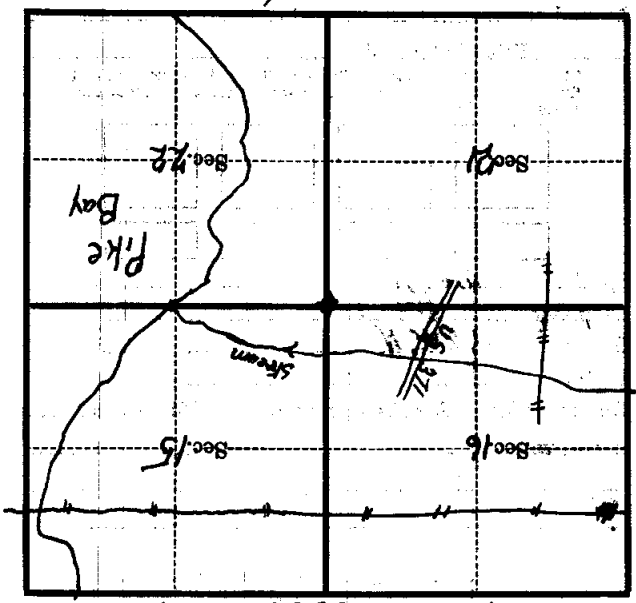

(Make sketch of topography near Corner)

T. R. Mer.