

R-9

R<sup>a</sup>

Section Corners Secs. 20-21-28-29

T 195N. R 30W Mer. 5<sup>th</sup>

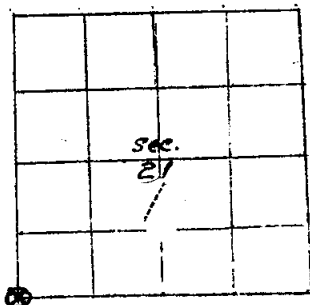

Corner is  
a Brass Coped Cement

Height 2" above Gr.

Dia 5"

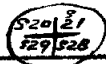
Marked 

BEARING TREES

T. 195N. R. 30W.

Marks	<u>S 28</u> <u>BT.</u>	<u>S. 29</u> <u>BT.</u>	<u>S 21</u> <u>BT.</u>	<u>S 20</u> <u>BT.</u>
Species	<u>ASH</u>	<u>Ash</u>	<u>W. Pine</u>	<u>W. Pine</u>
Diameter	<u>6"</u>	<u>14"</u>	<u>6"</u>	<u>6"</u>
Bearing	<u>S. 76<sup>1</sup>/<sub>4</sub>° E.</u>	<u>S. 19<sup>1</sup>/<sub>4</sub>° W.</u>	<u>N. 91<sup>1</sup>/<sub>2</sub>° E.</u>	<u>N. 55<sup>1</sup>/<sub>2</sub>° W.</u>
1/8 Dist. <sup>4700'</sup> <del>100'</del>	<u>42</u>	<u>89<sup>3</sup>/<sub>4</sub></u>	<u>105<sup>3</sup>/<sub>4</sub></u>	<u>72</u>

Metal poster on \_\_\_\_\_

Remarks:

Date 6/29/34 Signed J. A. Gjelhaug