

U. S. Department of Agriculture

FOREST SERVICE

✓ Chippewa NATIONAL FOREST

CORNERS OF THE PUBLIC SURVEY

T. 145N R. 28W. 5th Mer.

1/4

Corner common to Sections

34, and 35

Corner consists of a nostake (not) in place
State condition

Dimensions above ground _____ inches

Sketch grooves, letters, figures, or notches, on proper face or edge.

CARDINAL POSITION

DIAGONAL POSITION

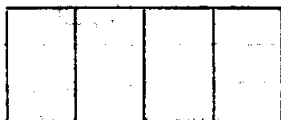
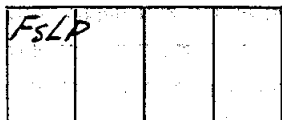

N W S E

NW SW SE NE

Mound of _____ is located _____

Pits are located _____

Sketch markings of Bearing Trees (or Rocks) in proper box and fill blanks below, giving bearings from Corner to Trees and Distances in Links.



Species SPRUCE

Diameter 5"

Bearing N5E

Distance 1.53 chs

Do you believe this to be a genuine Land Office Corner? _____

If not, why? there is no evidence of any bearing trees and there is no stake of any kind

E.M. Hardy
C.O.P.

(Date)

(Title)

Corner again.
 This corner is on the
 Bens Township line and can
 be found following an old
 fence line south from the
 South Six Mile Road for about
 550 yds.

Give any further facts which will aid in finding this
 corner again.
 1.33 chains distant
 from which this Corner bears
 S 5 W
 side of said tree
 tree 5" inches diameter, on the south west
 Metal Location Poster is on a
 S 5 W

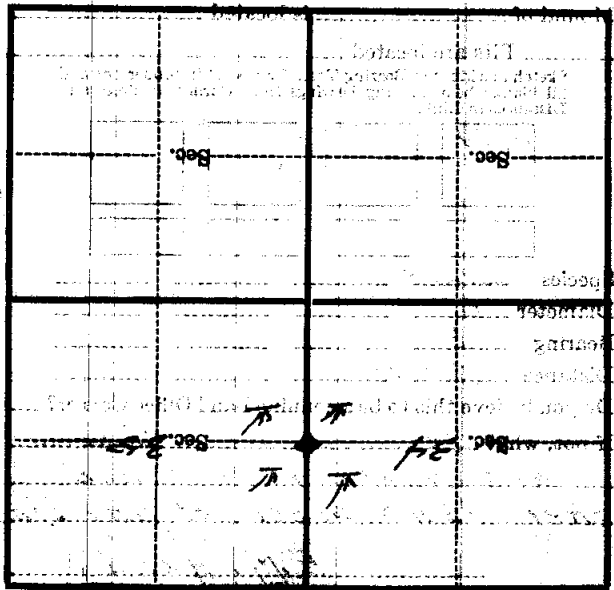

(Make sketch of topography near Corner)

T. 145 N. R. 27 W. 6 Mer.

145
4
R. 28
56

Corner consists of: 34 and 30
Corner common to Section

DESCRIPTION OF CORNER

Dimension above ground: Cedar No. 77
30
Sketch grooves, letters, figures, or notches, on proper face or edge.

CARDINAL POSITION

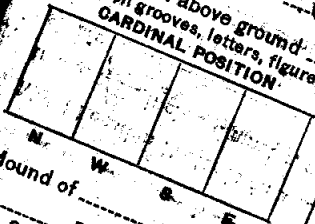

DIAGONAL POSITION

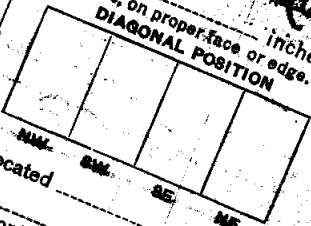

Mound of _____ is located _____

Pits are located _____
Sketch markings of Bearing Trees (or Rocks) in proper box and fill blanks below, giving bearings from Corner to Trees and Distances in Links.

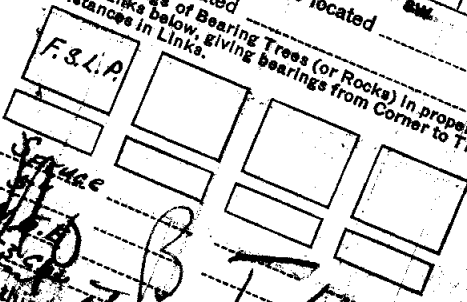

Species
Diameter
Ring
Growth

believe this to be a genuine Land Office Corner? No
Why? There is no evidence of a
and there is no stake of
C.M. Handy
L.H. C. M. Handy
L.H. C. M. Handy

T. 14 S. N. R. 2 E. W. 6 T. 4 Mer.

(Make sketch of topography near corner.)

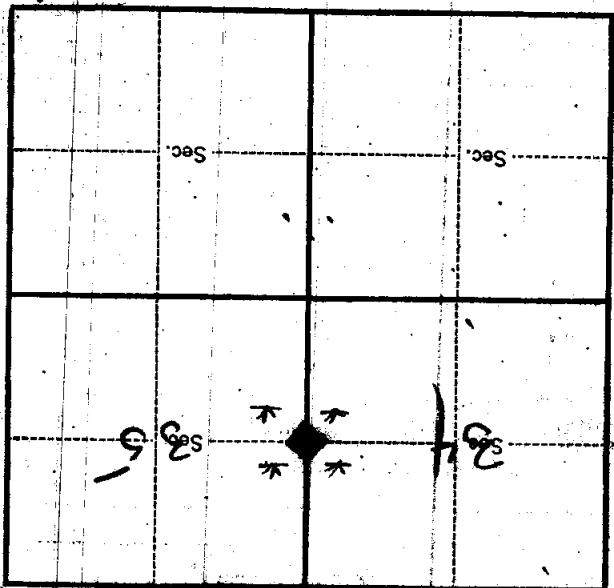

Spruce

5 ft. SW

tree 45 inches diameter, on the

side of the tree

10 S. 5 W. 6 T. 4

from which this corner bears

43 153

yards distant.

Give any further facts which will aid in finding this

Corner again.

Corner about 30 feet

West of I.P. North

is a small stump

The corner is on the Benz Twp.

line and can be found following

an old fence line S. from the S.

Road for about 50 chs.

U. S. Department of Agriculture
FOREST SERVICE

123

Chippewa NATIONAL FOREST

P

CORNERS OF THE PUBLIC SURVEY

T. 145 N. R. 28 W. 5 th. Mer.

1/4

Corner common to Sections

34, and 35

Corner consists of a nostake (not) in place

State condition

Dimensions above ground _____ inches

Sketch grooves, letters, figures, or notches, on proper face or edge.

CARDINAL POSITION

DIAGONAL POSITION

--	--	--	--

--	--	--	--

N W S E

NW SW SE NE

Mound of _____ is located _____

Pits are located _____

Sketch markings of Bearing Trees (or Rocks) in proper box and fill blanks below, giving bearings from Corner to Trees and Distances in Links.

FSLP			

Species spruce

Diameter 5"

Bearing N 5E

Distance 1.53 chs.

Do you believe this to be a genuine Land Office Corner? No

If not, why? there is no evidence of any bearing trees and there is no stake of any kind.

E. M. Hardy
(Signature)

Chief of Party

(Date)

(Title)

X-17

(Make sketch of topography near Corner)

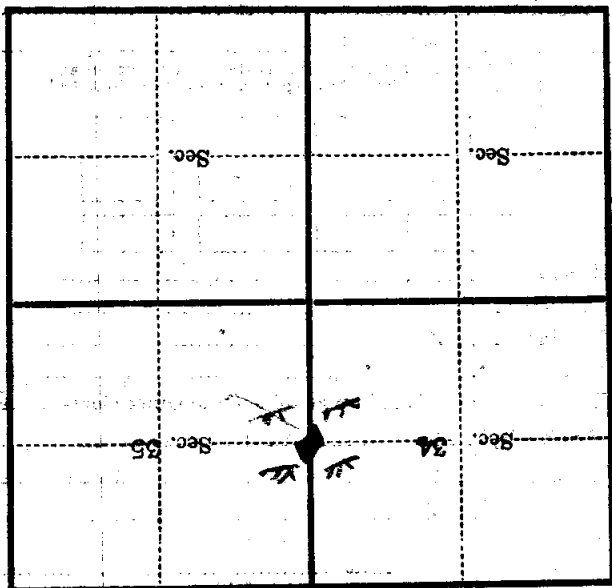

Metal Location Poster is on a Spruce

tree 5. inches diameter, on the south west

side of said tree

from which this Corner bears S 5 W

1.55 chains distant.

Give any further facts which will aid in finding this

Corner again.

This corner is on the Bens Township

line and can be found following an old

fence line south from the south six

Road for about 53 chs.