

*checky
Posted*

U. S. Department of Agriculture
FOREST SERVICE

2-21

Chippewa NATIONAL FOREST
CORNERS OF THE PUBLIC SURVEY

T. *145N* R. *27W* *5th* Mer.

This Corner common to Sections
35, 36, 2, and 1

Corner consists of a *Squared Stake* (not) in place

State condition *New stake*

Dimensions above ground *3 x 3* inches

Sketch grooves, letters, figures, or notches, on proper face or edge.

CARDINAL POSITION

DIAGONAL POSITION

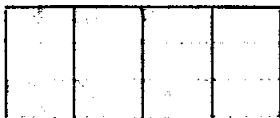
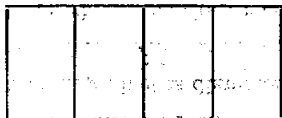

Mound of _____ is located _____

Pits are located _____

Sketch markings of Bearing Trees (or Rocks) in proper box and fill blanks below, giving bearings from Corner to Trees and Distances in Links.

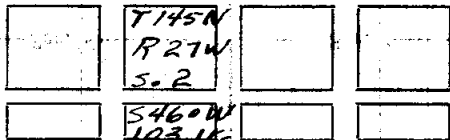

Species *Norway Pine*

Diameter *2.00*

Bearing *S 46° W*

Distance *103 lks.*

Do you believe this to be a genuine Land Office Corner? _____

If not, why? _____

T. Fairbanks

(Signature)

C. C. C.

(Title)

(Date)

Continued from Form No. 1

FEDERAL BUREAU OF INVESTIGATION

REPORT OF THE SPECIAL AGENT IN CHARGE

NAME OF THE SUBJECT OR PARTY

Corner is approximately located
line from west of from south
scribed state could not be
found
Corner again.

Give any further facts which will aid in finding this

direction of location observe distant

from which this Corner bears

side of *Tree*

tree 6 inches diameter, on the *East*

Metal Location Poster is on a *Spur*

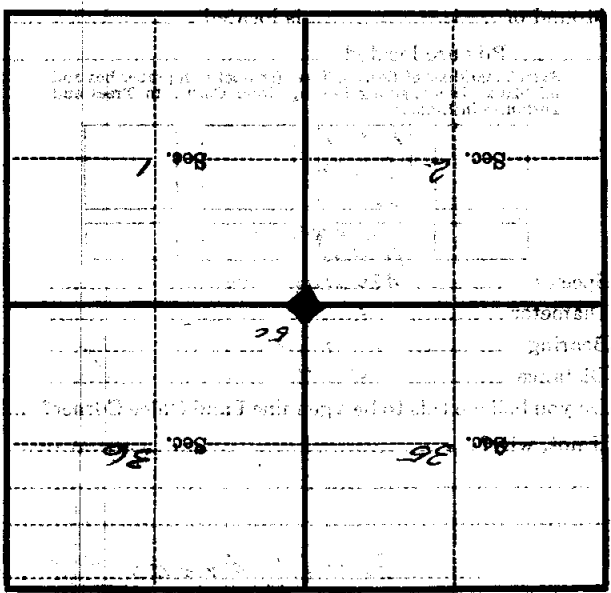

(Make sketch of topography near Corner)

T. 145 N. R. 27 W. 5th Mer.

U. S. Department of Agriculture
FOREST SERVICE

2-21

Chippewa NATIONAL FOREST

CORNERS OF THE PUBLIC SURVEY

T. *145 & 144* R. *27* Mer. *5th*

Section Corner common to Sections
1, 2, 35, and 36

Corner consists of a *square stake (not)* in place
State condition *old but fairly solid*

Dimensions above ground *30* inches

Sketch grooves, letters, figures, or notches, on proper face or edge.

CARDINAL POSITION

DIAGONAL POSITION



N W S E

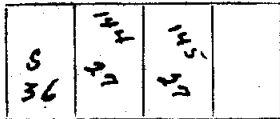

NW SW SE NE

Mound of _____ is located _____

Pits are located _____

Sketch markings of Bearing Trees (or Rocks) in proper box and fill blanks below, giving bearings from Corner to Trees and Distances in Links.

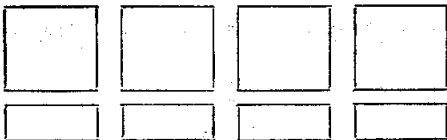

Species _____

Diameter _____

Bearing _____

Distance _____

Do you believe this to be a genuine Land Office Corner? *Yes*

If not, why? _____

Carl M. Handy

(Signature)

chief of Party

(Title)

1/10/34
(Date)

L.P. on No. 8 is 40 chs. due N of Cor
old blazed line to corner.
Corner again.

Give any further facts which will aid in finding this
5 lbs. chains distant:
from which this Corner bears S.W.
side of **the corner**
tree 8" inches diameter, on the N.E.
J. Pine
Metal Location Poster is on a

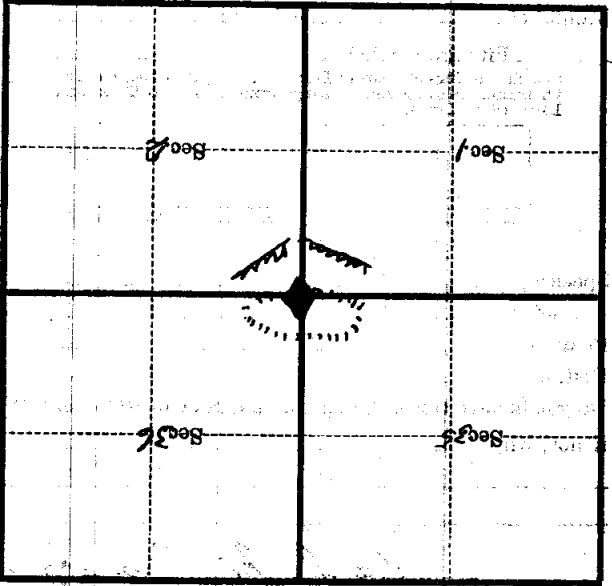

(Make sketch of topography near Corner)

T. 144 & 145 R. 27 S. 5th
Mer.

Form 874-9—Revised May, 1918
U. S. Department of Agriculture
FOREST SERVICE

*Copied
Posted
5/36
2-21*

----- NATIONAL FOREST
CORNERS OF THE PUBLIC SURVEY

T. 145 ----- R7 ----- 5 ----- Mer.

¹/₂ ----- Corner common to Sections
35 ----- 36 -----, and -----

Corner consists of a **norway stake** (not) in place
State condition -----

Dimensions above ground ----- inches
Sketch grooves, letters, figures, or notches, on proper face or edge.

CARDINAL POSITION

DIAGONAL POSITION

--	--	--	--

N W S E

--	--	--	--

NW SW SE NE

Mound of ----- is located -----

----- Pits are located -----

Sketch markings of Bearing Trees (or Rocks) in proper box and
fill blanks below, giving bearings from Corner to Trees and
Distances in Links.

Species -----

Diameter -----

Bearing -----

Distance -----

Do you believe this to be a genuine Land Office Corner? -----

If not, why? -----

(Signature)

(Date)

(Title)

U. S. DEPARTMENT OF AGRICULTURE
FOREST SERVICE

Posted

Chippewa NATIONAL FOREST 2-21

CORNERS OF THE PUBLIC SURVEY

T. 145 R. 27 N. 5th Mer.

Section Corner common to Sections
35, 36, and

DESCRIPTION OF CORNER

Corner consists of a Scrubbed stake

Dimension above ground 40 inches.

Sketch grooves, letters, figures, or notches, on proper face or edge.

CARDINAL POSITION

DIAGONAL POSITION

N	W	S	E

S			T
35	✓	✓	144 R 27 N 35
NW	SW	SE	NE

Mound of _____ is located _____

Pits are located _____

Sketch markings of Bearing Trees (or Rocks) in proper box and fill blanks below, giving bearings from Corner to Trees and Distances in Links.

✓	✓	✓	✓

Species ✓ _____
 Diameter ✓ _____
 Bearing _____
 Distance ✓ _____

Do you believe this to be a genuine Land Office Corner? Yes

If not, why? _____

W. B. Johnson
Signature

Sept. 19, 1929 _____
Date Title

Give any further facts which will aid in finding this corner again.

Corner bears from which this corner bears

7 inches diameter, on the

Poster is on a

tree

side of

from which this corner bears

Give any further facts which will aid in finding this corner again.



Poster

7 3/8" E

R. 279

Sketch of topography near corner

NOT

U. S. DEPARTMENT OF AGRICULTURE
FOREST SERVICE

Posted

Chippewa NATIONAL FOREST 2-21

CORNERS OF THE PUBLIC SURVEY

T. 145 R. 27 N. 5-11 Mer.

Section Corner common to Sections
35, 36, 37, and 38

DESCRIPTION OF CORNER

Corner consists of a Scrubbed stake

Dimension above ground 40 inches.

Sketch grooves, letters, figures, or notches, on proper face or edge.

CARDINAL POSITION

DIAGONAL POSITION

--	--	--	--

N W S E

S			7
35	V	V	14th R 27th Sec 35

NW SW SE NE

Mound of _____ is located _____

Pits are located _____

Sketch markings of Bearing Trees (or Rocks) in proper box and fill blanks below, giving bearings from Corner to Trees and Distances in Links.

Species V _____
Diameter 1 _____
Bearing _____
Distance 1 _____

Do you believe this to be a genuine Land Office Corner? Yes
If not, why? _____

H. E. Johnson
Signature
Sept. 19, 1929
Date
Estimator
Title
8-3027

(Make sketch of topography near corner.)

T. 145 R. 27 N. 5th Mer.

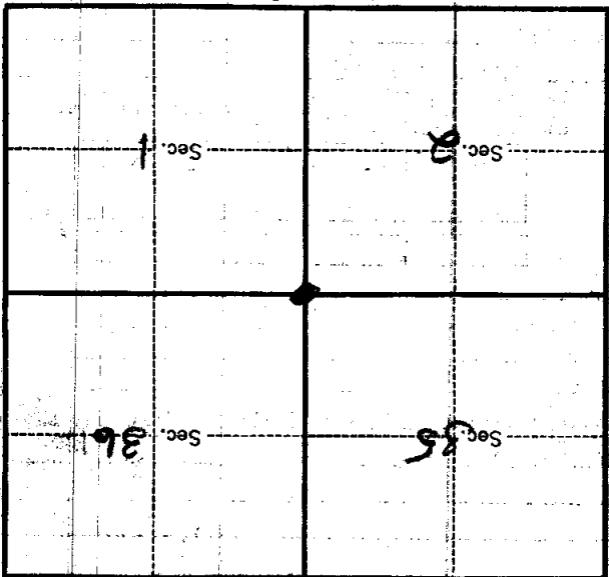

Metal Location Poster is on a *Jack Pine* tree 7 inches diameter, on the side of *Tree* from which this Corner bears *N 35° E* ~~62 links~~ chains distant.

Give any further facts which will aid in finding this Corner again.

Corner
Jack Pine
62 links
N 35° E