

Form 874-9—Revised May, 1918  
U. S. Department of Agriculture  
FOREST SERVICE

*Copied  
Postal  
57  
36.  
#17*

----- NATIONAL FOREST -----

CORNERS OF THE PUBLIC SURVEY P-17

T. 145 R. 27 S. 5 Mer.

$\frac{1}{4}$  Corner common to Sections  
-----, 22-----, ----- 23-----, and -----

Corner consists of a poplar stake (not) in place  
State condition -----

Dimensions above ground ----- inches

Sketch grooves, letters, figures, or notches, on proper face or edge.

CARDINAL POSITION

DIAGONAL POSITION

--	--	--	--

N W S E

--	--	--	--

NW SW SE NE

Mound of ----- is located -----

Pits are located -----

Sketch markings of Bearing Trees (or Rocks) in proper box and  
fill blanks below, giving bearings from Corner to Trees and  
Distances in Links.

Species -----

Diameter -----

Bearing -----

Distance -----

Do you believe this to be a genuine Land Office Corner? -----

If not, why? -----

-----

-----

(Signature) -----

(Date) -----

(Title) -----

Section 2  
 Section 3  
 Section 4  
 Section 5  
 Section 6  
 Section 7  
 Section 8  
 Section 9  
 Section 10  
 Section 11  
 Section 12  
 Section 13  
 Section 14  
 Section 15  
 Section 16  
 Section 17  
 Section 18  
 Section 19  
 Section 20  
 Section 21  
 Section 22  
 Section 23  
 Section 24  
 Section 25  
 Section 26  
 Section 27  
 Section 28  
 Section 29  
 Section 30  
 Section 31  
 Section 32  
 Section 33  
 Section 34  
 Section 35  
 Section 36  
 Section 37  
 Section 38  
 Section 39  
 Section 40  
 Section 41  
 Section 42  
 Section 43  
 Section 44  
 Section 45  
 Section 46  
 Section 47  
 Section 48  
 Section 49  
 Section 50

none  
 Corner again.  
 Give any further facts which will aid in finding this  
 chain distant  
 from which this Corner bears  
 side of  
 inches diameter, on the  
 Metal Location Poster is on a

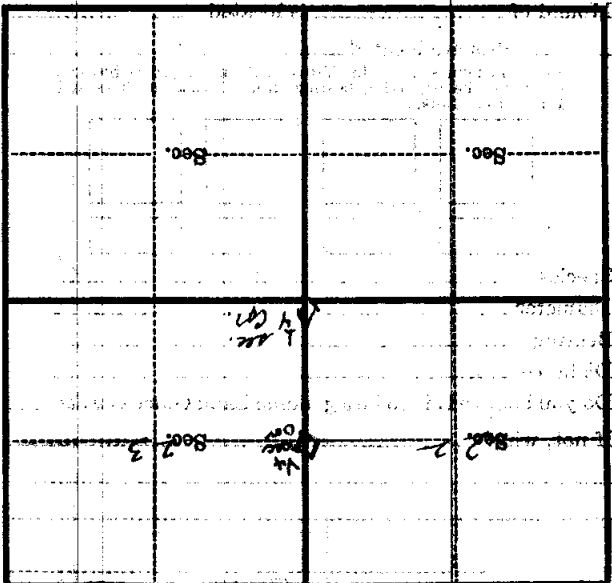

(Make sketch of topography near Corner)