

Form 874-9—Revised May, 1918
 U. S. Department of Agriculture
 FOREST SERVICE

*Copied
 Posted
 5-11
 R-1*

NATIONAL FOREST

CORNERS OF THE PUBLIC SURVEY

T. 145 R. 27 S. 5 Mer.
 $\frac{1}{4}$ Corner common to Sections
 21, 28, and

Corner consists of a tan stub (not) in place
 State condition

Dimensions above ground _____ inches
 Sketch grooves, letters, figures, or notches, on proper face or edge.
 CARDINAL POSITION DIAGONAL POSITION

N	W	S	E

NW	SW	SE	NE

Mound of _____ is located _____

Pits are located _____

Sketch markings of Bearing Trees (or Rocks) in proper box and fill blanks below, giving bearings from Corner to Trees and Distances in Links.

Species _____

Diameter _____

Bearing _____

Distance _____

Do you believe this to be a genuine Land Office Corner? _____

If not, why? _____

(Signature)

(Date)

(Title)

Metal Location Poster is on a tree inches diameter, on the side of from which this Corner bears chains distant.

Give any further facts which will aid in finding this Corner again.

	Sec.	Sec.	
	Sec.	Sec.	

(Make sketch of topography near Corner)

Form 874-9—Revised May, 1918
U. S. Department of Agriculture
FOREST SERVICE

P
R-11

Chippewa NATIONAL FOREST
CORNERS OF THE PUBLIC SURVEY

T. 145 N R. 27 W 5th P. Mer.

Quarter Corner common to Sections
21, and 28

Corner consists of a Scribed Post (not) in place

State condition Good

Dimensions above ground 30 inches

Sketch grooves, letters, figures, or notches, on proper face or edge.

CARDINAL POSITION

DIAGONAL POSITION

--	--	--	--

N W S E

--	--	--	--

NW SW SE NE

Mound of _____ is located _____

Pits are located _____

Sketch markings of Bearing Trees (or Rocks) in proper box and fill blanks below, giving bearings from Corner to Trees and Distances in Links.

<u>orig. 145 21</u>			
<u>B.T.</u>			

Species Tam.

Diameter 7"

Bearing S. 40° W.

2 1/2 Distance 11

Do you believe this to be a genuine Land Office Corner? Yes

If not, why? _____

J. A. Gjelhauq

(Signature)

4/20/37

(Date)

Jr. Civil Eng

(Title)

Corner again

Give any further facts which will aid in finding this

chain distant

from which this Corner bears

side of *TR*

tree 3 inches diameter, on the *SW*

Metal Location Poster is on a *TR*

5590 W

SW

TR

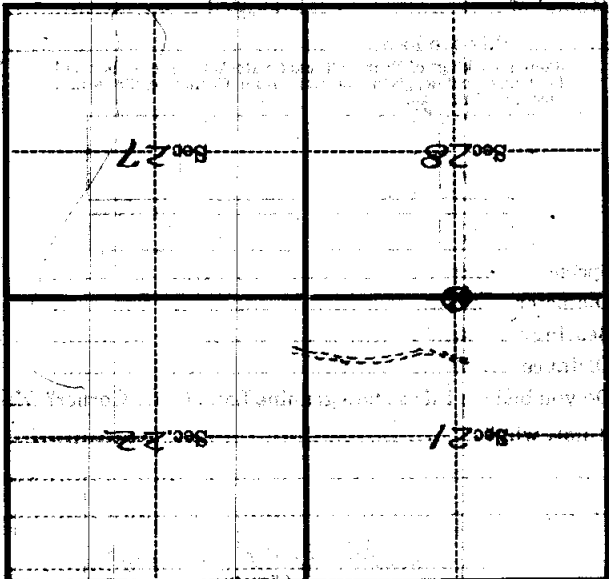

(Make sketch of topography near Corner)

T. 145 N. R. 27 W. 5590 W. Mer.