

U. S. DEPARTMENT OF AGRICULTURE  
FOREST SERVICE

Chippewa NATIONAL FOREST

CORNERS OF THE PUBLIC SURVEY

T. 145 N R. 27 W S. 5 E Mer.

1/4 Corner common to Sections

5 and 8 **E-1**

Corner consists of a Scribed Squared Stake in place

State condition Good

Dimensions above ground 2 X 3 X 30 inches.

Sketch grooves, letters, figures, or notches, on proper face or edge.

CARDINAL POSITION

DIAGONAL POSITION

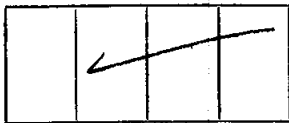
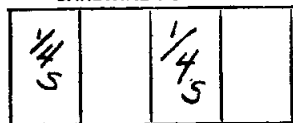

Mound of ✓ is located ✓

Pits are located ✓

Sketch markings of Bearing Trees (or Rocks) in proper box and fill blanks below, giving bearings from Corner to Trees and Distances in Links.



Species Dead Tain Tree Dead Tain Tree

Diameter 9" 8"

Bearing S 50° W N 67° E

Distance 10 Lks 15 Lks

Do you believe this to be a genuine Land Office Corner? yes

If not, why? \_\_\_\_\_

Edward Jensen

Signature.

11-6-29

Date.

Estimator

Title.

(Make sketch of topography near Corner.)

T. 145 N R. 27 W S 25 Mer.

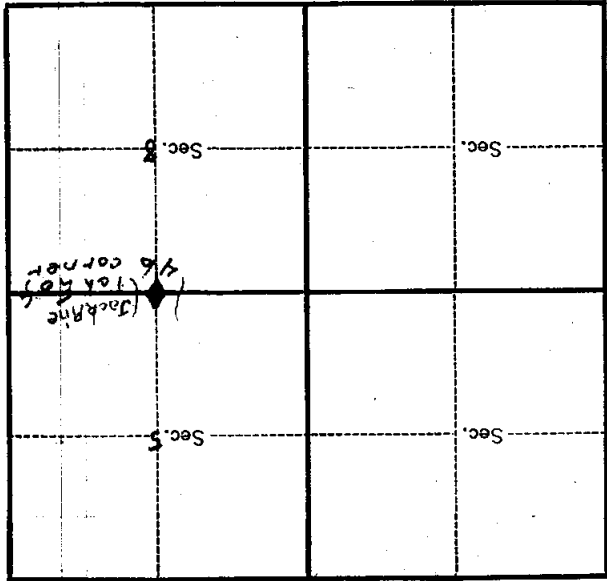

Metal Location Poster is on a *Tamarack*

tree *3* inches diameter, on the *south*

side of *section line*

from which this Corner bears *S 26° E*

*25* chains distant.

Give any further facts which will aid in finding this

Corner again.

E-7

U. S. Department of Agriculture  
FOREST SERVICE

E-7

NATIONAL FOREST

CORNERS OF THE PUBLIC SURVEY

T. 145 R. 27 5<sup>th</sup> Mer.

Corner common to Sections

4, 5, and 8

Corner consists of a 3X3 scribbled stake in place

State condition FRIT

Dimensions above ground Leaning 45° inches

Sketch grooves, letters, figures, or notches, on proper face or edge.

CARDINAL POSITION

DIAGONAL POSITION

--	--	--	--

N W S E

--	--	--	--

NW SW SE NE

Mound of \_\_\_\_\_ is located \_\_\_\_\_

Pits are located \_\_\_\_\_

Sketch markings of Bearing Trees (or Rocks) in proper box and fill blanks below, giving bearings from Corner to Trees and Distances in Links.

S 5 old BT		S 5 new BT	S 8 new BT
---------------------	--	---------------------	---------------------

Species Tam. Stump TAM TAM

Diameter 9" 6" 8"

Bearing N 68° E N 65° W S 32° W

Distance 9.9' 12.5' 32.3'

Do you believe this to be a genuine Land Office Corner? NO

If not, why? \_\_\_\_\_

3' tam S 9 W 18 lbs - 10 6'

3' tam N 13 W 26 lbs - 12 2'

(Signature)

4-17-58

(Date)

(Title)

I bleed lines west to  
 Highway # 5-9  
 Corner again.

Give any further facts which will aid in finding this  
 227 ft  
 from which this Corner bears  
 N 13° E  
 side of  
 tree 5 inches diameter, on the  
 NORTH  
 Metal Location Poster is on a

227 ft  
 from which this Corner bears  
 N 13° E  
 side of  
 tree 5 inches diameter, on the  
 NORTH  
 Metal Location Poster is on a

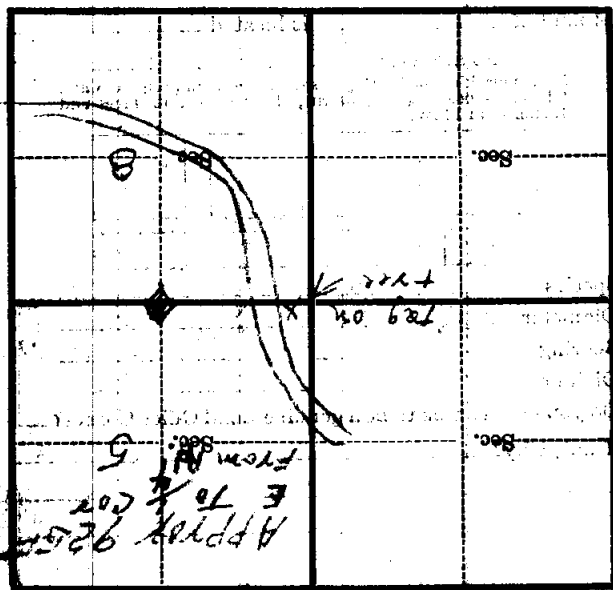

(Make sketch of topography near Corner)

T. 145 R. 27  
 Mer.

U. S. Department of Agriculture

FOREST SERVICE

E-7

Chippewa NATIONAL FOREST

CORNERS OF THE PUBLIC SURVEY

T. 145 R. 27 S. 2 Mer.

1/4 Corner common to Sections 5, and 8

Corner consists of a squared stake (not) in place

State condition poor

Dimensions above ground 3 inches.

Sketch grooves, letters, figures, or notches, on proper face or edge.

STONE CORNERS

METAL CORNERS

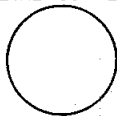
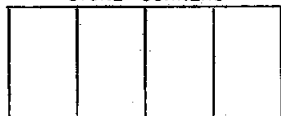

N W S E

Mound of \_\_\_\_\_ is located \_\_\_\_\_

Pits are located \_\_\_\_\_

Sketch markings of Bearing Trees (or Rocks) in proper box and fill blanks below, giving bearings from Corner to Trees and Distances in Links.

Four sets of boxes for sketching trees and recording bearings and distances.

Species Junco Junco

Diameter 5" 8"

Bearing NW SW

Distance 6 ft 30 ft

Do you believe this to be a genuine Land Office Corner? No.

If not, why? No Brass cap.

J. M. Morrison

(Signature)

8-20-60 (Date)

Forester (Title)

T. 145 R. 27 Mer. 52

(Make sketch of topography near Corner and show section line markers thus "X")

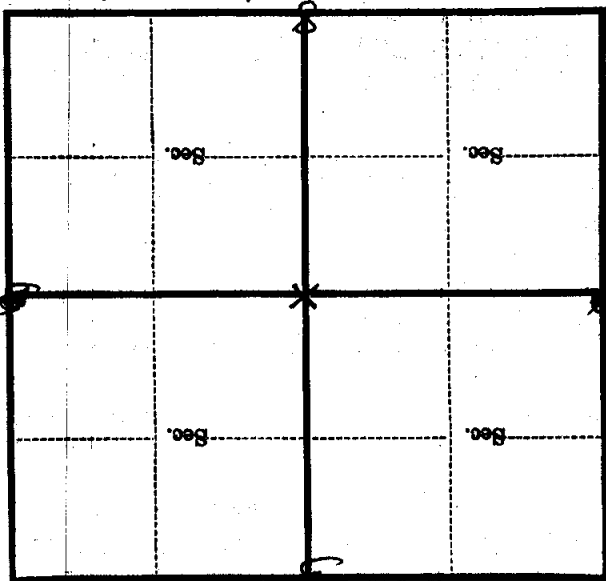

Metal Location Poster is on a *township*

tree *6* inches diameter, on the *N.*

side of *Tree*

this Corner bears *N. 18° E.*, *32.7 ft* distance

(Bearing) (Distance)

Section line marker between Secs. and is on

a *Tree, post, etc.* on the

(Name of road, trail, etc.)

located chains *L, W, N, S*, from Sec. *Cor.*; *1/4 Cor.*; *Witness Cor.*

(Cross out nonapplicable)

Give any further facts needed to find Corner again:

*Blk. line from N-S-E SW of corner*