

U. S. Department of Agriculture

FOREST SERVICE

2-5

Chippewa NATIONAL FOREST

CORNERS OF THE PUBLIC SURVEY

T. 145 N. R. 26 W. Mer.

Sec. Corner common to Sections

31, and 32

Corner consists of a (not) in place

State condition New treated post

Dimensions above ground inches

Sketch grooves, letters, figures, or notches, on proper face or edge.

CARDINAL POSITION

DIAGONAL POSITION

--	--	--	--

N W S E

--	--	--	--

NW SW SE NE

Mound of is located

Pits are located

Sketch markings of Bearing Trees (or Rocks) in proper box and fill blanks below, giving bearings from Corner to Trees and Distances in Links.

Species

Diameter

Bearing

Distance

Do you believe this to be a genuine Land Office Corner? No

If not, why? F. S. established.

Jaslett

(Signature)

53 (Date)

(Title)

Give any further facts which will aid in finding this
 Corner again. Set 7" treated post 3 1/2 feet
 high at point surveyed by 1951 crew. Post
 is scribed "SGN". F.S.L.P. tag put on
 5" red plus 8.79° W 0.30 ch. This corner
 is 8.89° 56.1' W. 5.00 ch. from the corner
 of Secs. 1 & 6 of T. 174 N., R. 26 W. which
 is marked by a similar post.

chains distant.

from which this Corner bears

side of

tree inches diameter, on the

Metal Location Poster is on a

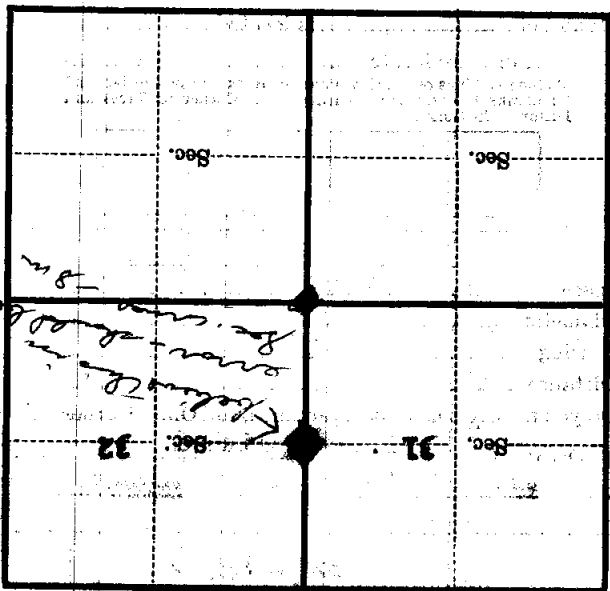

(Make sketch of topography near Corner)

T. 174 N. R. 26 W. Mer.