

Form 874-9--Revised May, 1918  
 U. S. Department of Agriculture  
 FOREST SERVICE

X-Y-21  
 pps

Chippewa NATIONAL FOREST

CORNERS OF THE PUBLIC SURVEY

T. 144N R. 31W S<sup>th</sup> P. Mer.

MC Corner common to Sections  
 \_\_\_\_\_, \_\_\_\_\_, 35, and 36

Corner consists of a Iron Post: Brass Cap (not) in place  
 State condition Good

Dimensions above ground \_\_\_\_\_ inches.

Sketch grooves, letters, figures, or notches, on proper face or edge.

CARDINAL POSITION

DIAGONAL POSITION

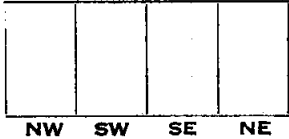
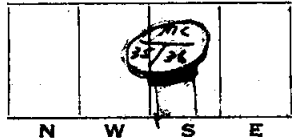

Mound of \_\_\_\_\_ is located \_\_\_\_\_

\_\_\_\_\_ Pits are located \_\_\_\_\_

Sketch markings of Bearing Trees (or Rocks) in proper box and fill blanks below, giving bearings from Corner to Trees and Distances in Links.

WCT144N  
 R31W  
 Sec 35

WCT  
 T144N  
 R31W  
 Sec 36

[Empty box]

[Empty box]

MCBT

MCBT

[Empty box]

[Empty box]

Species Aspen W. Spruce  
 Diameter 13" 12"  
 Bearing S20°W N20°E  
 Distance 250' 280'

Do you believe this to be a genuine Land Office Corner? Yes

If not, why? \_\_\_\_\_

(sd) J. G. Bodans

(Signature)

Estimator

(Title)

12-17-31

(Date)

Corner again.

Metal Location Poster is on a tree inches diameter, on the side of from which this Corner bears chains distant. Give any further facts which will aid in finding this

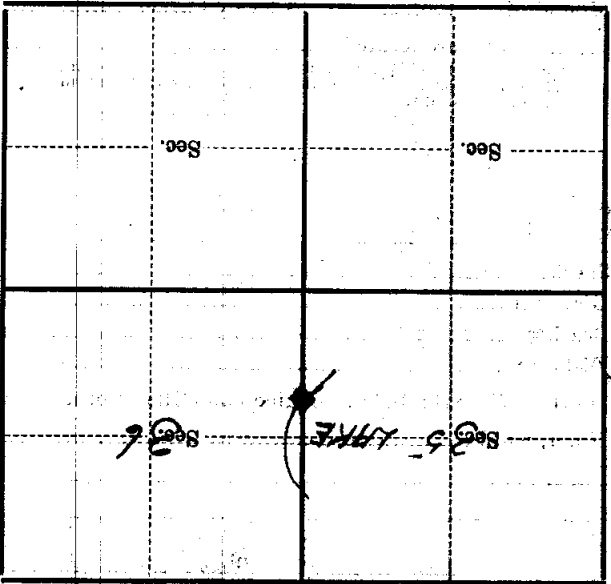

(Make sketch of topography near Corner)

T. K. N. R. 31 N. 57 N. K-Y-21 Mer.