

U. S. Department of Agriculture

FOREST SERVICE

Poted
T-25

Chippewa NATIONAL FOREST

CORNERS OF THE PUBLIC SURVEY

T. 144N R. 30W+31W 5th Mer. Quarter

Corner common to Sections 25, and 30

Corner consists of a Breap iron pipe (not) in place
State condition good

Dimensions above ground 1x5 inches
Sketch grooves, letters, figures, or notches, on proper face or edge.

CARDINAL POSITION

DIAGONAL POSITION

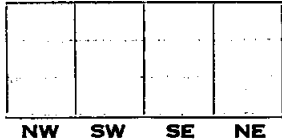
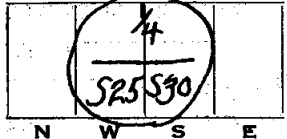

Mound of _____ is located _____

Pits are located _____

Sketch markings of Bearing Trees (or Rocks) in proper box and fill blanks below, giving bearings from Corner to Trees and Distances in Links.

1/4 S25	1/4 S30		
B.T.	B.T.		

Species H. Maple H. Maple
Diameter 10" 12"
Bearing N75°15'W N77°E
Distance 73 74

Do you believe this to be a genuine Land Office Corner? Yes

If not, why? _____

Dorman J. Sutton
(Signature)

8-27-34
(Date)

Compassman
(Title)

Corner again.

Give any further facts which will aid in finding this

chains distant.

from which this Corner bears

side of

tree inches diameter, on the

Metal Location Poster is on a

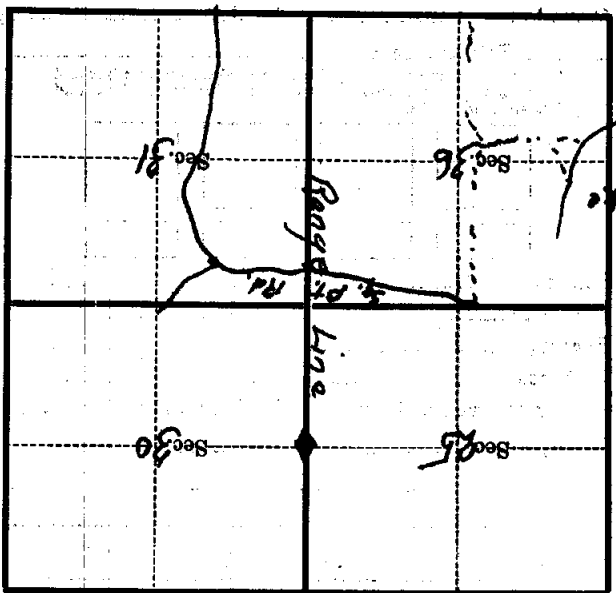

(Make sketch of topography near Corner)

T. 1411 N R. 31 + 30 W S. 4
T-25 Mer.