

U. S. Department of Agriculture
FOREST SERVICE

X-24

Posted

Chippewa NATIONAL FOREST X 24

CORNERS OF THE PUBLIC SURVEY

T. 144 N R. 31 W 5th Mer.

Sixteenth No. 8 Corner common to Sections 36, and

Corner consists of a Br. cap. 1" pipe (not) in place
State condition good

Dimensions above ground 5 inches

Sketch grooves, letters, figures, or notches, on proper face or edge.

CARDINAL POSITION

DIAGONAL POSITION

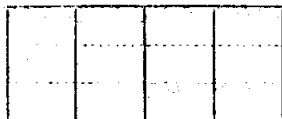

N W S E

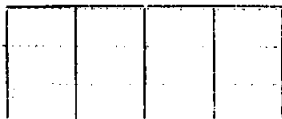

NW SW SE NE

Mound of _____ is located _____

Pits are located _____

Sketch markings of Bearing Trees (or Rocks) in proper box and fill blanks below, giving bearings from Corner to Trees and Distances in Links.



Species Aspen-Dead R. Oak

Diameter 15" 6"

Bearing S52°30'E N47°45'W

Distance .33 30 1/4

Do you believe this to be a genuine Land Office Corner? Yes

If not, why? _____

Dorman J. Sutton
(Signature)

9-6-21
(Date)

Compassman
(Title)

X-24

Corner again.

Give any further facts which will aid in finding this
 ----- chains distant.
 from which this Corner bears -----
 side of -----
 tree ----- inches diameter, on the -----
 Metal Location Poster is on a -----

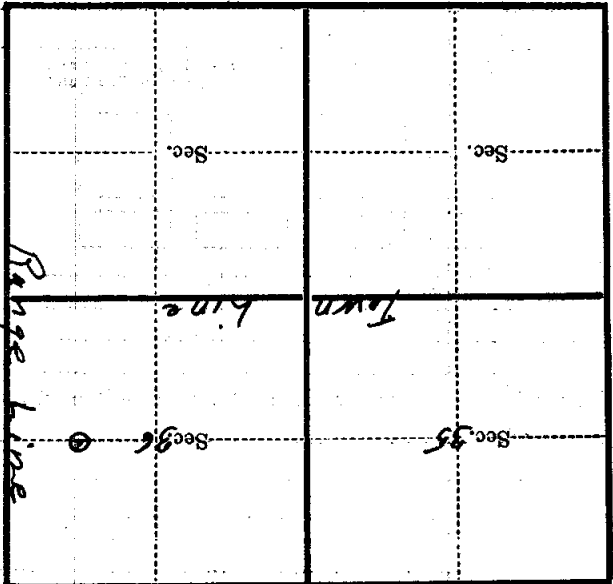

(Make sketch of topography near Corner)

T. 144 N. R. 31 W. 5th X-24 Mer.