

U. S. Department of Agriculture
FOREST SERVICE

E-19
Poster
E19

Chippewa NATIONAL FOREST

CORNERS OF THE PUBLIC SURVEY

T. 144 N R. 30 E 5TH Mer.

Quarter Corner common to Sections
2, and 11

Corner consists of a Br. Cap. iron pipe in place
State condition Good

Dimensions above ground 1.00 inches

Sketch grooves, letters, figures, or notches, on proper face or edge.

CARDINAL POSITION

DIAGONAL POSITION

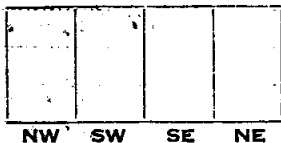

Mound of _____ is located _____

Pits are located _____

Sketch markings of Bearing Trees (or Rocks) in proper box and fill blanks below, giving bearings from Corner to Trees and Distances in Links.

<u>1/4</u> <u>S11</u>	<u>1/4</u> <u>S2</u>		
<u>B.T.</u>	<u>B.T.</u>		

Species Cedar W Pine

Diameter 8" 4 1/2"

Bearing S10°30'E N34°E

Distance 52 ch. 75 ch.

Do you believe this to be a genuine Land Office Corner? Yes

If not, why? _____

Loyal R. Ball
(Signature)

11-7-34
(Date)

Comptroller
(Title)

E-19

Corner again.

Give any further facts which will aid in finding this

52 chains distant.

from which this Corner bears N 10° 30' W

side of tree

tree 8 inches diameter, on the NW

Metal Location Poster is on a Cedar

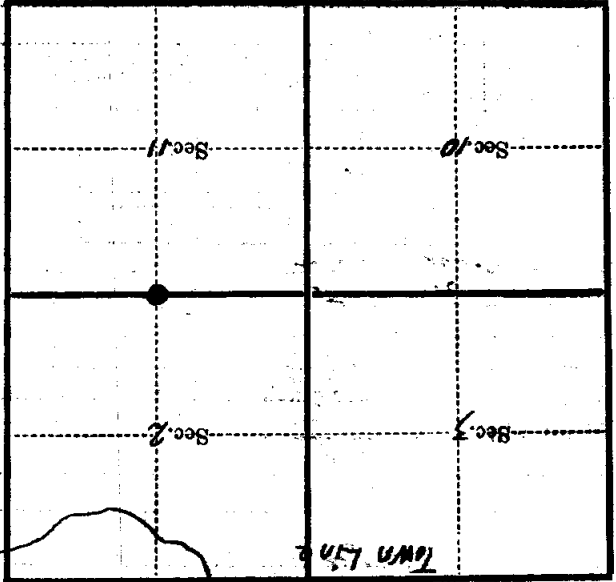

(Make sketch of topography near Corner)

T. 144 N. R. 30 W. 5th E. 19