

## U. S. Department of Agriculture

FOREST SERVICE

Posted

Chippewa NATIONAL FOREST

## CORNERS OF THE PUBLIC SURVEY

T. 144 N. R. 30 W. 5<sup>th</sup> Mer.

Section Corner common to Sections

26, 27, 34, and 35

Corner consists of a Br. cap in cement (not) in place

State condition good

Dimensions above ground 5" x 8" inches

Sketch grooves, letters, figures, or notches, on proper face or edge.

CARDINAL POSITION

DIAGONAL POSITION

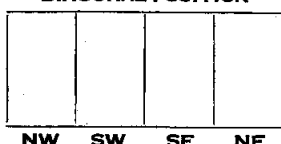
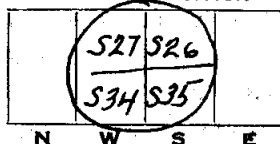

Mound of \_\_\_\_\_ is located \_\_\_\_\_

Pits are located \_\_\_\_\_

Sketch markings of Bearing Trees (or Rocks) in proper box and fill blanks below, giving bearings from Corner to Trees and Distances in Links.

S27

S26

S35

S34

B.T.

B.T.

B.T.

B.T.

Species Birch Birch Tam. Balsam

Diameter 5" 6" 8" down

Bearing N30 1/2° W N48 1/2° E S16 3/4° E S15° W

Distance 24 4 38 35

Do you believe this to be a genuine Land Office Corner? yes

If not, why? \_\_\_\_\_

Dorson J. Sutton

(Signature)

Compassman

(Title)

1-6-35

(Date)

Corner again.  
Give any further facts which will aid in finding this chains distant.

38  
From which this Corner bears  $N 16 \frac{3}{4}^{\circ} W$   
side of tree  
tree 8 inches diameter, on the NW  
Metal Location Poster is on a  $T.M.$

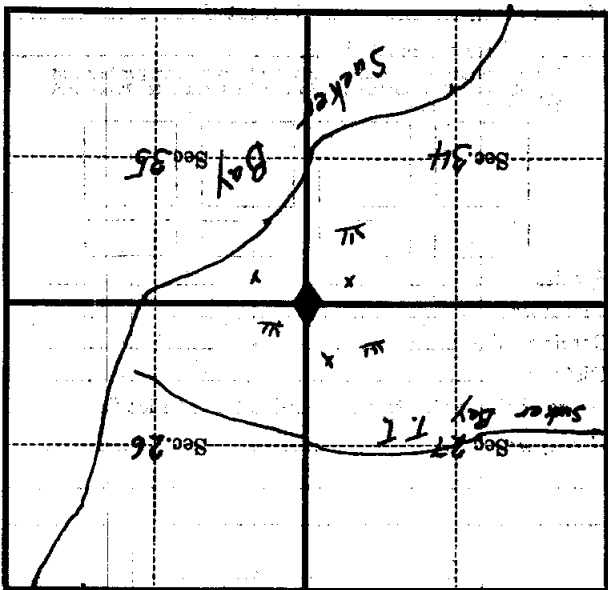

(Make sketch of topography near Corner)

T. L. HAN R. 300 5 16 Mer. V-19