

U. S. Department of Agriculture
FOREST SERVICE

C-9

Rooted
C9

Chippewa NATIONAL FOREST

CORNERS OF THE PUBLIC SURVEY

T. *144N.* R. *30W.* *5th* Mer.

Quarter Corner common to Sections

4, and *5*

Corner consists of a *Brass Caped Pipe* (~~rod~~) in place

State condition *Good*

Dimensions above ground *8* inches

Sketch grooves, letters, figures, or notches, on proper face or edge.

CARDINAL POSITION

DIAGONAL POSITION

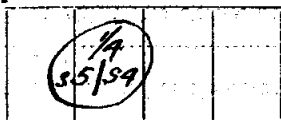

N W S E

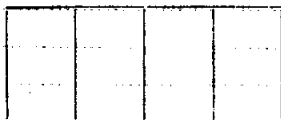

NW SW SE NE

Mound of _____ is located _____

Pits are located _____

Sketch markings of Bearing Trees (or Rocks) in proper box and fill blanks below, giving bearings from Corner to Trees and Distances in Links.



Species *W Spruce H. Maple*

Diameter *13"* *7"*

Bearing *N. 10° E. S. 73.30' W.*

LM Distance *31* *7 3/2*

Do you believe this to be a genuine Land Office Corner? *yes*

If not, why? _____

J.A. Gjelhaug
(Signature)

10/25/34
(Date)

Tech. Eng.
(Title)

C-9

Corner again.

Give any further facts which will aid in finding this

..... chains distant. 005

from which this Corner bears N. 06° E.

side of Tree

tree .5 inches diameter, on the North

Metal Location Poster is on a Balsam

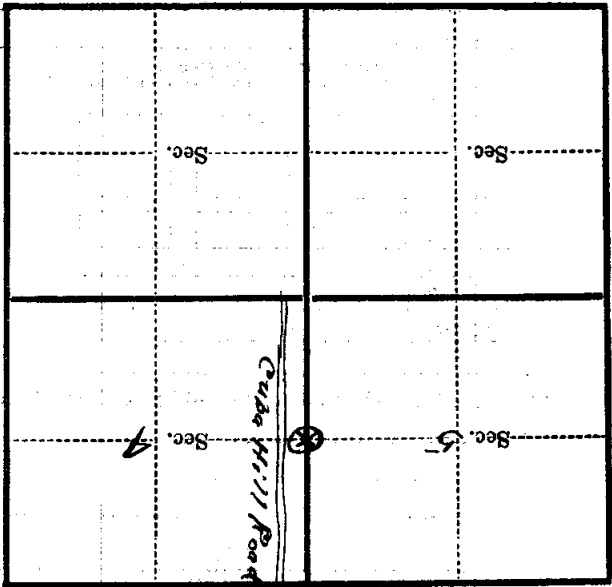

(Make sketch of topography near Corner)

T. 149N. R. 30W. 5th C-9 Mer.