

U. S. Department of Agriculture
FOREST SERVICE

Posted

Chippewa..... NATIONAL FOREST *T3*

CORNERS OF THE PUBLIC SURVEY

T144N..... *R.30W*..... *5th*..... Mer.

Quarter Center..... Corner common to Sections
30.....,, and

Corner consists of a *Br. capped 1" pipe* (~~not~~) in place
State condition *good*

Dimensions above ground *5*..... inches

Sketch grooves, letters, figures, or notches, on proper face or edge.

CARDINAL POSITION

DIAGONAL POSITION

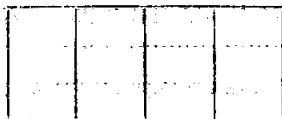

N W S E



NW SW SE NE

Mound of is located

Pits are located

Sketch markings of Bearing Trees (or Rocks) in proper box and fill blanks below, giving bearings from Corner to Trees and Distances in Links.

1/4
S90

1/4
S90

B.T.

B.T.

Species *Tam*..... *Tam*.....

Diameter *10"*..... *14"*.....

Bearing *S22 1/2° W*..... *N.77 1/2° E*.....

Distance *87 1/4 lk*..... *70*.....

Do you believe this to be a genuine Land Office Corner? *Yes*

If not, why?

Dorman J. Sutton

(Signature)

Compassman

(Title)

8-28-34
(Date)

Handwritten notes on a grid of dashed lines.

Corner again.

Give any further facts which will aid in finding this
chains distant.
from which this Corner bears
side of
tree inches diameter, on the
Metal Location Poster is on a

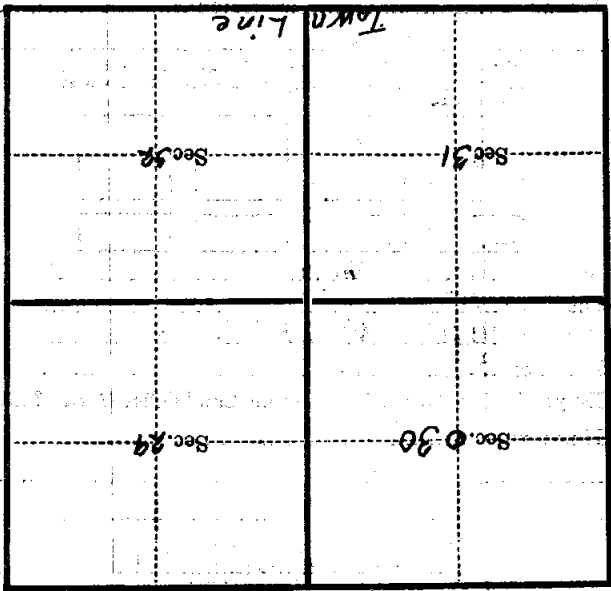

(Make sketch of topography near Corner)

T14HN R.30W 5th T-3 N1E T-3