

X-3

U. S. Department of Agriculture
FOREST SERVICE

Posted

Chippewa NATIONAL FOREST

X3

CORNERS OF THE PUBLIC SURVEY

T 144 N R 30 W 5th Mer.

Quarter Center Corner common to Sections 31, _____, _____, and _____

Corner consists of a *Bur. capped 1" iron* (not) in place
State condition *good*

Dimensions above ground *5* inches

Sketch grooves, letters, figures, or notches, on proper face or edge.

CARDINAL POSITION

DIAGONAL POSITION

N W S E

NW SW SE NE

Mound of _____ is located _____

Pits are located _____

Sketch markings of Bearing Trees (or Rocks) in proper box and fill blanks below, giving bearings from Corner to Trees and Distances in Links.

$\frac{1}{4}$ 331

$\frac{1}{4}$ 331

--

--

B.T.

B.T.

--

--

Species *W. Pine* *W. Birch*

Diameter *14"* *14"*

Bearing *S 47 $\frac{1}{2}$ ° W* *N 59 $\frac{1}{2}$ ° E*

Distance *16 $\frac{1}{4}$ lk.* *23 $\frac{3}{4}$ lk.*

Do you believe this to be a genuine Land Office Corner? *Yes*

If not, why? _____

Daerman J. Sutton

(Signature)

8-28-34
(Date)

Compass 109.0
(Title)

X-3

Corner again.

Give any further facts which will aid in finding this
 ----- chains distant.
 from which this Corner bears -----
 side of -----
 tree ----- inches diameter, on the
 Metal Location Poster is on a -----

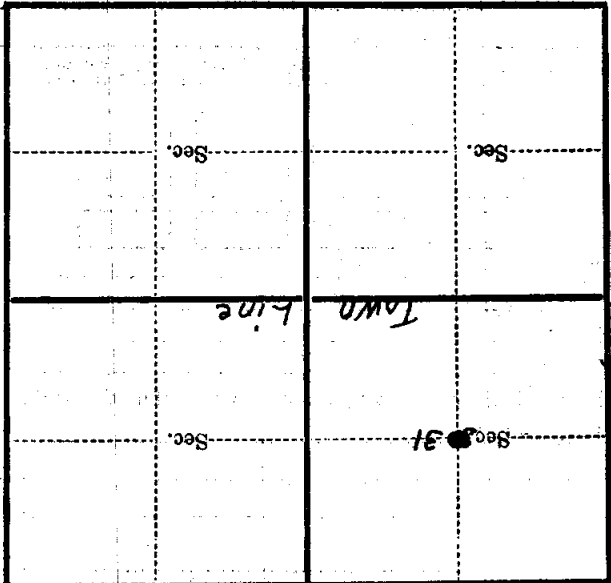

(Make sketch of topography near Corner)

T. 144 N. R. 94 W. S. 7 N. X-3 Mer.